



## DBM750 Concrete Mixer



---

### Operating Instructions & Parts Manual

---

**Read carefully before operating machine!**

# Contents

DBM750 Technical data:.....	2
Operating Instructions.....	3
Introduction.....	3
To all users:.....	3
Features: .....	3
Applications:.....	3
Liability and Warranty .....	4
Setup / Assembly / Operation .....	4
Setting Up the Machine.....	4
Coupling and Uncoupling.....	4
Cleaning .....	5
Using.....	5
Safety .....	6
Transport and Use.....	6
Maintenance .....	7
Warning & Safety Stickers .....	7
Notes .....	8
Parts Section .....	9

We have checked the contents of this manual against the construction and operating characteristics of the mixer. Deviations, however, cannot be excluded so no responsibility can be accepted for errors and omissions. The information in this printed matter is checked on a regular basis and necessary corrections are then included in the following issues. We appreciate any improvement suggestions.

Both the manufacturer and Agriquip reserve the right to change the specifications without prior notice and will not be responsible for upgrading any machines supplied previously.

## DBM750 Technical data:

Mixing capacity	0.75 m <sup>3</sup>
Container diameter:	1500 mm
Height of mixing container:	700 mm
Overall height:	1250 mm
Spring prongs and mixing blades:	4 pcs.
Weight, empty (approx.):	590 kg
Speed at gearbox input, approx.:	250 rpm
Maximum filling height, approx.:	400-450 mm

## Concrete Volume Calculation

Filling height from base of pan:	Corresponds to a volume of:
200mm	0.35m <sup>3</sup>
250mm	0.43m <sup>3</sup>
300mm	0.52m <sup>3</sup>
350mm	0.61m <sup>3</sup>
400mm	0.70m <sup>3</sup>
450mm	0.79m <sup>3</sup>

**Fill the gearbox with oil before putting the machine into service**

**There is no oil in the gearbox because of transportation**

**Use universal joint shaft only with overload clutch**

**Max. torque 1,300 Nm, Length =710mm**

# Operating Instructions

## Introduction

### To all users:

- Read these operating instructions carefully before putting the machine into service!
- Follow the instructions exactly!
- All persons involved with the servicing, repair or maintenance of the machine must become familiar with these safety instructions before working on the machine
- Safe use of this machine can only be guaranteed if you observe all the instructions and information included in this operating instruction manual.
- Keep this operating instructions manual in a readily accessible place when using machine.

**Agriquip will not accept responsibility for any damage or accidents due to non-observance of the instructions and guidelines given in this manual.**

*If you still have any questions after reading this operating manual, please contact your local dealer.*

### Features:

- Sturdy angular gear unit with a transmission ratio of 1:8;
- Tractor driven (using a universal joint shaft with safety device for protection against overload);
- Lifting brackets for transport by fork-lift or pallet prongs on a front-end loader;
- Removable plate sheet metal spray guard.

### Applications:

The DBM 750 is designed for mixing all kinds of concrete and fodder and for seed dressing.

*This mixer meets the standards and regulations of MRL 89/392/EWG including the alteration directive 91/368/EWG and DIN EN 292 Part 1 and 2.*

**The user bears the risk for any form of damage and/or for accidents resulting from any other use unless Agriquip have given their prior written consent**

## Liability and Warranty

All persons involved with the servicing, repair or maintenance of the machine must become familiar with these safety instructions before working on the machine due to the risks involved and must also observe the instructions and guidelines given in the manual.

This also means:

- that work is only allowed to be carried out in accordance with the instructions and settings given in this manual.
- that Department of Labour – OSH and LTSA regulations are to be observed.
- that only original or equivalent replacement parts, accessories and lubricants are used and installed correctly. *A replacement part and/or lubricant is considered to be equivalent if it has been rated as such by the manufacturer or if it is possible to prove that it possesses all characteristics required for the function(s).*
- that, in case of damage, alterations or modifications made to the machine without Agriquip's written consent, will free the manufacturer or Agriquip from any liability and will invalidate the warranty.

**Non-observance of the aforementioned rules and regulations will be considered to be gross negligence and any resulting damage and/or consequences will be at the user's own risk!**

## Setup / Assembly / Operation

Before putting the machine into service:

- Check to ensure that it is in proper working order
- Check the gearbox oil level at the overflow screw and refill as required.

An adjustment of the height of the stirring paddle may be required depending on the type of product to be mixed. This can be adjusted by loosening the bottom screw.

*If the stirring arm is still too high (e.g. due to wear and tear), the height can be further adjusted by removing individual washers from between the gearbox shaft and the stirring cross.*

The mixing tools can be adjusted downwards and laterally which ensures optimal mixing.

### Setting Up the Machine

- Set the concrete mixer up on a solid level base
- Secure to prevent it from tipping over.

### Coupling and Uncoupling

- Couple the machine and the accessories correctly, attaching them only at designed attachment points. Ensure that they are firmly secured and all bolts and nuts are tight.
- The chain supplied with the machine must be adjusted so that the concrete mixer is horizontal during transport.
- The length of the universal joint shaft must be adjusted so that a longitudinal play of approx. 5- 10 cm is maintained for each position of the concrete mixer; otherwise gearbox damage will result.

## Cleaning

- Following use, clean the machine thoroughly with water.

*It is important to make sure that no residue remains on the discharge slide gate and under the mixing cross since this may result in damage and/or corrosion.*

## Using

1. Switch on the concrete mixer so that the stirring blade starts to rotate
2. Then put the material to be mixed into the mixing container.

**All screws and bolts must be tightened firmly before the machine is put into service.**

## **Hazard**

**Risk of crushing exists between the moving and fixed parts**

**Operation with guards open or with the guards removed is strictly prohibited.**

## Safety

- The machine is only to be used, operated and serviced by persons who are familiar with the machine and know about the hazards involved!
- Before starting work with the machine, you must be completely familiar with all systems, operator controls and functions.

*You will not have any time for this when using the machine*

- In addition to the specific instructions given in this operation instruction manual, observe the general regulations with respect to safety and accident prevention as well as the agricultural codes of practice.
- Observe all LTSA regulations when driving on public roads
- Before use, check the machine and the tractor with respect to safety during work and in traffic.
- Damaged, illegible or missing safety decals must be replaced.

## Transport and Use

- Observe the maximum permissible axle load, gross weight and dimensions when transporting.
- Prior to transport on public roads, check and install the safety devices intended for this purpose such as lights, warning signs and any required protective guards and shields
- Prior to transport, put the machine in the proper transport position and secure it in accordance to all regulations
- Ensure that sufficient lateral stability is provided in the transport position
- Check the environs before moving and use.
- Ensure you have a clear field of view.
- Watch out for children and animals.
- No passengers are to be carried during work and transport. The driver's seat must always be occupied when the vehicle is being driven.
- Accessories, equipment and front ballast have an effect on the steering and braking. Ensure that the tractor is suitable for the weight of the mixer.
- Adapt your driving speed to suit the terrain.
- When cornering, take into account the weight, length, width and turning circle of the tractor/machine combination and allow for tail swing.
- Ensure that all the safety devices and guards are complete, intact and ready for operation
- Do not allow others to be present in the working and danger zones
- *Turning circle and swing zones - remember lumps of earth and/or other objects can be thrown up at the back of the machine!*
- Nobody is allowed to be present between the tractor and the machine unless the vehicle has been properly secured by means of the handbrake and/or chocks to prevent it from rolling.
- Whenever you leave the tractor, lower the machine on the ground, switch off the tractor engine and remove the ignition key
- The warning stickers mounted on the machine include important instructions for safe use. Follow these instructions since they serve your own safety!
- While moving, operating and coupling/uncoupling the mixer, do not go between the machine and the tractor.

## Maintenance

The bearing assembly of the mixer is maintenance free except for a grease nipple on output shaft of gearbox, located below the floor of bowl just above the driveshaft input shaft. Regrease the discharge slide gate and universal joint shaft tube and check the mixing blades for wear and tear and replace as required. Change the gear oil initially after approximately. 100 hours of operation; then after every 500 hours of operation (oil: SAE85W/90 approx. 4 litres)

- Carry out repairs, maintenance and cleaning tasks including trouble-shooting tasks only when the tractor engine has been switched off and the ignition key removed.
- Perform regular checks to ensure that all screws and nuts have been tightened down firmly. Retighten as required!
- Machine parts must, under all circumstances, comply with the technical requirements specified by the manufacturer!
- Before reusing the machine, always check to ensure replaced and/or detached parts have been correctly installed!
- Any damaged parts must be replaced before using the machine.

## Warning & Safety Stickers

### Display of warning and information Decals

The warning decals must be clearly visible and readable. If damaged or missing – replace

Read the operating instructions before putting the machine into service.

Avoid the working zone.  
Risk of injury.

Information sign "CE"

**The warning stickers mounted on the machine include important instructions for safe use. Follow these instructions since they serve your own safety!**



# Notes

A series of horizontal dashed lines for writing notes.

**Parts Section**

**Concrete Mixer Type DBM750**



**AgriQuip** DBM 750  
PAN CONCRETE MIXER

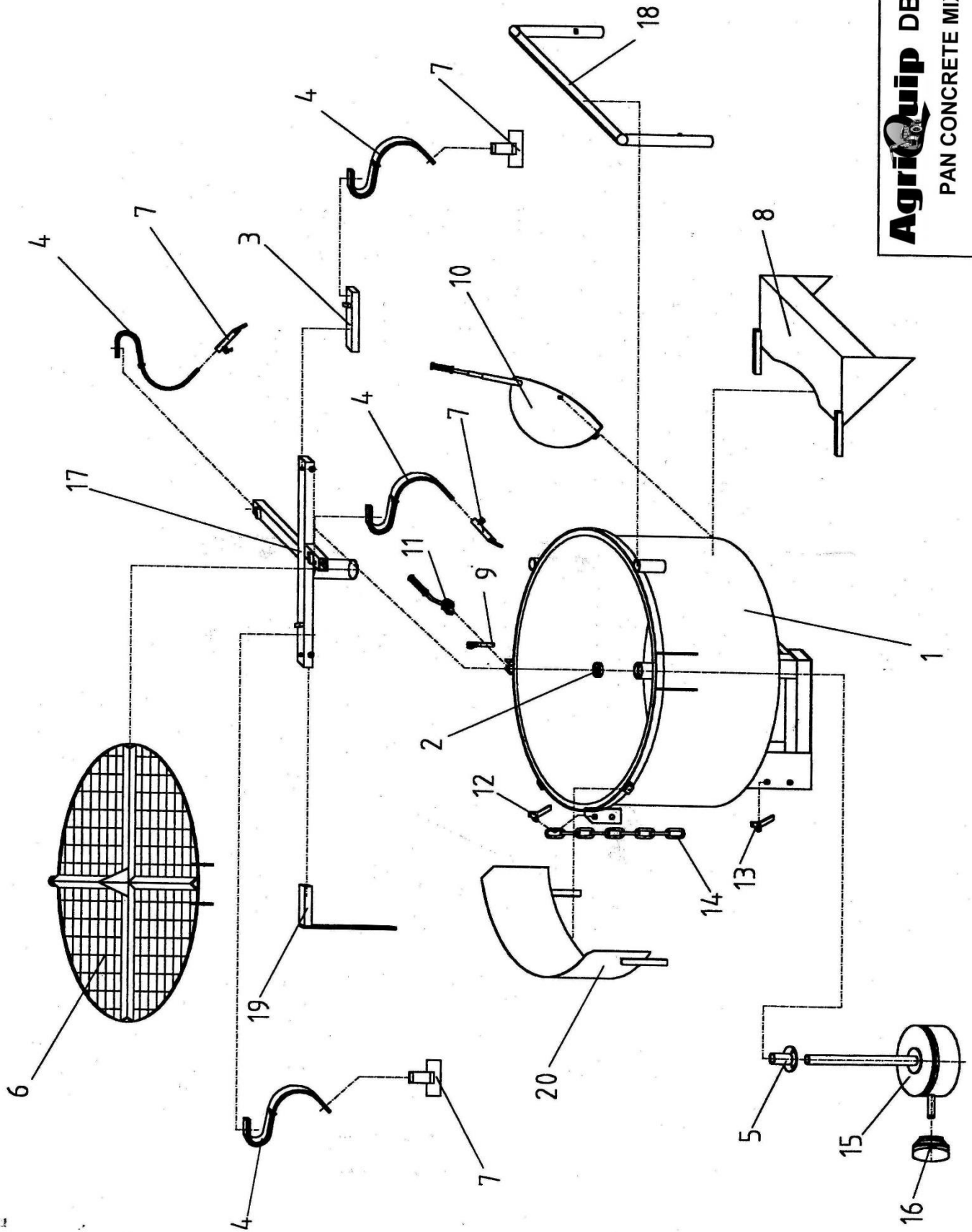

Item No	Description	Number	Part Number	Other
1	Container/Bowl	1	75/25400	
2	Keeper	1	75/25004	6010 - 2RS DIN 630
3	Adjustable arm	1	75/25405	
4	Load spring arm	4	75/25510	
5	Guide bush	1	75/25410	
6	Grate	1	75/25415	
7	Agitating foot	4	75/25511	
8	Discharge Chute	1	75/25005	
9	Catch	1	75/25420	
10	Discharge opening slidegate valve	1	75/25425	
11	Locking lever	1	75/25430	
12	Top link pin	1	75/25435	
13	Draft link pin	2	75/25440	
14	Chain	1	75/25504	
15	Gearbox	1	75/25502	
16	PTO guard	1	75/25503	
17	Rotor	1	75/25006	
18	Protection guard rail	1	75/25445	
19	Bowl side panel stripper	1	75/25512	
20	Shield	1	75/25450	

Options available:

- Drive shaft
- Hydraulic drive consisting of:
  - Metal Attachment Plate
  - Hydraulic Motor
  - Overload Crossline Relief Valve Adapters
  - Hoses with ½" QRC Male Tips



Imported & Distributed by:

**AgriQuip Limited**

30 Hurlstone Drive, New Plymouth

New Zealand 4312

Phone: +64 6 759 8402

Email: [parts@agriquip.co.nz](mailto:parts@agriquip.co.nz)

Web: [www.agriquip.co.nz](http://www.agriquip.co.nz)