

ACTUATOR FEATURES

- Visual Position Indicator (removable for mounting NAMUR Accessory)
- Actuator Body : Hard Anodized Aluminum Alloy
- End Caps : Powder Coated Die Cast Aluminum
- Two Independent External Travel Stop Adjustment Bolts (+ or - 5deg)
- 1/4" NPT Air Supply Connections with NAMUR drilling to suit NAMUR Solenoid Accessory

VALVE FEATURES

- Full Port, 1/2" - 3" (DN100)
- W.P. : 1000 WOG (PN63)
- W.T. : -4°F to 392°F (-20°C to 200°C)
- Investment Casting
- Blow-Out Proof Stem
- Live-Loaded Design
- ISO 5211 Direct Mounting Pad
- Length Conforms to DIN 3202-4
- Thread Type : ASME B1.20.1 (NPT)

OPTIONS

LIMIT SWITCH

- Mechanical Switch 120VAC (NEMA 4, 4X)
- Inductive Proximity 24VDC (IP 67)

CONTACT US FOR ADDITIONAL LIMIT SWITCH OPTIONS

SOLENOID

- NAMUR Solenoid 120VAC/24VDC (NEMA 4, 4X)
- NAMUR Solenoid 120VAC/24VDC (NEMA 7)

CONTACT US FOR ADDITIONAL SOLENOID OPTIONS

PARTS & DIMENSIONS

ACTUATOR

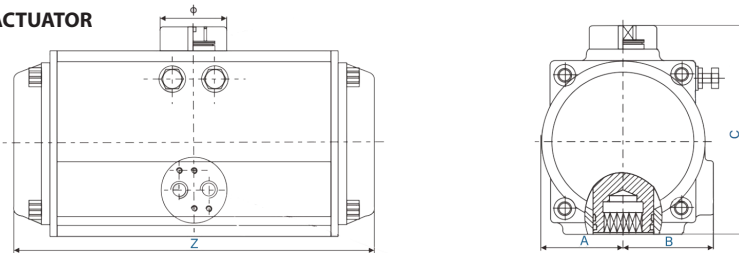

VALVE

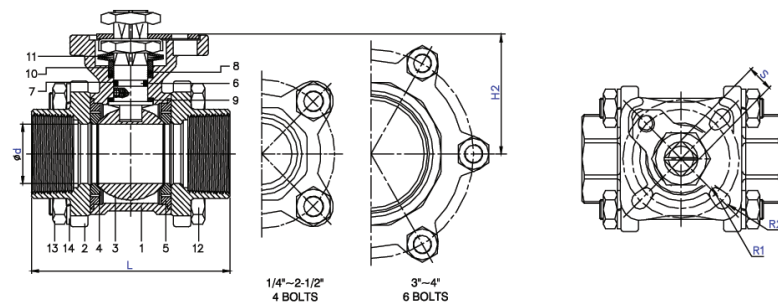

ITEM	PARTS	MATERIAL
1	BODY	ASTM A351-CF8M
2	CAP	ASTM A351-CF8M
3	BALL	ASTM A351-CF8M
4	SEAT	PTFE / RTFE
5	SEAL	PTFE
6	STEM	ASTM A276-316
7	O-RING	VITON
8	PACKING	PTFE
9	THRUST WASHER	
10	GLAND RING	AISI 304
11	BELLEVILLE WASHER	AISI 301
12	BOLT	AISI 304
13	NUT	
14	SPRING WASHER	

NPT	ACTUATOR DIMENSIONS				ISO 5211	VALVE DIMENSIONS						Valve Torque	Actuator Spring Torque Start / End	Assembly Weight	Part #
	Z	A	B	C		d	L	H2	S	R1	R2				
1/2"	5.79"	1.18"	1.63"	3.62"	F03/F04	0.59"	2.56"	1.43"	0.35"	0.11"	0.11"	62 in-lb	120/83 in-lb	4.6 lb	CBV052013ND/52SR11
3/4"	5.79"	1.18"	1.63"	3.62"	F03/F04	0.79"	2.95"	1.56"	0.35"	0.11"	0.11"	79 in-lb	120/83 in-lb	5.0 lb	CBV072013ND/52SR11
1"	6.69"	1.48"	1.81"	4.29"	F04/F05	0.98"	3.35"	1.93"	0.43"	0.11"	0.14"	132 in-lb	202/133 in-lb	7.3 lb	CBV102013ND/65SR11
1-1/4"	7.24"	1.65"	2.09"	4.72"	F04/F05	1.26"	3.98"	2.13"	0.43"	0.11"	0.14"	159 in-lb	282/206 in-lb	10.6 lb	CBV132013ND/75SR11
1-1/2"	8.11"	1.81"	2.24"	5.06"	F05/F07	1.5"	4.41"	2.54"	0.55"	0.14"	0.18"	221 in-lb	447/308 in-lb	14.3 lb	CBV152013ND/85SR11
2"	8.11"	1.81"	2.24"	5.06"	F05/F07	1.97"	5.12"	2.85"	0.55"	0.14"	0.18"	309 in-lb	447/308 in-lb	16.9 lb	CBV202013ND/85SR11
2-1/2"	11.10"	2.26"	2.52"	6.06"	F07/F10	2.48"	6.38"	3.62"	0.67"	0.18"	0.22"	486 in-lb	958/616 in-lb	32.3 lb	CBV252013ND/105SR11
3"	11.97"	2.80"	2.93"	7.09"	F07/F10	2.99"	7.4"	3.94"	0.67"	0.18"	0.22"	619 in-lb	1531/1018 in-lb	47.0 lb	CBV302013ND/125SR11

Pre-Configured Valve Assemblies are based on minimum 80 psi Instrument Air Pressure