

# TIMES-2 ROTARY CABINETS



A better spin on storage



**AURORA**

A SOLUTION FOR EVERY STORY  
[WWW.AURORASTORAGE.COM](http://WWW.AURORASTORAGE.COM)

# TIMES-2™

## The Unique Alternative to Lateral Cabinets

Times-2 is a space saving dual-sided alternative to lateral cabinets. It features true flexible storage not seen in lateral cabinets and has compartmentalized, locking storage.

You can store everything imaginable from personal items to books, binders, tablets, notebooks, files and more.

Times-2 comes in 10 heights and 2 widths with loads of accessories and configurations to make a complete and versatile storage system.



### Space Planning with Times-2

Times-2 is so space efficient you can store the equivalent of 3 lateral files in just a single unit. This means you can make better use of your space to store more items or have more room to create workstations and collaborative work centers.



Sizes	Tiers	Heights
Letter Legal/A4	8	92 $\frac{1}{2}$ "
	7	82"
	6	71 $\frac{3}{8}$ "
	5	60 $\frac{7}{8}$ "
	4	50 $\frac{3}{8}$ "
	3	41 $\frac{5}{8}$ "
	2	29 $\frac{1}{2}$ "
Plus-Sizes* Letter Legal/A4	7	89"
	6	76 $\frac{5}{8}$ "
	5	66 $\frac{1}{8}$ "

\*Plus-Size units increase slightly in height for applications outside the range of a regular unit.

### Use Times-2 Here:

- Corporate Offices
- Schools & Colleges
- Law Firms
- Healthcare
- Pharmacies
- Libraries
- Museums
- Law Enforcement
- Military
- Retail

### Use Times-2 for:

- Departmental Storage
- Hoteling Stations
- Reception Areas
- Personal Storage
- Private Offices
- Collaborative Work Centers

# Times-2 Technology - A Better Spin on Storage



## Simply put, Times-2 is the Best Rotary Storage System on the Market

Times-2, the original rotary cabinet, is still the best on the market today. Although there are many imitators, none perform as smoothly and effortlessly as the original Times-2 patented design.

### Here's Why:

- Better Safety Features
- Superior Fit and Finish
- Easier Assembly
- More Security Options
- Greater Number of Sizes
- Tons of Accessories to Store Everything
- Colors, Colors, Colors
- Eco-Friendly



### Times-2 Base Safety Feature

Unlike competitive rotary units, the Times-2 Base has Positive Position Control (PPC). This safety feature provides a controlled and safe stop every quarter turn.

### It's All About the Base

#### Smooth Operation

The base assembly is the foundation of Times-2. Unlike some competitive units, the Times-2 base is assembled and lubricated for life in our factory to ensure smooth operation and clean installation.

#### Columnar Support

Columnar Support is a unique base reinforcement to distribute weight safely and evenly. Times-2 cabinets can be loaded heavily on one side and lightly loaded on the other and this feature will balance the weight for quiet and smooth operation.

#### Built-in Safety with Positive Position Control

Times-2 can be ordered with a foot pedal or a hand release, and both provide Positive Position Control, an important safety feature.

Positive Position Control ensures a controlled and positive stop every quarter turn, preventing the rotational momentum that can occur with off-brand units especially those that are free spinning push models.

No competitor offers this safety feature which is built into every Times-2 unit. Only Times-2 cabinets have full and automatic stops that are always ready to protect users.



# TIMES-2 ELITE™

## It's All About the Look....

Times-2 Elite is comfortable in your space, confident in the corner office, and work-friendly in collaborative spaces. It makes a bold design statement with elegant faceted lines.

Times-2 Elite has the same multimedia storage essentials as Times-2, but features special design elements for a luxurious aesthetic. Add canopy tops in beautiful Wood-Tek or rich granite for a look that blends with high end décor. Wrap end panels and doors in Wood-Tek or fabric overlays to match fine office furniture.





# INTERCONNECT TIMES-2

## True Design Freedom

Times-2 Interconnect is designed for the office or business that needs compact multimedia storage and work space all in one. With Times-2 Interconnect you can use every bit of space that's ordinarily wasted. Create a run of units — tall to short, short to tall. It's your call. Make room for a collaborative work area or organize the conference room. Add a countertop on lower units for monitors, printers, or copiers.

### Where to Use Times-2 Interconnect:

- Under low windows
- Below thermostats or wall-mounted controls
- In conference rooms with drop screens or smart boards
- Within executive suites for credenza storage
- As collaborative printing and copying stations
- Between workstations for shared storage
- Along partition walls in hall station environments
- Mail rooms
- Common work areas



**Patented Design: #7,530,652**

The patented Times-2 Interconnect is so space efficient that it saves 6" of floor space for every change of height in a run of units. No competitor can do that!



# TIMES-2

## Space Planning

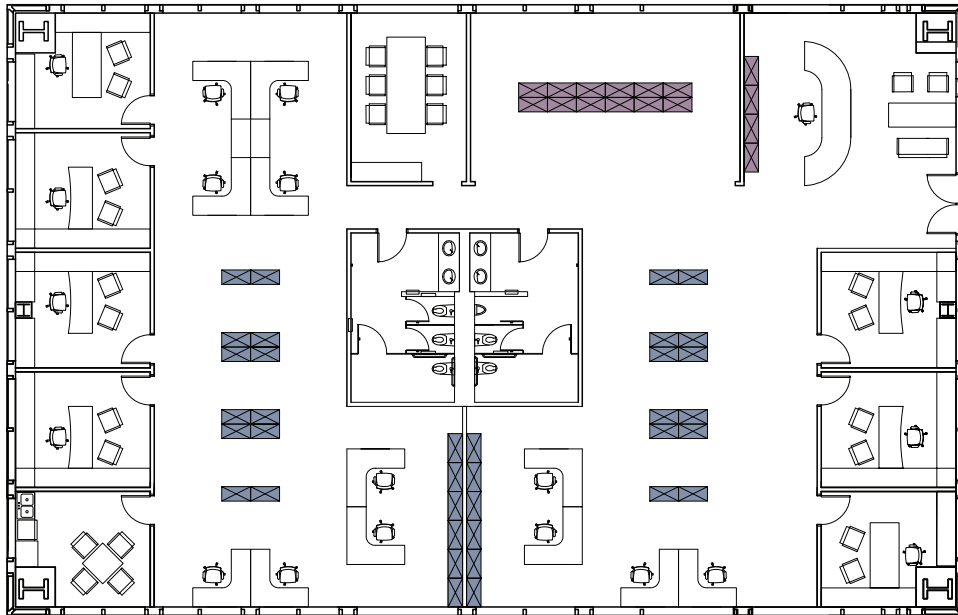

**Lateral Files - Before**

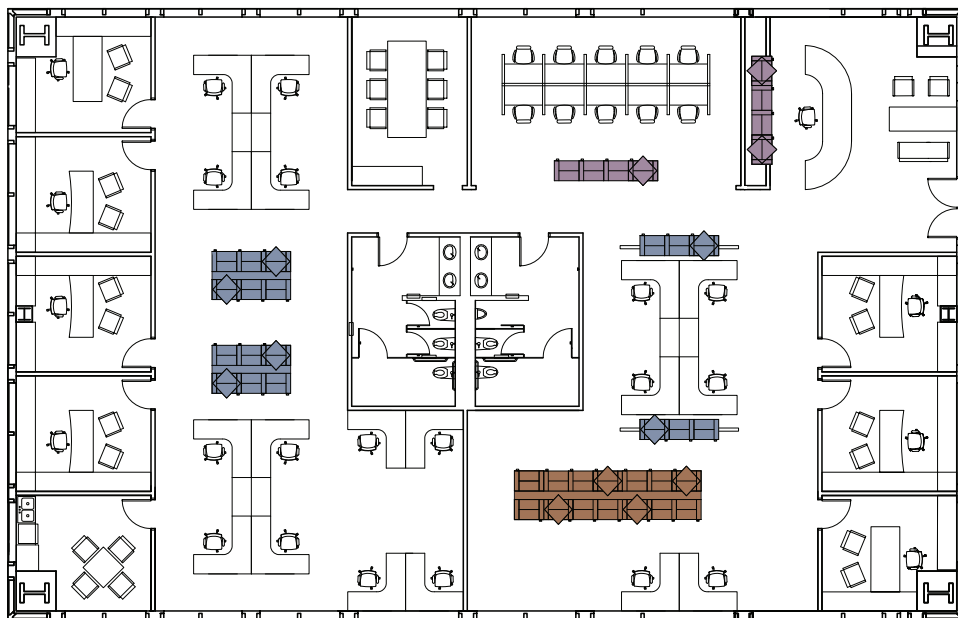

**Times-2 - After**

Space  
Savings

Workstations Added with Times-2	6
Hoteling Stations Added with Times-2	10
Collaborative Work Space Added	86 Sq. Ft.



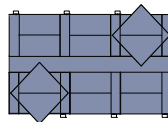

Back-to-Back

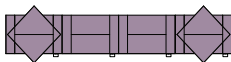

Reception Area

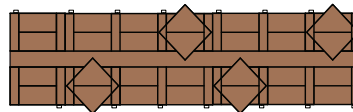

Collaborative Work Space



Alcove

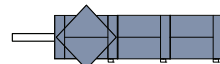

Panel System



# TIMES-2 ROTARY CABINETS

## Accessories & Options

The versatility of Times-2 is amazing, with accessories for every type of storage. We have shelves, drawers, dividers, retractable work surfaces, overlays and more. Our basic rollout drawer configures in eight different ways with eleven options — no other rotary cabinet on the market can do that!

### We're Up for Change

Times-2 can be reconfigured at any time to adjust to your storage needs. Are you moving away from storing files to electronic document imaging? No problem. With Times-2 you can change it up quickly and easily to repurpose that same cabinet space for something else.



**Reference Shelf**



**Accessory Drawer**



**Converter Bars**



**Security Drawer**



**Tub Drawer**



**Hanging Folder Frame**



**Filing Drawer**



# TIMES-2 ROTARY CABINETS

## Accessories & Options



Reversible Shelf



Dividers in 8 Heights



Magnetic Follower



Keypad Access



Rifle Brackets



Handgun Brackets



Countertops



Foot Pedal Operation



Hand Release Operation

# SPECIALTY ACCESSORIES & PRECONFIGURED UNITS

## Tailored Solutions



Quik-Panel™



Pharmaceutical Applications



Music Storage



Wardrobe Kit



Museum Collections



Weapons Brackets



Caster Kits



Pass Through

## Preconfigured Solutions

171S



171A



171SRN

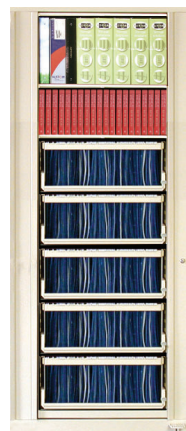

171ARN

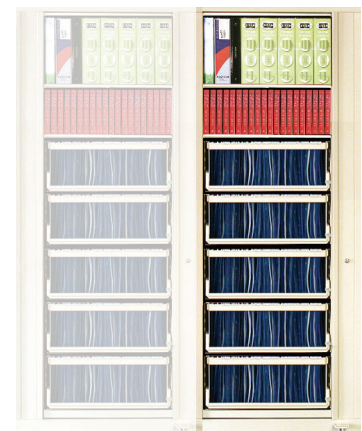



# COLORS & OPTIONS

## Colors

Times-2 comes in 31 standard colors, offering the widest range of colors of any rotary cabinet on the market. All units feature textured Gloss-Tek® powder coat, a fingerprint resistant finish that is also eco-friendly and 100% non-emissive.

For healthcare, education, and clean room applications, order Gloss-Tek in an antimicrobial finish. All antimicrobial colors match our standard colors.

## Still not Enough Colors?

We can also match special non-standard colors to blend with your décor.\*

\*Special color matching, antimicrobial or metallic finishes available for an extra charge.

## Xpress Program

### Need Times-2 in a Hurry?

Choose from a selection of our most popular preconfigured Times-2 units in 8 colors on our Xpress program for shipment within 2 days or 5 days.



## Wood-Tek

Beautiful Wood-Tek™ door and end panels are available in 4 stains and 2 species of real wood, or choose popular laminates for a design accent.

## Fabric Overlays

Want to match panel systems or chairs in your office? Times-2 options include removable magnetic fabric overlays for doors and end panels.

## Marker Board Overlays

Marker board overlays create a convenient way to take meeting notes or post calendar reminders for you and your staff. Choose from White, Greystone, or Sandstone colors.



Wood-Tek  
End Panels



Marker Board  
Overlays

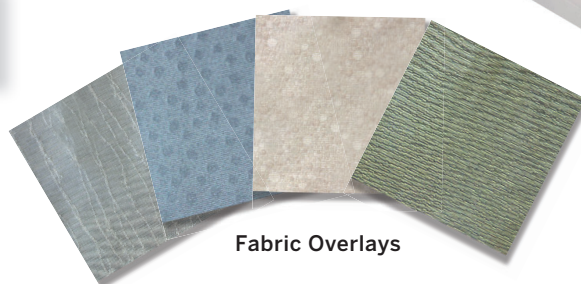

Fabric Overlays

# TIMES-2

## Applications



Workstation Areas



Government



Law Enforcement



Military



# TIMES-2

## Applications



Legal Offices



Retail



Departmental Storage



Corporate Mail Center

# TIMES-2

## Applications



Medical/Pharmaceutical



Architectural Firms



Industrial Storage



Design Firms



# TIMES-2

## Applications



Automotive Repair



Workstations



Auto Dealerships



Executive Offices

# TIMES-2

## Dimensions

### AVAILABLE IN 10 HEIGHTS

8-TIER	92½"	4-TIER	50⅜"
7-TIER	82"	3-TIER	41⅝"
6-TIER	71⅜"	2-TIER	29½"
5-TIER	60⅝"		

### PLUS SIZES

7-TIER	89"
6-TIER	76⅝"
5-TIER	66⅝"

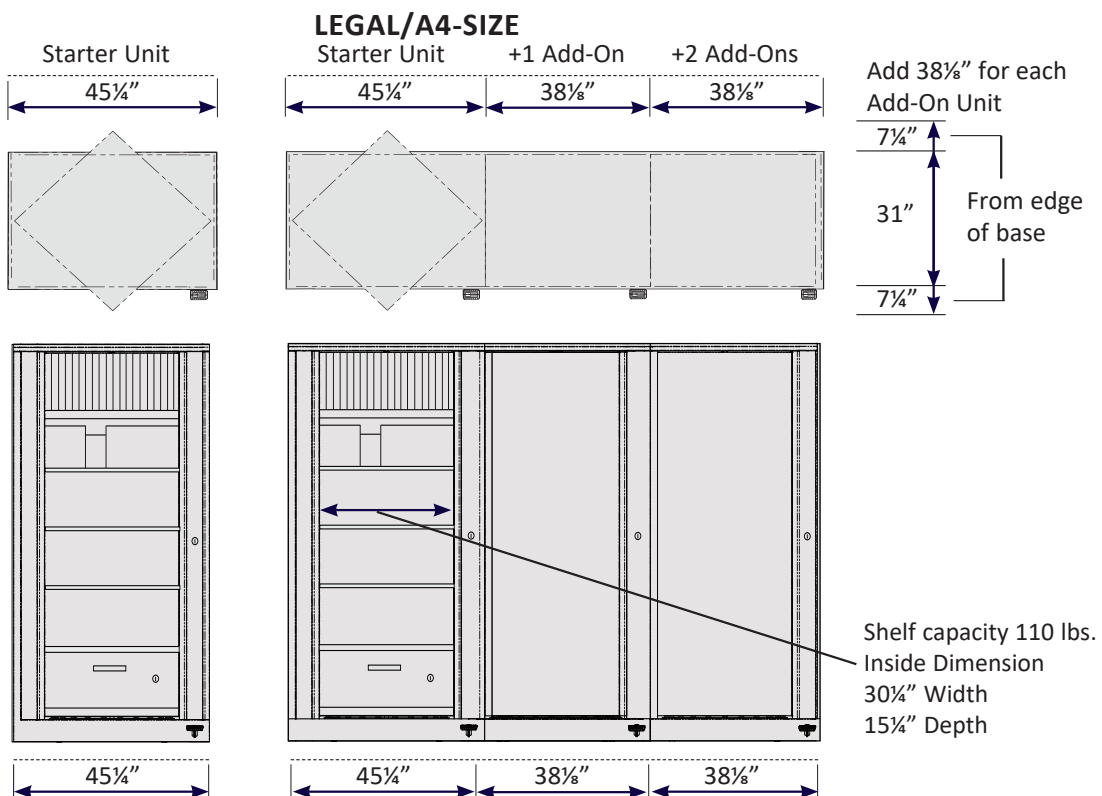
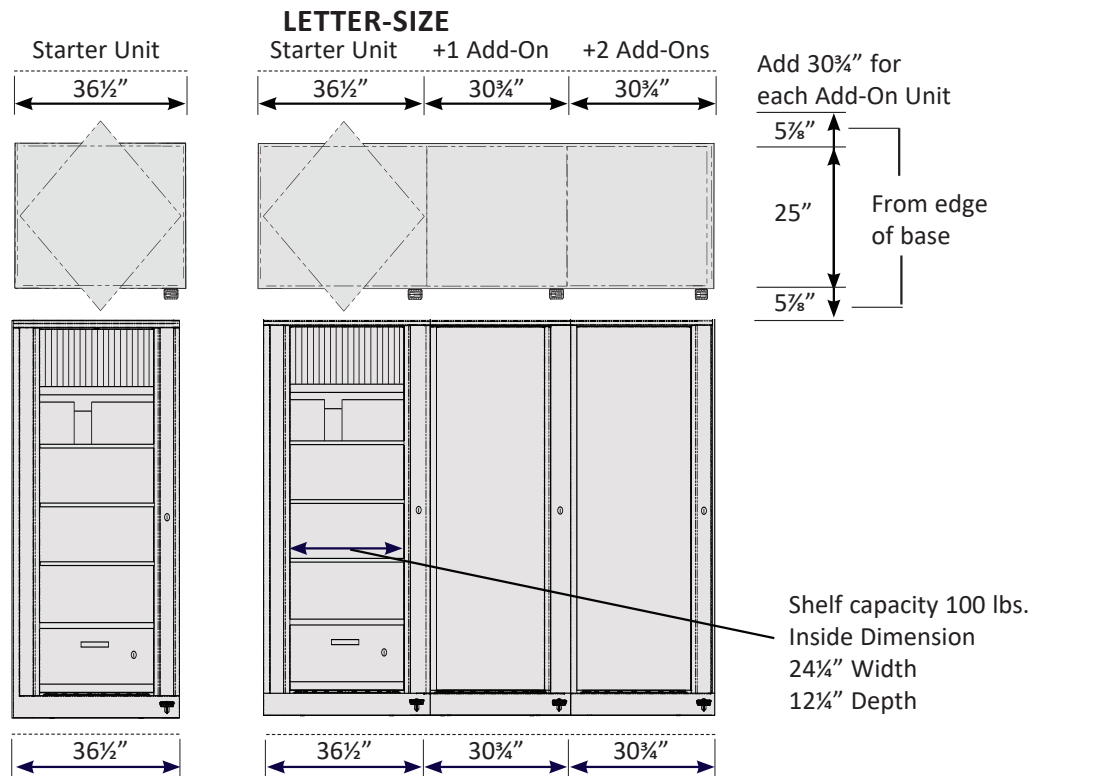



# TIMES-2 ELITE

## Dimensions

AVAILABLE IN 10 HEIGHTS				PLUS SIZES	
8-TIER	92½"	4-TIER	50⅝"	7-TIER	89"
7-TIER	82"	3-TIER	41⅝"	6-TIER	76⅝"
6-TIER	71⅝"	2-TIER	29½"	5-TIER	66⅝"
5-TIER	60⅝"				

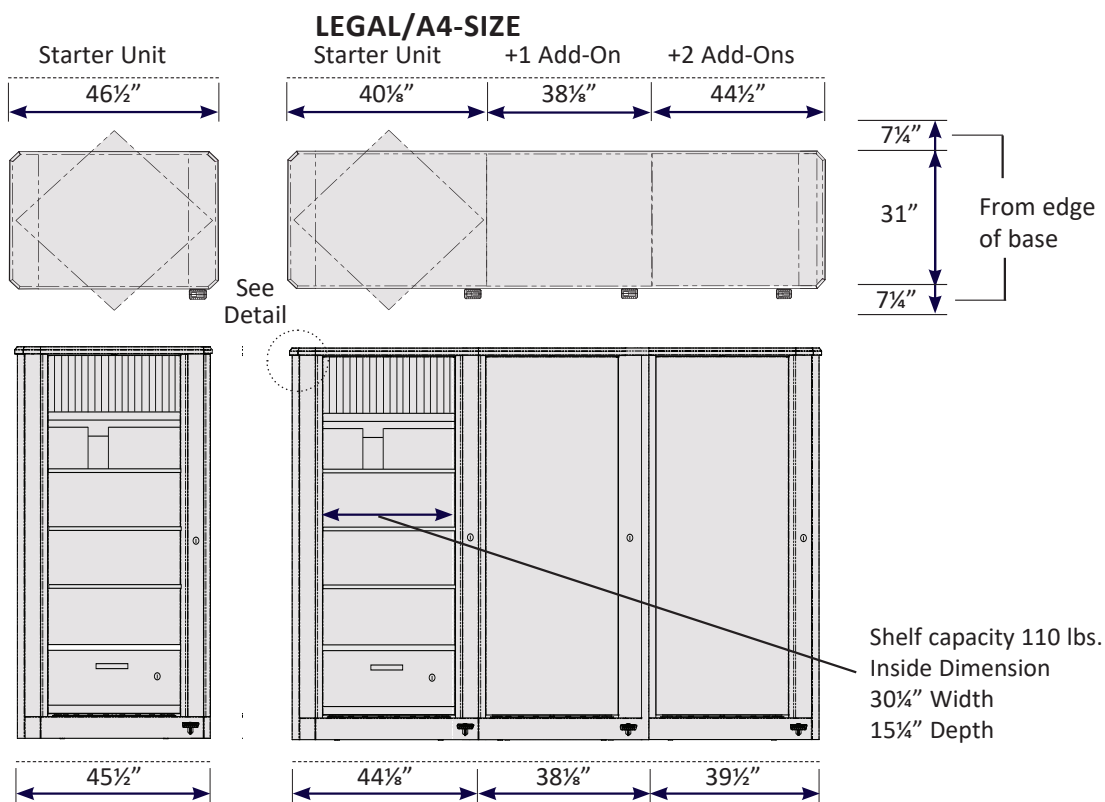
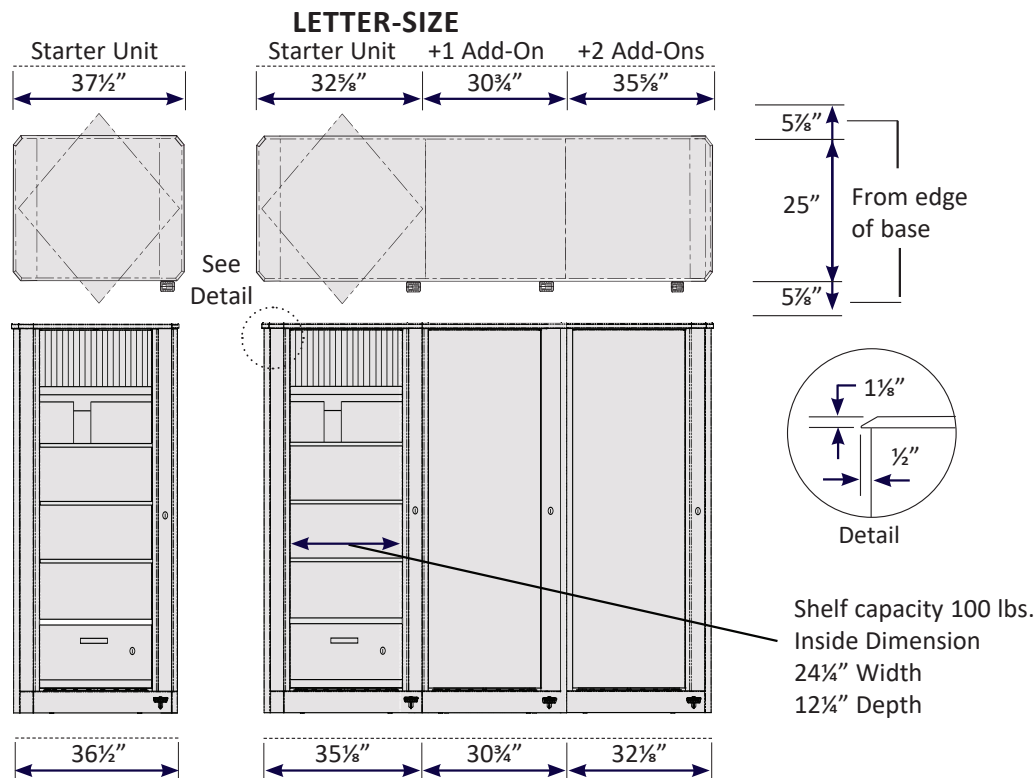



**Times-2, A Better Spin on Storage**



Aurora Storage Products, Inc.  
 600 South Lake Street • Aurora, IL 60506  
 Ph: 630-897-6951 • Fax: 630-897-6994  
 Toll Free: 800-277-1699

**[www.aurorastorage.com](http://www.aurorastorage.com)**

All Rights Reserved Copyright © 2017  
 Times-2 102019



**Contract Holder**

Contract GS-25F-0084M

U.S. Small Business Enterprise



For more information go to:  
<http://www.aurorastorage.com/>

For design assistance:  
[designsupport@aurorastorage.com](mailto:designsupport@aurorastorage.com)