

NOVUM

Redefining refrigeration

ALASKAN - WALKAROUND DISPLAY MERCHANDISER Technical Specifications



"Best in Class"
ENERGY
CONSUMPTION
(Awarded by the Swiss Federal Government)

ICE FREE

www.novum.ie

The ALASKAN - WALKAROUND DISPLAY MERCHANDISER

is our latest innovation. It was developed from the ground up to incorporate Novums LEAP technology. The benefits of which are clear - No frost build up internally, unique cassette refrigeration system & the lowest running costs of any cabinet of its size on the market.

The Grand Cayman combines superior internal volume, with excellent product visibility & product facings. Access from both sides with 4 x glass lids. 1 x ultra-bright centre mount LED lighting combined with a clean white interior provides spectacular illumination of the product. This combined with Novum's LEAP Technology, makes a truly class leading cabinet.



**Removable
Cassette**



**DOE
Approved**



***37%
Lower
Energy Bills**



**100%
Frost Free**

*when compared to next best in class competitor



The unique curved glass on the end case offers an unequalled access into the cabinet. In practice, this means that the whole of the cabinet can easily be shopped from either side. The Novum Alaskan range is guaranteed to enhance the image of your store, save you money and improve your customer shopping experience.

It is a versatile cabinet that can be used as a stand-alone unit, as part of a line-up, back to back or as part of a full island and is available with sliding lids.

Technical Specification

| Grand Cayman Range | Model | Alaskan |
|--|-------------|--------------|
| Technical Data | | |
| Gross content | cu. ft | 37.7 |
| Net Content according to EN 23953 | cu. ft | 29.3 |
| Total Display Area (TDA) | sq. ft. | 15 |
| Classification according to EN 23953 | | 3L1 |
| Ambient Temperature Range | °F | +61 to +77 |
| Inner Temperature Range | °F | -0.4 to -13 |
| Sound Pressure at 1m Distance | dB(A) | 43.3 |
| Electrical Data | | |
| Nominal Voltage / Frequency | V / Hz | 110-120 / 60 |
| Nominal Power Cabinet | w | 310 |
| Nominal Power LED Light | w | 19 |
| Nominal Current | A | 2.3 |
| Fuse Protection | A | 10 |
| Energy Consumption (at 77°F) to DOE 8.1 | Kwh/24hr | 4.2 |
| Length of Power Supply Cord | inches | 78.7 |
| Refrigeration Data | | |
| Refrigerant | Type | R290 |
| Gas Charge | oz | 2.3 |
| Maximum Operating Pressure | PSI | 435 |
| Max Transient Heat Output | W/h (Btu/h) | 780 (2661) |
| Net Average Heat Rejection | W/h (Btu/h) | 200 (682) |
| Dimensions | | |
| Length Outside/ Inside | inches | 83 / 75.8 |
| Depth Outside/ Inside | inches | 38.5 / 31.6 |
| Front & Back Access Height Outside / Inside | inches | 34.8 / 31 |
| Stacking Height at the Front / Back | inches | 22.8 |
| Weight | | |
| Net Weight (excl. packaging, incl. internal accessories) | lbs | 308 |
| Gross Weight (incl. packaging & internal accessories) | lbs | 331 |

Dimensions Alaskan

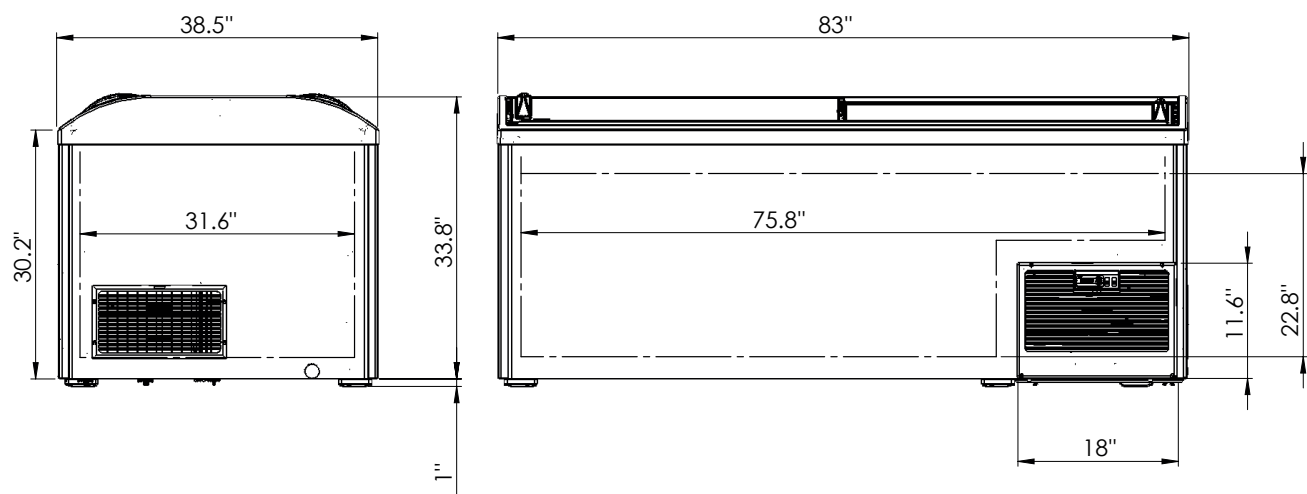

Professional HVAC/R Services, Inc.®

32961 Pin Oak Parkway
Avon Lake, Ohio 44012

Phone: 440-933-0033
www.prohvacr.com

NOVUM
Redefining refrigeration

