

# purecoldICON6

Case Length	61.5" (2dr)	92.5" (3dr)	123" (4dr)
<b>Physical Data</b>			
TDA (Total Display Area) ft <sup>2</sup>	21.74	32.61	43.48
Refrigerated Volume (V <sub>r</sub> ) ft <sup>3</sup>	45.8	68.9	91.6
Shelf Depth <i>maximum</i> (in)	22"	22"	22"
<b>Electrical Data (115v 60Hz)</b>			
Case Load	3.5	4.5	5.5
<b>Electrical Data (208v 60Hz)</b>			
Condensing Unit / Defrost	7.5	10.7	12.8
MOCP (per phase) Amps	15	20	20
<b>Miscellaneous Data</b>			
Electrical Connections	Bottom Right Hand Side		
Number Refrigeration Systems	1	1	1
Refrigerant Charge (R448A) per system (lbs)	3.3	4.0	5.0
Drainage	Self-Evaporative		

## ICON6 (1OS7MS1) Self-Contained, Full Glass Door - Medium Temperature

Energy Data	<b><i>MEAT/DAIRY 75oF / 55%r.h.</i></b>		
Total Heat Rejection THR (BTU/hr) <i>instantaneous</i>	7595	10851	7,024
Total Heat Rejection THR (BTU/hr) <i>average 24hr</i>	2,630	3,512	5,626
Nett Environmental Heating Effect (BTU/hr)	989	1,484	1,978

## ICON6 (1OS7LS1) Self-Contained, Full Glass Door - Low Temperature

Energy Data	<b><i>FROZEN FOOD 75oF / 55%r.h.</i></b>		
Total Heat Rejection THR (BTU/hr) <i>instantaneous</i>	5459	8120	10085
Total Heat Rejection THR (BTU/hr) <i>average 24hr</i>	5152	7711	10270
Nett Environmental Heating Effect (BTU/hr)	989	1,484	1,978

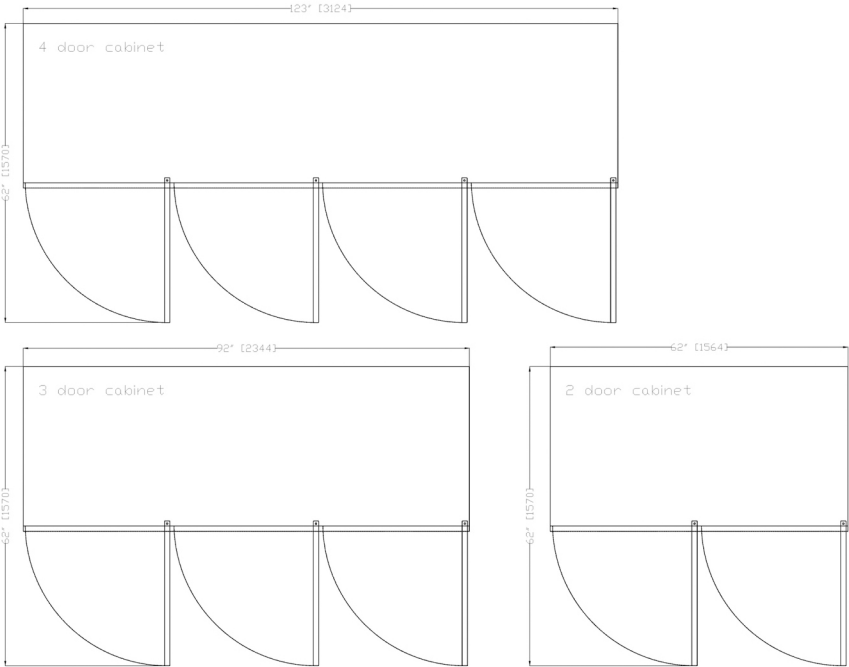

Profile Drawing

