

# Attenuator, SMA

Model 9102-CRYO

## Features

- Stable Attenuation over temperature
- Low thermal noise characteristics
- Minimal self heating, achieves temperature faster.
- Optimized non-magnetic material selection.

## Technical Specifications

Parameter	Value
Frequency Range	DC to 18 GHz
Standard dB Values	0, 3, 6, 10 & 20dB
Attenuation Accuracy (dB)	
0dB	+0/-0.4dB
3 & 6dB	±0.3dB
10 & 20dB	±0.5dB
VSWR	
DC – 4 GHz	1.15:1 Max.
4 – 12.4 GHz	1.25:1 Max.
12.4 – 18 GHz	1.35:1 Max.
(1-20dB)	
12.4 – 18 GHz	1.45:1 Max.
(0dB only)	
Input Power	2 Watts Avg. @ 25°C
Impedance	50 Ohms
Operating Temp. Range	4°mK to +125°C

Frequency Range: DC to 18.0 GHz  
Power: 2Watts



## Mechanical

Feature	Material
SMA Connectors <i>Mates with MIL-STD-348</i>	White Bronze Plated Brass
Conductors	Gold Plated Beryllium Copper
Substrate	Beryllium Oxide
Resistor Material	Proprietary Thin Film

## Physical Dimensions

Model Number: 9102-03-CRYO shown

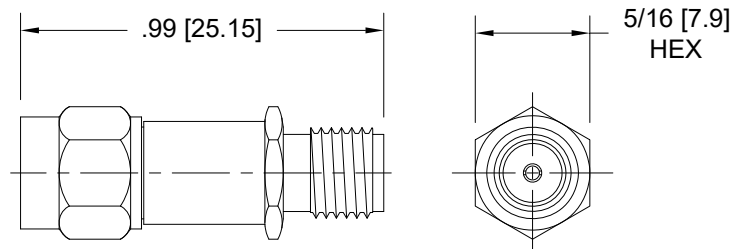

## How to Order

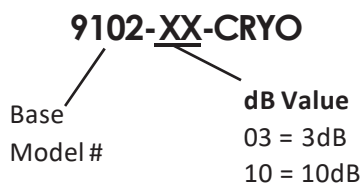

Note: Dimensions in Brackets [ ] are expressed in millimeters and are for reference only.

## Order Examples

Model Number: 9102-03-CRYO

DC-18 GHz, 3dB, SMA Male/Fem

rev A

Design Specifications are subject to change without notice.