



THE ULTIMATE BUYING GUIDE:

Audio Solutions for Schools & Universities



TABLE OF CONTENTS

WELCOME

SECTION 1: CLASSROOM AMPLIFICATION

- BUYING GUIDE: Classroom Audio Systems
- CASE STUDY: An Affordable & Compact System for Classroom Amplification
- BLOG: Benefits of Classroom Amplification
- BLOG: The New Sound of Classroom Instruction is a Portable PA System
- BLOG: Portable vs. Installed Public Address Systems: Economical, Flexible, Reliable, and Easy to Use
- Customer Experiences & Reviews
- Anchor Audio Product Comparison: AN-Series
- Product Technical Specifications & Videos

SECTION 2: OUTDOOR & INDOOR EVENTS

- BUYING GUIDE: Portable PA Systems for Indoor & Outdoor Events
- CASE STUDY: Liberate Your School from the Constraints of a Tight Budget
- CASE STUDY: One Sound System. A Variety of Applications.
- BLOG: How to Be Prepared for Emergency Situations at Schools & Universities
- BLOG: Outdoor Sound System - Features and Benefits
- BLOG: Indoor & Outdoor Audio Equipment for School Events
- Customer Experiences & Reviews
- Anchor Audio Product Comparison: Portable Sound & PA Systems
- Product Technical Specifications & Videos

SECTION 3: ATHLETICS

- BUYING GUIDE: Portable PA Systems for Athletics
- CASE STUDY: Start the Race Right using the Right PA System
- BLOG: There's No Competition for the Best Portable PA System - Anchor's the Winner
- Customer Experiences & Reviews
- Anchor Audio Product Comparison: Portable Sound & PA Systems
- Product Technical Specifications & Videos

SECTION 4: MARCHING BAND & PAGEANTRY

- BUYING GUIDE: Portable PA Systems for Marching Band & Pageantry
- CASE STUDY: Improve Efficiency & Performance at Practice
- BLOG: Metronomes, Marching Bands, and MegaVoxs...Oh My!
- Customer Experiences & Reviews
- Anchor Audio Product Comparison: Portable Sound & PA Systems
- Product Technical Specifications & Videos

CONCLUSION



WELCOME

Thank you for downloading Anchor Audio's Education Toolkit. We are dedicated to your success, so we've made your education audio solutions and tools even easier to access. All the information you need to know about successfully tackling and implementing audio solutions in a variety of applications across your school or university is now in one toolkit. Education facilities use audio systems for a variety of applications and crowd sizes, so we've broken down the supporting material by applications for easier and quicker access. From classroom amplification, outdoor and indoor events, athletics, and marching band, each application has a goal or a need that must be met - Anchor Audio is here to help.

CLASSROOM AMPLIFICATION:

Goal:

Enable every student in a classroom to clearly hear all the speech components of the teacher's or instructor's voice no matter where a student is seated relative to the teacher's position in the room.

How is Anchor Audio a Solution:

Anchor Audio provides easy to use, effective classroom audio solutions that are perfect for any teacher, presenter, or AV cart. Anchor Audio speaker monitors are portable and bracket mountable.

OUTDOOR & INDOOR EVENTS:

Goal:

Enable all instructors, students, and attendees to hear clear, intelligible speech and music at a large event.
Provide an effective audio solution that can be utilized in various applications – both indoors and outdoors – and is budget conscious.

How is Anchor Audio a Solution:

Anchor Audio provides portable all-in-one, battery powered audio solutions that are ideal for both indoor and outdoor events of various crowd sizes from 100 up to 4,500+ people that is affordable and backed by a six-year warranty.

ATHLETICS:

Goal:

Provide a loud, portable, and durable audio solution for coaches and announcers for both indoor and outdoor practices, games, and tournaments.

How is Anchor Audio a Solution:

Anchor Audio provides battery powered portable sound and PA systems that are lightweight and loud with durable, fade resistant enclosures - all without sacrificing its high-quality sound. These versatile sound systems that can be easily transported with hassle-free, quick set up.

MARCHING BAND & PAGEENTRY:

Goal:

Provide a loud, portable, and durable audio solution for directors and announcers at both indoor and outdoor practices, performances, and competitions.

How is Anchor Audio a Solution:

Anchor Audio provides battery powered portable sound and PA systems that are lightweight and loud with durable, fade resistant enclosures. With high-quality sound that be heard over the instruments, these versatile sound systems are also easily transported with hassle-free, quick set up.



anchoraudio.com | 800.262.4671



CLASSROOM AMPLIFICATION

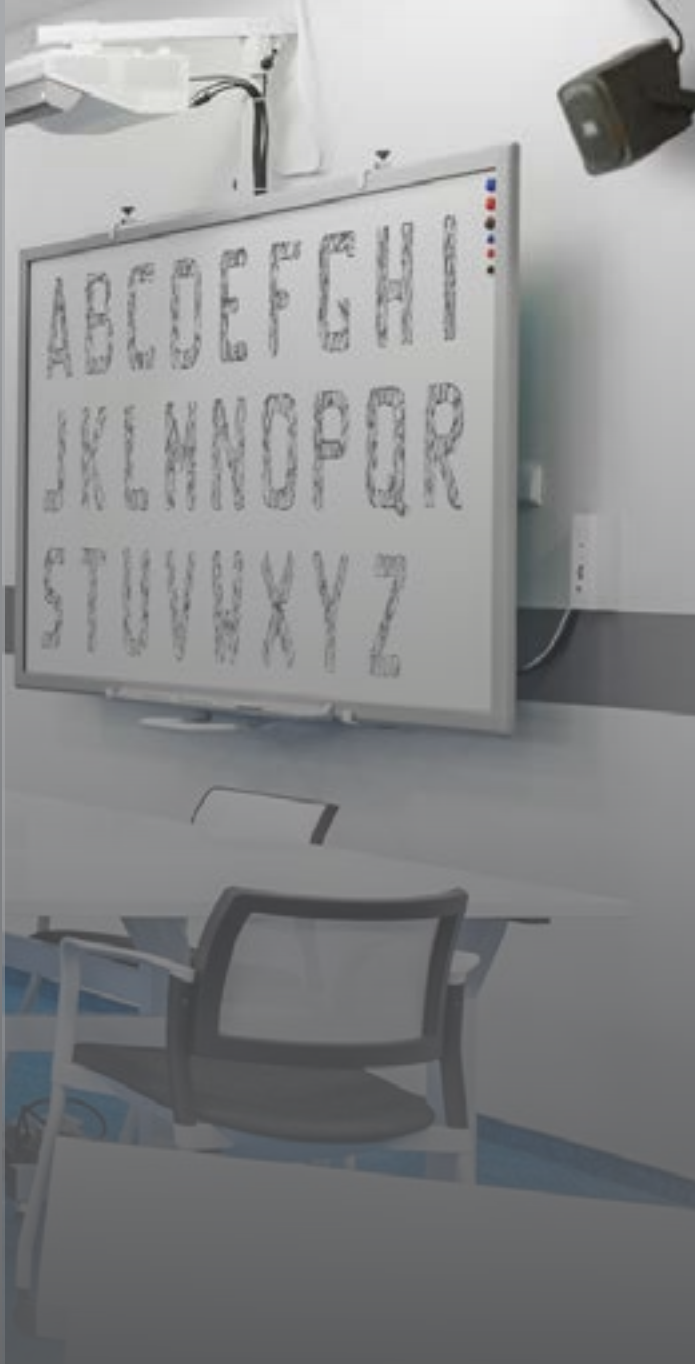

anchoraudio.com | 800.262.4671



BUYING GUIDE: Classroom Audio Systems

Classroom amplification systems make it easy for students to hear the instructor no matter where they are seated in the classroom or lecture hall. Educators also like them because they help to reduce vocal strain. To ensure you purchase the best classroom audio system, consider the following points.

QUESTIONS TO CONSIDER

- What is your budget?
- Will the system be installed or portable?
- Do you need a wireless microphone? What style of wireless microphone?
- What is the layout or design of the space?

PORTABILITY

Do you want an **installed** or **portable** system?

An **installed** audio system is defined as speakers and receivers that are mounted directly on the wall or ceiling. It is a great option for a long-term application in the same classroom or facility. An installed or permanent system can come with a high cost which is due to the individual components that need to be purchased and the skilled labor to assemble and operate the system.

A **portable** audio system can be easily moved or carried from one location to another. This is a great solution for schools with tightened budgets or that need to efficiently stretch their budget. Because the speakers and receivers are portable, educators can easily share and transport AV equipment. Portable audio systems are typically a low cost solution without sacrificing sound quality.

WIRELESS RANGE

When choosing a classroom amplification system, knowing the wireless range you will need for your system is a critical piece of information. How large or small is the classroom? Are there any obstructions that would block or interfere with the wireless signal? What is the wireless range desired or needed for this particular space? The wireless range of a classroom audio system will vary from product to product with some signals reaching up to 50 feet and others extending over 100 feet.

**Anchor Audio's wireless range is 300 feet line of sight for all portable sound systems and 175 feet line of sight for all speaker monitors.*

MICROPHONE

What type or style of microphone do you envision for your application? Do you prefer a wearable microphone? A hands-free option, such as a headband microphone, is ideal for individual use. However, a wireless handheld microphone helps to encourage and allow student involvement and participation.

LAYOUT

Whether an installed or portable option was chosen, the positioning of the speakers comes in to play on both options based on the layout and design of the classroom or available space. The ceiling or wall placement may be determined by the angles, alcoves, speaker dispersion, and aesthetics of the classroom. A portable option can be placed anywhere in the classroom - front or back - and moved, if necessary. By considering these factors, you can determine the optimal and effective placement of the audio systems for your space.



anchoraudio.com | 800.262.4671



Quick Facts about Students, Instructors, and Classrooms

How classroom amplification technology can benefit multiple facets of a school

- Anchor Audio classroom amplification products are designed to vastly improve a teacher or instructor's voice clarity so that students in the back of the classroom hear as clearly as those in the front.
- Half of all teachers experience voice disorder at some time in their career. This is compared to the approximate 5% for the general population (Roy et al., 2004)
- 45% of the school day, children are engaged in listening activities (Berg, 1987)
- The average grade school student misses 25% of what a teacher says (Crandell & Smaldino, 1994)
- Classroom listening is facilitated through the use of classroom amplification technology which is the most cost-effective and acceptable technique (Berg, 1993)
- 96% of teachers have noted improvement in student attentiveness, listening, and comprehension after using an classroom amplification system (Rosenberg, 1996)
- Elementary school teachers surveyed have rated classroom amplification systems their most useful teaching technology (Allen, 1993)
- After using a classroom amplification system, 92% of teachers noted less emotional strain — and as much as 60% fewer sick days from vocal problems (Rosenberg, 1996 & Allen, 1996)
- Spelling scores of 3rd, 4th, and 5th graders have improved by 15%, 12%, and 21% respectively after using a classroom amplification system (Zabel & Tabor, 1996)
- With the use of voice amplification system, student achievement increases by 45% (Adams, 2015)

References:

- Adams, L. (Ed.). (2015). Sound reinforcement and PA systems. *Teaching Technology for Education*, (13), 6-9.
- Allen, L. (1993). Promoting the Usefulness of Classroom Amplification Equipment. *Educational Audiology Monograph* 3, 32-34.
- Allen, L. (1996). The Effect Sound Field Amplification has on Teacher Vocal Abuse Problems. Poster session presented at the Annual Meeting of the American Speech-Language-Hearing Association.
- Berg, F. S. (1987). *Facilitating classroom listening: A handbook for teachers of normal and hard of hearing students*. Boston, MA: College-Hill Press/Little, Brown.
- Berg, F. S. (1993). *Acoustics and sound systems in schools*. San Diego, CA: Singular.
- Crandell, C., & Smaldino, J. (1994). An update of classroom acoustics for children with hearing impairment. *The Volta Review*, 96, 291-306.
- Rosenberg, G. (1996). Improving Classroom Acoustics. Poster session presented at American Academy of Audiology.
- Roy, Nelson, Ray M. Merrill, Susan Thibeault, Steven D. Gray, and Elaine M. Smith. "Voice Disorders in Teachers and the General Population." *Journal of Speech Language and Hearing Research* 47.3 (2004): 542-51. Web.
- Zabel, H., & Tabor, M. (1993). Effects of soundfield amplification on spelling performance of elementary school children. *Educational Audiology Monograph*, 3, 5-9.



anchoraudio.com | 800.262.4671



An Affordable & Compact System for Classroom Amplification

A Simple and Versatile Classroom Amplification for a Large School District

Executive Summary

A large Florida school district that currently serves over 128,000 children residing in the urban and rural areas of Jacksonville contacted an Audio Visual industry integrator specializing in providing technology-empowered business solutions for world class educational institutions. The goal of the school district was to find a simple and versatile solution to their classroom sound amplification needs while staying within their budget.

CHALLENGES

- Simple and versatile classroom amplification
- High quality sound for effective instruction
- Stay within budget

Technology in the Classroom

Handwriting notes and reading bound books are becoming a thing of the past. Schools are slowly evolving to digital homework and interactive whiteboards. It is a known fact that education in the classroom is transitioning to technology driven activities and lessons, and better yet, the transition to digital education is becoming an affordable, accessible, and more effective strategy now more than ever before. One problem that technology can solve is simply ensuring all students can hear their teacher's instruction. Audio amplification ensures all students the ability to effectively hear all instruction and digital media in the classroom, so implementing this solution should be affordable and easy for educators.

How the AN-30 Helped this Jacksonville, Florida School District

When given the opportunity and the requirements of the district and their 197 schools, Education Technology Specialist, Summer Vyne, confidently suggested Anchor Audio. Its AN-30 speaker monitors are the ideal solution for classroom audio because of their small size and crystal clear voice clarity. The AN-30 packs a punch with 100 dB of clear sound, and easily fills a classroom with up to 100 students. Combine the AN-30 speaker monitors with a projector for a perfect audiovisual solution in any classroom or conference room. After learning Anchor Audio's products are both made in the USA and backed by a strong 6-year warranty, the school district demoed the product and instantly knew it was exactly what they needed. At a price they could afford, they immediately followed through and placed the order for over 2,000 AN-30 powered speaker monitors to be installed in the hundreds of classrooms in the sixth largest school district in Florida.

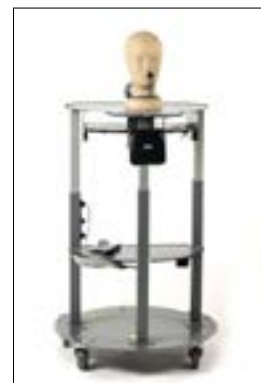

"The speaker allows all students to hear instruction no matter where they are in the room. With education slowly moving to a digital curriculum, this allows teachers to engage with all kids in the classroom without having to worry about everyone hearing the details of a video or presentation. The school district I worked with was incredibly satisfied with the AN-30 classroom amplification system they received and would greatly recommend Anchor Audio's products based on their quality, service, and support."

- Summer Vyne, Education Technology Specialist

Results & Review

After installing the speakers, the Florida school district quickly recognized that Anchor Audio's AN-30 speaker monitors were the perfect solution to their problem. The ability to install the speakers onto AV carts instead of mounting and installing them onto the ceiling saved the school district greatly in construction and electrical costs, which kept the solution very affordable, convenient, and versatile, allowing the AV carts to be shared and moved from classroom to classroom.



anchoraudio.com | 800.262.4671



BLOG: BENEFITS OF CLASSROOM AUDIO

Whether in a kindergarten classroom at a small elementary school or in a college auditorium at a massive state-of-the-art university, the ability to hear your instructor is crucial in students' success. Studies have shown that no matter the age, students who sit near the back of the classroom can miss 30% of what the instructor says because they cannot correctly hear the lecture. Combine that statistic with the fact that hearing loss in young people between the ages of 6-19 is on the rise (according to the American Speech-Language Hearing Association). It has recently been discovered that an estimated 12.5% of students having hearing loss due to extreme noise exposure. All of these indicators lead us to believe that students of all ages could benefit from hearing assistance in classrooms. The following examination is why all working classrooms should consider using an audio amplification system to enhance students learning.

With hearing loss on the rise in young people, focusing in the classroom is becoming more of a struggle for students. The ability to focus is the key to educational success. When a teacher's voice is amplified 5 to 15 decibels (dB) above basic "ambient noise", speech and articulation are significantly improved. With this amplification, instruction can better capture the student's attention and enhance focus. Therefore, classroom audio can improve a student's focus and increase interaction and coordination as a whole.

Sound amplification systems such as Anchor Audio's AN-30 powered speaker monitor provide a solution to the sound challenge in educational spaces such as classrooms. Because Anchor Audio systems are optimized for voice amplification, instruction is crystal clear. Crystal clear voice amplification allows students to more easily comprehend what the teacher is saying, which directly results in a higher retention rate. Teachers who use classroom audio amplification report repeating themselves less and find their students are learning more.

We as humans rely on hearing and sight more than all of our other senses. This is absolutely true in a classroom and all educational facilities. Most students are linguistic learners, which is defined as those who learn the best from hearing or seeing words. Not only is hearing important, but students often rely on visual cues or materials to assist in learning. Versatile solutions are important, which is why Anchor Audio's AN-30 makes lessons more efficient because they allow for incorporation of multi-media sources such as movies, videos, music, audio books, and more.

Anchor Audio's AN-30 powered speaker monitor can be used for variety of applications. Because of its light weight and small size, it is the ideal solution to be installed and mounted on a wall, ceiling, or on even an AV cart. Despite its small profile, the AN-30 easily fills a large conference room or classroom with ease, reaching crowds of 100+. All you have to do is combine our AN-30 system with a projector for the perfect modern audiovisual solution in any classroom.

Don't allow distance, noise, and hearing loss to interfere with students' learning. Purchase an AN-30 powered speaker monitor for your classroom today!



anchoraudio.com | 800.262.4671



BLOG: THE NEW SOUND OF CLASSROOM INSTRUCTION IS A PORTABLE PA SYSTEM

The difficulties a teacher faces in the classroom are usually addressed by improving methods of instruction, attention to the individual needs of students, and classroom management. One of the most significant technical developments over the past 20 years to help with each of these has been the use of the portable PA system to maximize the listening and learning opportunities in the classroom.

According to research by Dr. Mark Ross and Dr. Harry Levitt in an article that first appeared in *Volta Voice*, titled *Classroom Sound-Field Systems*, notes there are over 50 studies testifying to the efficacy of public address systems in the classroom. According to Ross (2002), “children in the amplified classrooms attain higher speech perception and spelling scores, attend to the teacher for longer periods of time, and score higher on academic achievement tests than children in non-amplified classrooms.”

The rationale behind a portable PA system for classrooms is simple, according to Ross & Levitt. “The purpose of the system is to ensure that the teacher’s voice is clearly audible above the background sounds at all instructional locations within the room. Research has shown that in the average classroom the teacher’s voice usually arrives at the children at a level only 6 dB or so above the background sounds. The extra 8 or 10dB of amplification provided by a classroom sound field system is sufficient to ensure a more suitable speech to noise ratio.”

Public address systems, however, vary widely in their quality and adaptability. Earlier systems would occasionally hiss or operate with abrupt changes in volume—frustrating to teachers and a distraction to learning. Additionally, they were commonly cumbersome, and required complex set-up and sound checks by skilled technicians often operating a mixing board.

To handle the demands of modern schools and classrooms, manufacturers such as Anchor Audio in San Diego, CA, produced a new generation of affordable portable public address systems designed to be flexible, long-lasting, powerful, and simple to use, while maintaining a consistently high level of clarity and sound quality. Not only are the systems made in the USA but there are no backorders, which means that you can get your PA system right away. Plus, the system is backed by a six-year warranty, so you can rely on its dependability and durability.

Teachers appreciate that a portable PA system can save them from straining their voices. Many have reported that at times over the course of their careers, vocal strain had caused them to miss work or impaired their effectiveness as a teacher.

Sandra Prewitt, a teacher in the Sanger Academy Charter School District in California, considers the Anchor Audio portable PA system indispensable. “I have damaged vocal chords that become very irritated when my allergies act up. This causes my voice to become very raspy. Usually by 8:00 p.m. I am at a complete whisper. I have enjoyed using this unit because I am able to speak in a soft voice, and the students can still hear me. When I go home, my voice does not feel tired, and I’m able to enjoy conversations at home.”

Nancy Penny, a third-grade teacher also at Sanger Academy, uses an Anchor Audio AN-130+ PA system in her classroom. “The wireless headset allows me the freedom to move about the classroom and grab the attention of my students,” she says. “Using the portable public address system has saved my voice from the strain I put on it.”



anchoraudio.com | 800.262.4671



BLOG: PORTABLE VS. INSTALLED PUBLIC ADDRESS SYSTEMS: ECONOMICAL, FLEXIBLE, RELIABLE, AND EASY TO USE

Educational facilities require high quality public address systems but can't always afford a professional sound system installation. A portable sound system may be the answer.



In an effort to squeeze maximum utility out of minimal equipment outlay, budget-conscious schools and other facilities are increasingly turning to the portable public address (PA) system as an answer to the high cost of installing a fixed system in every room where sound or music might be required. This trend toward opting for a mobile PA system that most anyone can quickly set up and use yields greatly increased savings over the limitations imposed by a fixed system.

An outdoor athletic field might require a sound system, another might be required in the auditorium, cafeteria, or common area, and yet another might be required in the gym.

Further, classrooms and lecture halls have ever-increasing requirements for sound equipment. Permanent, installed sound systems for each of these locations would be cost prohibitive for most institutions; however, one or two shared portable systems could provide a solution at an affordable price.

Portable sound system technology has evolved over the years to provide a serious alternative to installed sound systems. In many cases, a portable system will actually deliver clearer sound than an installed system because all of the components are designed to work together as a package. The amplifier, mixer, microphones and speakers are factory engineered to work together without distortion. In a permanent installation, the professional sound contractor attempts to achieve this balance of components with varying degrees of success.

Summer Vyne, an education technology specialist that provides technology-empowered business solutions, says, "I recommend portable systems for outside functions and schools who can only afford one sound system—one that is able to go into their media center, into their lunchroom, or outside onto the football field. A lot of elementary schools go that route. Today, sound systems are also a vital necessity in the classroom", says Vyne. "A great deal of content now is being delivered via CD from publishers, instead of books. A lot of the curriculum now has sound to it. Portable systems are the solution so teachers can share, as they may not have the funds for everybody to have one installed in the room."

Anchor Audio, based in San Diego, CA, is a manufacturer of a broad line of easy-to-use, high-quality durable portable sound systems for schools, churches, hotels, corporate, military and other institutions. The company has been specializing in portable audio products for over 40 years and has developed a range of systems to meet virtually every need from small devices for simple voice amplification to higher-end systems suitable for voice and music in larger settings.

The high cost of permanent systems comes from the separate components that must be purchased, including amplifiers, CD players, mixers, and speakers and the skilled labor to assemble and operate the system. But the portable systems are built to be all-inclusive of these components. The portable systems also carry another advantage for most users – there's no installation involved. Systems from Anchor Audio are self-contained, with speakers and components that allow the system to be put to use in moments.

Portable sound systems provide an economical, flexible, reliable and easy-to-use alternative to installed sound system. They are becoming the product of choice for high quality public address in the institutional marketplace.



anchoraudio.com | 800.262.4671



Customer Experiences & Reviews

Our customers say it best...



Importance of Classroom Amplification

Susan Orton, retired teacher and principal at a San Diego elementary school, discusses the importance of a quality amplification system for the classroom for various reasons. Increase your classrooms effectiveness and efficiency as well as student learning and participation with an Anchor Audio audio solution.

WATCH HERE: <https://youtu.be/7BBkoWCkf0>

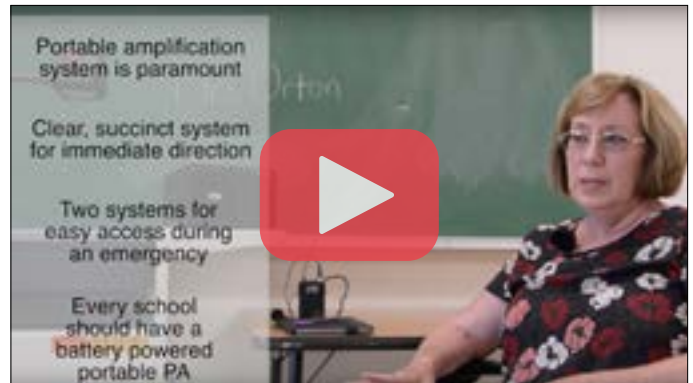

Emergency Preparedness for Schools

Susan Orton, retired teacher and principal at a San Diego elementary school, understands and promotes the importance of a quality sound amplification system for emergency and disaster preparedness. Be prepared with a battery powered PA system - effective communication can help save lives.

WATCH HERE: https://youtu.be/Ob_pQ1FYSBI

[AN-130+](#)

"Our AN-130+ helps increase student attention. Our teachers use the AN-130+ everyday, they are wonderful."

– Berlin Elementary

[AN-135+](#)

"We use the AN-135+ with our projector/DVD/internet for sound reinforcement in an auditorium. I never set up a sound project with out one of our speakers. We love it!"

– Averill Park High School

[AN-Mini](#)

"I have an [AN-Mini] speaker that is connected to a computer, or I connect it to a microphone that goes on my head when I teach. I use it when I teach hands-on projects or do theatrical lessons. It does help me to save my voice and still keep all the students engaged and have their attention. This year, many elective teachers who come into my classroom use the mini speaker that is connected to the computer, and it helps with sounds when we play videos or sounds from the computer. It definitely helps in education and our classroom, and [it] helps all my students be more engaged technologically with this enhancement through the use of [the] speaker."

– (Diana) Mrs. Pham, 3rd Grade of Old Town Academy

[AN-30](#)

"Unbelievable power and clarity for such a small light weight speaker."

– Vickie B., St. Pius X School, Indianapolis, IN



anchoraudio.com | 800.262.4671



Classroom Amplification

Compare our solutions side by side...



Features	AN-1000X+	AN-130+	AN-135+	AN-Mini	AN-30
Crowd Size	250+	150+	150+	100+	100+
Max SPL	107 dB	103 dB	103 dB	100 dB	100 dB
Power Output (Watts)	50W AC mode	30W AC mode	30W AC mode	30W AC/DC mode	30W AC mode
Battery Life	-	-	-	10 - 12 hours	-
Battery Type	-	-	-	AA NIMH 2.5 Ah	-
Warranty	6 years	6 years	6 years	6 years	6 years
Country of Origin	USA	USA	USA	USA	USA
Inputs & Outputs					
3.5 mm AUX Line In		X	X	X	X
XLR Mic Input	X				
1/4" Mic Input		X		X	
1/4" Line In	X	X	X		X
3.5 mm AUX Mic Input				X	
Mono RCA Line In	X				
Mono RCA Line Out	X				
1/4" Speaker Out	X				
1/4" Line Out		X			
3.5 mm AUX Line Out			X	X	X
Advanced Features					
Color Available in Black	X	X	X	X	X
Color Available in White		X	X		
Remote Control		X			
Packages Available	X	X		X	X
Bracket Mountable	X	X	X		X
Stand Mountable	X	X	X	X	X
Up to Two Wireless Mics	X	X		X	



anchoraudio.com | 800.262.4671



TECH SPECS

- 107 dB of clear sound
- 50W AC mode
- 1.9 GHz wireless frequency
- 1/4" line input
- Balanced XLR input
- 1/4" line output to daisy chain multiple units
- Mic/line level dip switch
- One 4.5" woofer
- One 10 mm dome tweeter

FEATURES

- Reaches crowds of 250+
- Connect up to two wireless mics
- Built-in bracket mount screws for easy installation (bracket with Allen wrench sold separately)

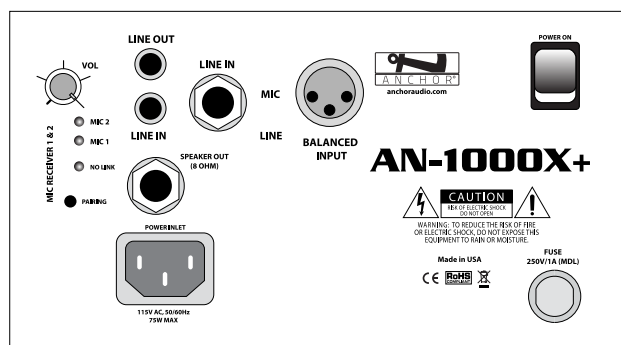

(AN-1000XU2+ Back Panel)

Technical Specifications

Rated Power Output	50 watts AC
Max SPL @ Rated Power	107 dB @ 1 meter
Frequency Response	65 Hz – 20 kHz \pm 3 dB
Microphone Wireless Frequency	1.9 GHz DECT
Microphone Wireless Range	150' + line of sight
Line Inputs	Hi-Z, unbalanced, 1/4" phone & RCA
Balanced Inputs	Microphone / line configurable, female XLR, switchable phantom power
Line Output	Lo-Z, RCA, buffer isolated line-level
Speaker Output	8 Ω , unswitched, 1/4" phone
Speaker Type	4.5" woofer, 10 mm dome tweeter
AC Power Requirements	110 - 125 VAC, 50/60 Hz 50W max
Export Model Power Requirements	208 - 240 VAC, 50/60 Hz 50W max
Fuse Rating	T 1.0A / 250V (internally mounted)
Export Model Fuse Rating	T 0.5A / 250V (internally mounted)
Dimensions (HWD)	9" x 8" x 5.5" (23 x 21 x 14 cm)
Weight	6.5 lbs / 2.9 Kg

AN-1000X+ Models

AN-1000X+	AN-1000X+ powered speaker monitor
AN-1000XU2+	AN-1000X+ with built-in dual wireless mic receiver
AN-1001X+	AN-1001X+ unpowered companion speaker

Microphones

WH-LINK	Wireless handheld mic (1.9 GHz)
WB-LINK	Wireless belt pack transmitter (1.9 GHz)
HBM-LINK	Headband mic (3.5 mm plug)
CM-LINK	Collar mic (3.5 mm plug)
EM-LINK	UltraLite mic (3.5 mm plug)
LM-LINK	Lapel mic (3.5 mm plug)
MIC-90	Handheld mic with 20 ft. cable (XLR plug)

Accessories

SC-50	Companion speaker cable (1/4" phone plug) - 50 ft.
SB-3BK+	40° tilt bracket ceiling mount - black
SB-360BK+	360° swivel wall mount - black
RM-1BK+	Single rack mount - black
RM-12BK+	Double rack mount - black
SS-250	Speaker stand for AN-100CM+, AN-130+, AN-135+ and AN-1000X+
CC-100	Carrying bag for AN-100CM+, AN-130+, AN-135+ and AN-1000X+
CC-100XL	Extra large carrying bag for AN-100CM+, AN-130+, AN-135+ and AN-1000X+
HC-ARMOR24-AN	Anchor Armor rolling hard case - AN series



(Features & Specifications Subject to Change Without Notice)

anchoraudio.com | 800.262.4671



TECH SPECS

- 103 dB of clear sound
- 30W AC mode
- 1.9 GHz wireless frequency
- 3.5 mm AUX & 1/4" line input
- 1/4" wired mic input
- 1/4" line output to daisy chain multiple units
- One 4.5" woofer
- One 10 mm dome tweeter

FEATURES

- Reaches crowds of 150+
- Connect up to two wireless mics
- Optional remote control
- Built-in bracket mount screws for easy installation (bracket with allen wrench sold separately)
- Available in black or white

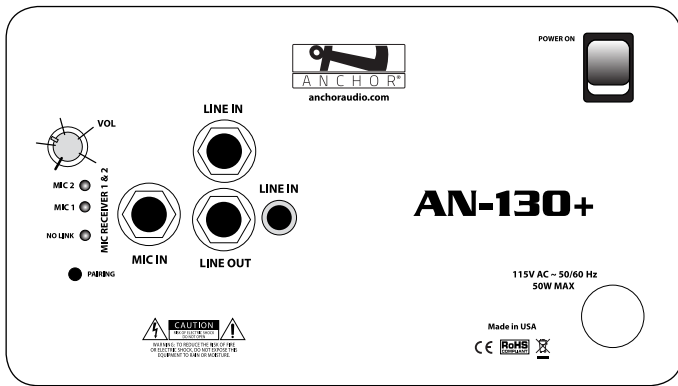

(AN-130U2+ Back Panel)

Technical Specifications

Rated Power Output	30 watts AC mode
Max SPL @ Rated Power	103 dB @ 1 meter
Frequency Response	65 Hz – 18 kHz ± 3 dB
Microphone Wireless Frequency	1.9 GHz DECT
Microphone Wireless Range	150' + line of sight
Line Inputs	Hi-Z, unbalanced, 1/4" phone, 3.5 mm
Microphone Input	Lo-Z, unbalanced, 1/4" phone
Line Output	Lo-Z, buffered, 1/4" phone
Speaker Type	4.5" woofer, 10 mm dome tweeter
AC Power Requirements	110 - 125 VAC, 50/60 Hz 50W max
Export Model Power Requirements	208 - 240 VAC, 50/60 Hz 50W max
Fuse Rating	T 1.0A / 250V (internally mounted)
Export Model Fuse Rating	T 0.5A / 250v (internally mounted)
Dimensions (HWD)	9" x 8.5" x 5.5" (23 x 22 x 14 cm)
Weight	6 lbs / 2.7 Kg
Warranty	6 years
Sensitivity for Rated Output	
Line	-20 dBV (100 mVms)
Microphone	-43 dBv (7.5 mVms)

AN-130+ Models

AN-130+	AN-130+ powered speaker monitor - white
AN-130BK+	AN-130+ powered speaker monitor - black
AN-130U2+	AN-130+ with built-in dual wireless mic receiver - white
AN-130U2BK+	AN-130+ with built-in dual wireless mic receiver - black
AN-130RC+	AN-130+ with remote control - white
AN-130RCBK+	AN-130+ with remote control - black
AN-130U2RC+	AN-130+ with built-in dual wireless mic receivers and remote control - white
AN-130U2RCBK+	AN-130+ with two built-in dual wireless mic receivers and remote control - black

Microphones

WH-LINK	Wireless handheld mic (1.9 GHz)
WB-LINK	Wireless belt pack transmitter (1.9 GHz)
HBM-LINK	Headband mic (3.5 mm plug)
CM-LINK	Collar mic (3.5 mm plug)
EM-LINK	UltraLite mic (3.5 mm plug)
LM-LINK	Lapel mic (3.5 mm plug)
MIC-90P	Wired handheld mic with 20 ft. cable (1/4" phone plug)

Accessories

SB-3W+/SB-3BK+	40° tilt bracket ceiling mount - white or black
SB-360W+/SB-360BK+	360° swivel wall mount - white or black
RM-1BK+	Single rackmount - black
RM-12BK+	Double rackmount - black
SS-250	Speaker stand for AN-100CM+, AN-130+, AN-135+ and AN-1000X+
CC-100	Carrying bag for AN-100CM+, AN-130+, AN-135+ and AN-1000X+
CC-100XL	Extra large carrying bag AN-100CM+, AN-130+, AN-135+ and AN-1000X+
HC-ARMOR24-AN	Anchor Armor rolling hard case - AN series
REMOTE-130	Infrared remote control (AN-130RC+ only)



anchoraudio.com | 800.262.4671



(Features & Specifications Subject to Change Without Notice)

TECH SPECS

- 103 dB of clear sound
- 30W AC mode
- 3.5 mm AUX & 1/4" line input
- 3.5 mm AUX line output to daisy chain multiple units
- One 4.5" woofer
- One 10 mm dome tweeter

FEATURES

- Reaches crowds of 150+
- Built-in bracket mount screws for easy installation (bracket with Allen wrench sold separately)
- Available in black or white

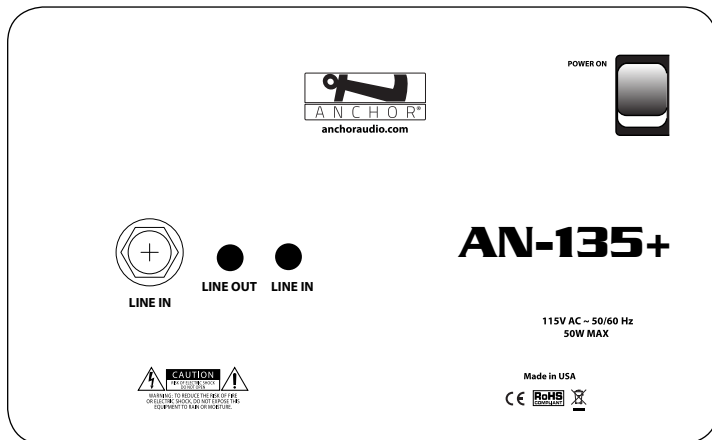

(AN-135+ Back Panel)

AN-135+ Models	
AN-135+	AN-135+ - white
AN-135BK+	AN-135BK+ - black
Accessories	
SB-3W+/SB-3BK+	40° tilt bracket ceiling mount - white or black
SB-360W+/SB-360BK+	360° swivel wall mount - white or black
RM-1BK+	Single rackmount - black
RM-12BK+	Double rackmount - black
SS-250	Speaker stand for AN-100CM+, AN-130+, AN-135+, and AN-1000X+
CC-100	Carrying bag for AN-100CM+, AN-130+, AN-135+, and AN-1000X+
CC-100XL	Extra large carrying bag for AN-100CM+, AN-130+, AN-135+, and AN-1000X+
HC-ARMOR24-AN	Anchor Armor hard case - AN series

Technical Specifications	
Rated Power Output	30 watts
Max SPL @ Rated Power	103 dB @ 1 meter
Frequency Response	65 Hz – 18 kHz
Speaker Type	4.5" woofer, 10 mm dome tweeter
Line Inputs	Line level, 3.5 mm stereo & 1/4" phone - mono
Line Outputs	Line level, 3.5 mm stereo
AC Power Reqs.	110 - 125 VAC, 47/63 Hz 50W max
Export Model Power Reqs.	208 - 240 VAC, 50/60 Hz 50W max
Fuse Rating	T 1.0A / 250V (internally mounted)
Export Model Fuse Rating	T 0.5A /250v (internally mounted)
Dimensions (HWD)	9" x 8.5" x 5.5" (23 x 22 x 14 cm)
Weight	6 lbs / 2.7 Kg
Warranty	6 years



(Features & Specifications Subject to Change Without Notice)

anchoraudio.com | 800.262.4671



MiniVox Lite / AN-MINI



MiniVox Lite

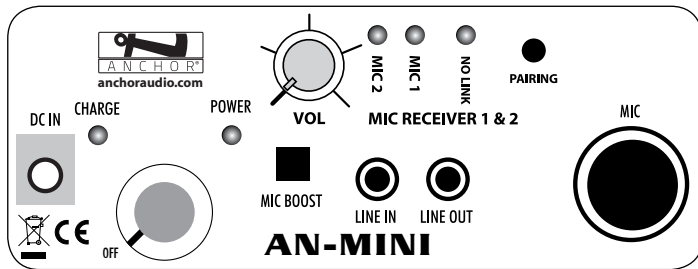

(AN-MINI2 Back Panel)

TECH SPECS

- 100 dB of clear sound
- 30W AC/DC mode
- 1.9 GHz wireless frequency
- 1/4" mic input
- 3.5 mm AUX line input
- Rechargeable AA alkaline batteries
- One 4.5" woofer

FEATURES

- Reaches crowds of 100+
- Connect up to two wireless mics
- Mic boost button
- Batteries operate 10 - 12 hours on a single charge
- Optional rechargeable battery kit

Technical Specifications	
Rated Power Output	30 watts AC/DC
Max SPL @ Rated Power	100 dB @ 1 meter
Frequency Response	100 Hz – 15 kHz ± 3 dB
Microphone Wireless Frequency	1.9 GHz DECT
Microphone Wireless Range	150' + line of sight
Line Input	Line level, 3.5 mm
Microphone Input	Lo-Z, 1/4" phone
Line Output	Line level, 3.5 mm
Speaker Type	4.5" Neodymium woofer
Battery	Ten 'AA' alkaline
Dimensions (HWD)	5.5" x 5.5" x 6" (14 x 14 x 15.24 cm)
Weight	2.5 lbs / 1.13 Kg
Warranty	6 years
RC-30 - Battery Recharge Kit	
Battery Type	Ten 'AA' size, NiMH 2.5 Ah
AC-30 Input	120 VAC, 60 Hz
AC-30/220 Input	220 VAC, 50 Hz

MiniVox Lite / AN-Mini Models

AN-MINI	Personal PA System (does not include RC-30)
AN-MINI2	AN-MINI with built-in dual wireless receiver (does not include RC-30)

MiniVox Lite / AN-Mini Packages

Lite-BP	<ul style="list-style-type: none"> - AN-MINI - Soft case (SOFT-MINI) - Wired handheld mic - 1/4" plug (MIC-50) - Battery recharge kit (RC-30)
Lite-DP	<ul style="list-style-type: none"> - AN-MINI2 with built-in dual wireless receiver - Soft case (SOFT-MINI) - Wired handheld mic - 1/4" plug (MIC-50) - Battery recharge kit (RC-30) - Choice of one wireless handheld mic or headband and lapel mic with belt pack
AN-MINIDP	<ul style="list-style-type: none"> - AN-MINI2 - Battery recharge kit (RC-30) - Choice of one wireless handheld mic or headband and lapel mic with belt pack

Microphones

WH-LINK	Wireless handheld mic (1.9 GHz)
WB-LINK	Wireless belt pack transmitter (1.9 GHz)
HBM-LINK	Headband mic (3.5 mm plug)
LM-LINK	Lapel mic (3.5 mm plug)
CM-LINK	Collar mic (3.5 mm plug)
EM-LINK	UltraLite mic (3.5 mm plug)
HBM-50	Wired headband mic (1/4" plug)
MIC-50	Wired handheld mic (1/4" plug)

Accessories

MINI-15ST	Stereo mini-plug cable - 15 ft.
SS-300	Speaker stand for AN-MINI, MiniVox Lite, and AN-30
SOFT-MINI	Soft case - AN-MINI
RC-30	Battery recharge kit for AN-MINI, MiniVox, and TourVox
AC-30	AN-MINI adapter



anchoraudio.com | 800.262.4671



(Features & Specifications Subject to Change Without Notice)

TECH SPECS

- 100 dB of clear sound
- 30W AC mode
- 1/4" & 3.5 mm AUX line input
- 3.5 mm AUX line output to daisy chain multiple units
- One 4.5" woofer

FEATURES

- Reaches crowds of 100+
- Stand mountable
- Built-in bracket mount screws for easy installation (bracket with Allen wrench sold separately)

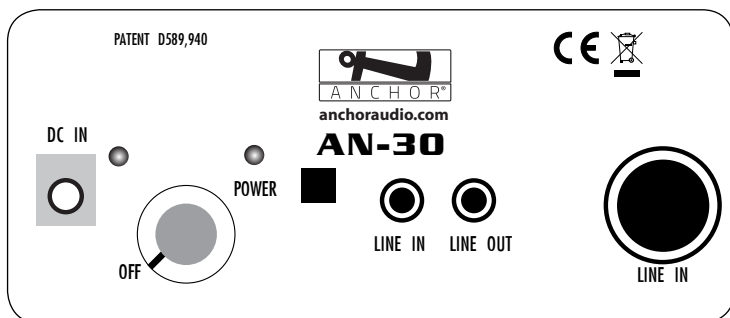

(AN-30 Back Panel)

AN-30 Model & Package

AN-30	AN-30 powered speaker monitor (includes AC-30)
AN-30CP	Includes AN-30, AC-30, and SB-30
Accessories	
MINI-15ST	Stereo mini-plug cable - 15 ft.
SB-30	180° tilt wall or ceiling mount bracket
SS-300	Speaker stand for AN-MINI, MiniVox Lite, and AN-30
AC-30	AN-MINI adapter

Technical Specifications

Rated Power Output	30 watts AC
Max SPL @ Rated Power	100 dB @ 1 meter
Frequency Response	100 Hz – 15 kHz ± 3 dB
Speaker Type	4.5" Neodymium woofer
Line Out	Line level, 3.5 mm - stereo
Line In	Line level, 3.5 mm stereo & 1/4" phone - mono
DC Input Jack	12 - 20V, 2A Min
Dimensions (HWD)	5.5" x 6" x 5.5" (14 x 15.2 x 14 cm)
Weight	1.5 lbs / 0.68 Kg
Warranty	6 years



anchoraudio.com | 800.262.4671



(Features & Specifications Subject to Change Without Notice)

INDOOR & OUTDOOR EVENTS



anchoraudio.com | 800.262.4671



BUYING GUIDE: Portable PA Systems for Indoor & Outdoor Events

Indoor and outdoor amplification systems make it easy for students, parents, and staff to hear the principal, speaker, and announcer no matter where they are on the field, in the gym or common area, or in the stands. To ensure educators purchase the best outdoor audio system, consider the following points.

QUESTIONS TO CONSIDER

- What is your budget?
- What is your typical audience size? How much space do you need to cover?
- Do you need a wireless microphone? How many? Distance of wireless range?
- What inputs and outputs do you need?
- Do you have easy access to a power source?
- Do you need any special features or accessories for your PA system?

Audience Size & Coverage

The audience size and coverage area will determine the portable PA system size you will need whether that is a full-size public address system or personal PA. These answers will also help to determine if multiple speakers are needed and how and where they are placed. Many full-size systems are a single, easy to move unit with the capability to be expandable with companion units. A personal PA system is usually small in size and often wearable.

Wireless Range & Applications

When choosing an outdoor amplification system, knowing the wireless range, capabilities, and applications you will need for your system is a critical piece of information. How large or small is the venue or facility? Are there any obstructions that would block or interfere with the wireless signal? What is the wireless range desired or needed for this particular space? The wireless range of an outdoor audio system will vary from product to product with some signals reaching up to 50 feet and others extending over 100 feet. How many wireless microphones do you need? Do you plan to wirelessly connect any devices such as a mobile phone to the system? Understanding how the wireless will be used will help determine the appropriate wireless microphone choices.

Inputs/Outputs

Understanding how you intend to use the system in terms of devices and connections will determine what inputs and outputs you require. Requirements may include microphones, companion speakers, and other auxiliary sources such as a mobile device or MP3 player. Find a portable PA system that meets or exceeds these needs. The two most common connectors include XLR and 1/4".

Power Source

A PA system will operate on either AC (alternating current) power, DC (direct current) power, or both. AC units are powered using a wall outlet while DC units utilize a rechargeable battery. A rechargeable self contained public address system is completely portable and can therefore easily be transported around the school. Plus there are no messy cables to connect to a power source.

Portability

This feature comes into play not only with the power source but also in how easily you can move the system around the school. Factors to consider with portability include battery power, weight, carrying case accessories, and built-in features such as wheels or a handle.

Special Features & Accessories

Depending on how you will use the PA or sound system, there are a variety of special features and accessories to enhance your experience and performance such as wireless microphones, Bluetooth, media device players, wired or wireless companion speakers, carrying cases, speaker stands, and more.



anchoraudio.com | 800.262.4671



Liberate Your School from the Constraints of a Tight Budget



A Single Portable Wireless Sound System to Serve the Entire School Population



Executive Summary

Reidy Creek Elementary School was in need of a single, multipurpose portable sound system that would serve the entire school population and could be used across a variety of school activities. The Anchor Audio Liberty Platinum was a great fit and had all the components that would meet a variety of needs for the entire school.

Challenges

- One speaker to serve 700 people
- Portable for a variety of applications
- Easy to use and high quality sound

About Reidy Creek Elementary School

Reidy Creek Elementary School, located in Escondido, CA, opened in 2006 with the mission and belief that schools, in partnership with parents and the community, are responsible for preparing students for a successful transition into society by providing safe learning environment and access to child-centered activities that build basic skills, encourage higher level thinking, foster independence and promote positive character development. Knowing they would need a dependable PA system to help deliver on these promises, a grant proposal was drafted, submitted, and successfully secured the funds for an audio system that would have the capability to serve the entire school population with quality, intelligible sound.

How the Liberty Platinum Helped Reidy Creek School

Upon delivery of the Anchor Audio Liberty Platinum portable sound system, Kellie Stawicki, a teacher at Reidy Creek, noted that "it was very easy to sync to my devices and use immediately" with the built-in Bluetooth. With two wireless microphones and 6 - 8 hours of battery power, the sound system was a great fit for the school's group morning workouts, physical education programs, grade level performances, family event nights, and more. With the ability to reach crowds of 1,500+ with a single system, the Liberty Platinum had "all the components that would meet a variety of needs for [the] school as a whole."



"The Liberty has great sound quality, great warranty, and fantastic value for the cost. I would highly recommend Anchor Audio to any organization."

- Kellie Stawicki, Teacher at Reidy Creek Elementary School

Results & Review

Anchor Audio's helpful and accommodating customer service, top notch warranty, and quick response time reaffirmed their purchase decision. It was an easy decision stated Stawicki. Since purchasing the Liberty, Reidy Creek School has been extremely satisfied with its purchase and would absolutely recommend the Anchor Audio Liberty for any school or school district.



anchoraudio.com | 800.262.4671



One Sound System. A Variety of Applications.



How this Middle School used a Portable PA to Solve All of Their Sound Needs

Executive Summary

Calavera Hills Middle School found themselves with an unreliable installed sound system in their gym. Not only difficult to move around for use in other venues at the school, but audiences could not hear the announcements clearly. They decided to get an alternate system powerful enough to work in the gym that could also be transported to the various venues on campus that occasionally needed sound – the field, the cafeteria, the library, etc. The system needed to be easily portable, easy to use, rugged, and preferably cordless. After much research and getting to demo the sound system for themselves, the Anchor Audio Bigfoot Line Array was everything they wanted and more.

About

Located in Carlsbad, California, Calavera Hills Middle School is a community of students, families, teachers and staff who are dedicated to providing a caring and safe environment in which students can pursue opportunities for greatness and growth. Their mission is a student-centered learning community powered by meaningful, relevant and rigorous content. Critical thinking, collaboration, communication and creativity is used to teach college and career skills to their students. Calavera Hills Middle School has been named a California Distinguished School and received the California Golden Ribbon Schools Award in 2017. In addition, they have also been named a California and National Middle School to Watch by the National Forum to Accelerate Middle Grades Reform.

Challenges

- Reliable, quality sound
- Rugged and portable for easy transport to different venues
- Easy to use by any staff or student
- Cordless for use indoors and outdoors

How the Bigfoot and Liberty AIR Helped Calavera Hills Middle School

Implementation:

After consulting several sound specialists, talking to other schools, and searching the internet, Calavera Hills ultimately learned of the Anchor Audio Bigfoot through a board member who did Jazzercise. In order to truly determine if the Bigfoot Line Array portable sound system and Liberty AIR wireless companion speaker was the best solution for their needs, Calavera Hills worked with Anchor Audio and authorized dealer, AVNow, to set up a live demo at their Memorial Day assembly. The event began in the gym then proceeded to their field where students had the unique opportunity to observe two military helicopters landing on their athletic field. Communication was crucial in order to keep students, staff, and visitors safe and out of harm's way during the helicopter landings. According to Valerie Madden, former PTA president, "we found its [the Bigfoot and Liberty] sound quality even better and clearer than our large built-in system. It was quick and simple to set up, students were able to operate it, and we were able to rapidly move it to a different part of the school to continue our assembly outdoors where we also found the sound quality to be excellent." Not only could they wirelessly connect music using the built-in Bluetooth, but they had the ability to have up to four wireless microphones. With high approval and praise from the Principal, PTA members, choir director, theater director, and other staff, Calavera Hills knew they found the best portable sound solution for their school.

Applications:

Just two days after placing the order and receiving their Bigfoot, Calavera Hills Middle School was rockin' and rollin' with their brand new portable sound system at their talent show. The team rolled the Bigfoot into the gym, opened it up for the first time, easily connected their Liberty AIR wireless companion speaker, pressed a few buttons, and were up and running. "It was so clear and easy! I trained the student body president, choir director and ASB teacher in a matter of minutes based only on what I learned during the demo Anchor gave us before purchase," stated Madden. The school continues to use the Bigfoot public address system at its various school functions including assemblies, awards ceremonies, graduations and promotions, and other indoor and outdoor events.

Results & Review

The team at Calavera Hills Middle School is extremely satisfied with their Anchor Audio Bigfoot Line Array and Liberty AIR portable sound systems. "The customer service is spectacular! Also want to stress again that the compact design and ease of use is a huge plus in a school setting allowing us to use it in all areas of the school and feel assured that whether it is staff, students or parents using the system they will be successful and do no harm to the equipment," said Madden. They are already discussing adding more Anchor AIR wireless companion speakers to expand their system coverage. Calavera Hills is happy to share their recommendation with other schools looking for a quality, portable public address system.

"The Bigfoot met all of our needs: very simple to use, portable, rugged, wireless/cordless, expandable to fit future needs. We are extremely satisfied! It has given us everything we wanted."

- Valerie Madden, Former PTA President



anchoraudio.com | 800.262.4671



BLOG: How to Be Prepared for Emergency Situations at Schools & Universities

Being prepared can help save lives during an emergency or disaster.



Prepare



Respond



Recover

While no one likes to imagine an emergency situation, having an emergency response plan is absolutely critical. When a disaster strikes – no matter how big or small, effective communication makes all the difference. All too often, emergency situations and disaster relief create communication obstacles such as power outages, isolation, and difficulties communicating with large crowds of frightened adults and children. Therefore, finding the best portable PA system to have on standby for when you need it is an important consideration and decision.

Sue Orton, retired San Diego county principal and teacher, says that “a battery powered portable amplification system is paramount” in emergency preparedness. “A portable, easy to use, efficient, and lightweight system with a really good range” is critical in order to “get instructions out clearly and succinctly to reach the greatest number of students and staff at one time,” which is extremely important in providing immediate direction.

When the power is out or if it is too risky to use an outlet, a battery powered portable PA is the best choice. Ensure the safety of yourself, your team, and the frightened individuals relying on you by making sure that the communication device is charged and/or has spare batteries and remains close to evacuation and meeting areas. You need to be able to access and utilize the device when necessary without being in harm’s way.

Features to Consider for Your Emergency Preparedness Toolbox:

- **Battery Powered** – reliable, long-lasting battery in the event of a power outage
- **Easy to Operate** – anyone and everyone can use it
- **Crystal Clear Voice Amplification** – people need to understand what you are saying
- **Effective Range** – small to large crowds are able to hear you depending on your audience size
- **Reliability and Durability** – you depend on this system when it matters most
- **Grab It and Go** – readily available to easily utilize at a moment’s notice

Orton recommends you “have a portable system that is only to be used for emergencies and housed in the office, as well as another system that is housed elsewhere, so you have two [portable PA systems] in case of an emergency.” The secondary or additional systems can also be used for additional activities such as PTA functions, sporting events, special activities, grade level performances, field trips and even as a low-cost, portable option for a public address system for the school auditorium or common area.

“Every school should really have a [battery powered portable PA system] in their emergency preparedness toolbox to help out,” says Orton. By selecting the best portable PA system, you have the capacity to reach out and be heard above a crowd.

Anchor Audio has a variety of portable PA systems such as the MiniVox and MegaVox to the Beacon and Bigfoot that exceed the demands for emergency communications. From small personal portable PAs to large roll-out systems, Anchor Audio is here for you.



anchoraudio.com | 800.262.4671



BLOG: Outdoor Sound System - Features and Benefits

An outdoor sound system that includes a microphone, amplifier, and loudspeaker is becoming a basic necessity at most events where there is an audience that needs to clearly hear a speaker or presenter. During events such as assemblies, pep rallies, graduations, emergency drills, or where there is a large gathering of people, a portable sound system is the perfect tool to address the audience. At Anchor Audio, we can help you to find the best outdoor portable sound system that meets your needs.

Features of Outdoor Systems

A portable sound system is one of the most reliable setups for the outdoors. It requires little to no set-up, is lightweight, and is easy to carry out onto a football field, auditorium, quad, or during any emergency. Best of all, it is battery powered – so you won't need to worry about messy extension cords or power outlets.

An outdoor PA system should give you a great deal of control over the sound quality, while still being simple to use. A quality system delivers powerful sound, while still offering clear and intelligible speech. Depending on the situation, the sound also needs to be loud enough so that it can be heard over emergency equipment, in an active environment, or at a great distance in order to catch people's attention.

At Anchor Audio, we provide a wide range of portable outdoor systems suitable for just about any outdoor application where sound amplification is needed.

Sound System Features to Consider for Your Event:

- Audience Size - determine the wattage and decibel (dB) levels needed
- Venue - the amount of space to cover and any structural design that may effect or distort your sound
- Power Source - do you have easy access to power
- Connectors - do you need any specific inputs or outputs
- Special Features - do you need any special features such as wireless microphones or Bluetooth

Benefits of Outdoor Systems

Portable public address systems, such as the ones we offer at Anchor Audio, used for outdoor environments enable you to amplify your voice across a wide area or over a long distance. They enable you to be easily heard over the crowd and successfully communicate to a large number of people. Some have a siren alert button for emergency situations or drills that will ensure to grab everyone's attention.

Anchor Audio portable outdoor sound systems are also weather resistant and designed for more demanding applications. Since they are rugged and durable, they can operate in difficult weather conditions and are resilient to the extreme heat or cold.

Our products are lightweight and, depending on the model that best fits your application, relatively small in size without compromising the quality of sound, so when not in use, they can be easily stored.



anchoraudio.com | 800.262.4671



BLOG: Indoor & Outdoor Audio Equipment for School Events

A school sound system and audio equipment is needed for a variety of uses and applications. From the gym for athletic events, assemblies, and pep rallies to the stadium for athletic competitions, graduations, and more, a self-contained, portable PA system is the ideal solution.

It is important to keep in mind the requirements of the demanding needs and budget requirements of universities, K-12, and all educational institutions. Communication and public address (PA) systems are one of the most important factors to bear in mind when designing your educational institution or outdoor facility.

There are two main types of PA systems: a self-contained PA system or a powered mixer with PA speakers.

A self-contained PA system can also be referred to as a portable PA system. They are not meant to be permanently installed, however, they can be, if preferred. A portable PA will operate on either AC (alternating current) power, DC (direct current) power, or both. AC units are powered using a wall outlet while DC units utilize a rechargeable battery. A truly portable and completely wireless system operates on battery power but can also be plugged into a power source such as a wall outlet.

A powered mixer system requires a mixing amplifier and separate, sometimes multiple, speakers. It is most often found as a permanently installed system. It is also AC powered and requires a power source in order to operate.

Anchor Audio offers a variety of self-contained portable PA systems from small, wearable systems to large, roll-out sound systems that are designed to provide maximum flexibility. An advantage of portability includes flexibility as they can be used for different types of events and applications including indoor and outdoor functions. They are all-in-one systems, which means they can easily be set up anywhere.

Some of the most popular indoor & outdoor applications include:

Academic Clubs	Emergency Preparedness	Luncheons
Academic Competitions	Extracurricular Activities	Morning Announcements
ASB	Family Nights	PE Class
Assemblies	Field Day	Pep Rallies
Athletic Practices and Competitions	Field Trips	PTA Meetings
Auditorium	Fundraisers	School Bus Coordination
Back to School Night	Grade Level Performances	Sports Facility
Banquets	Graduation	Talent Shows
Disaster Relief	Gymnasium	Volunteer Programs
Emergency Drills	Lectures & Guest Speakers	And More!

Great audio products can help enhance your environment in any application.



anchoraudio.com | 800.262.4671



Customer Experiences & Reviews

Our customers say it best...



Wireless Portable Speakers for Outdoor Mentoring Events

Boys to Men, a San Diego mentoring program, relies on Anchor Audio portable sound systems for outdoor events. The audio quality is crystal clear for voice amplification and background music. The battery powered PA systems are perfect when they can't have power at an event.

Link: <https://youtu.be/KgcOfzFcnUg>

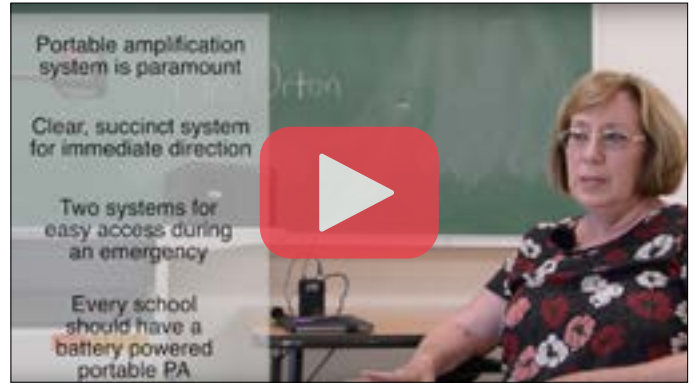

Emergency Preparedness for Schools

Susan Orton, retired teacher and principal at a San Diego elementary school, understands and promotes the importance of a quality sound amplification system for emergency and disaster preparedness. Be prepared with a battery powered PA system - effective communication can help save lives.

Link: https://youtu.be/0b_pQ1FYsBI

Bigfoot Line Array

"It is absolutely wonderful."

– Kevin J. Elza, Athletic Operations & Events Manager, Howard Community College

Beacon Line Array

"The Beacon Sound System has been great for our outside events because it small in size, portable, and easy to transport from our support centers to different locations. It is such a versatile system and convenient to use in pretty much any event; symposiums in a lecture hall or rallies outside."

– Monica Martinez, AV Services Specialist, The University of Texas at San Antonio

Liberty Platinum

"We LOVE our Liberty Sound System. We use it EVERY DAY for our outdoor PE classes. We play music to get the kids moving. Every week we have a school-wide assembly and it is so easy to use with the wireless mics. The BEST PART is you can use it ANYWHERE! No power needed."

– Pamela Marton, Community Magnet Charter ES

Go Getter

"The Go Getter speaker system has allowed our program to better meet the cultural needs of our diverse community here at within our program and across our school. We've used it for everything from sharing important information with large gatherings, to enabling students to play music while learning and celebrating dances from their home cultures. It's portable size makes it very convenient and easy to grab and go all over our campus. It's been an invaluable asset that has allowed us to expand access and the effectiveness of our programming."

– Colleen Gifford, Systems Information Manager, ImpactNW



anchoraudio.com | 800.262.4671



Outdoor & Indoor Events

Compare our solutions side by side



Features	Bigfoot 2	Beacon 2	Liberty 2	Go Getter 2	MegaVox 2	MiniVox Lite	Acclaim 2
Crowd Size	5,000+	2,500+	1,500+	500+	1,000+	100+	500+
Max SPL	130 dB	120 dB	117 dB	109 dB	119 dB	100 dB	113 dB
Power Output (Watts)	400W AC/DC	150W AC/DC	125W AC/DC	75W AC / 50W DC	20W AC/DC	30W AC/DC	22W AC/DC
Battery Life	6 - 8 hours	6 - 8 hours	6 - 8 hours	6 - 8 hours	6 - 8 hours	10 - 12 hours	6 - 8 hours
Battery Type	Lithium Iron Phosphate Rechargeable	Lithium Iron Phosphate Rechargeable	Lithium Iron Phosphate Rechargeable	Lithium Iron Phosphate Rechargeable	Lithium Iron Phosphate Rechargeable	AA NIMH 2.5 Ah	Lithium Iron Phosphate Rechargeable
Warranty	6 years	6 years	6 years	6 years	6 years	6 years	6 years (electronics) 2 years (woodwork)
Country of Origin	USA	USA	USA	USA	USA	USA	USA & China
Inputs & Outputs							
3.5 mm AUX Line In	X	X	X	X		X	
XLR Mic Input	X	X	X	X			
1/4" Mic Input	X	X	X	X	X	X	X
3-pin XLR Mic Input							X
1/4" Line In	X	X	X	X	X		X
3.5 mm AUX Mic Input						X	
1/4" Line Out	X	X	X	X	X		X
Companion Speaker Out			X	X	X		
3.5 mm AUX Line Out						X	
3-pin XLR Output							X
Advanced Features							
Ideal for Music	X	X	X	X		X	X
Ideal for Voice	X	X	X	X	X	X	X
Siren Alert Button					X		
Bluetooth	X	X	X	X	X		
Anchor AIR	X	X	X	X	X		
Up to Two Wireless Mics	X	X	X	X	X	X	X
Up to Four Wireless Mics	X	X	X	X	X		X
CD/MP3 Player	X	X	X	X			



anchoraudio.com | 800.262.4671



TECH SPECS

- 130 dB of clear sound
- 400W AC/DC mode
- 1.9 GHz wireless frequency
- Two universal microphone input jacks
- 1/4" & 3.5 mm AUX line input
- 1/4" line output
- Built-in rechargeable Lithium Ion batteries
- Five 8" neodymium woofers
- One neodymium compression driver

FEATURES

- Reaches crowds of 5,000+
- Connect up to four wireless mics
- Anchor AIR compatible
- Built-in Class 1 Bluetooth
- Onboard mic storage bag
- Heavy duty wheels for easy transport
- Built-in rechargeable batteries operate 6 - 8 hours on a single charge
- Designed to cover a football field or large auditorium

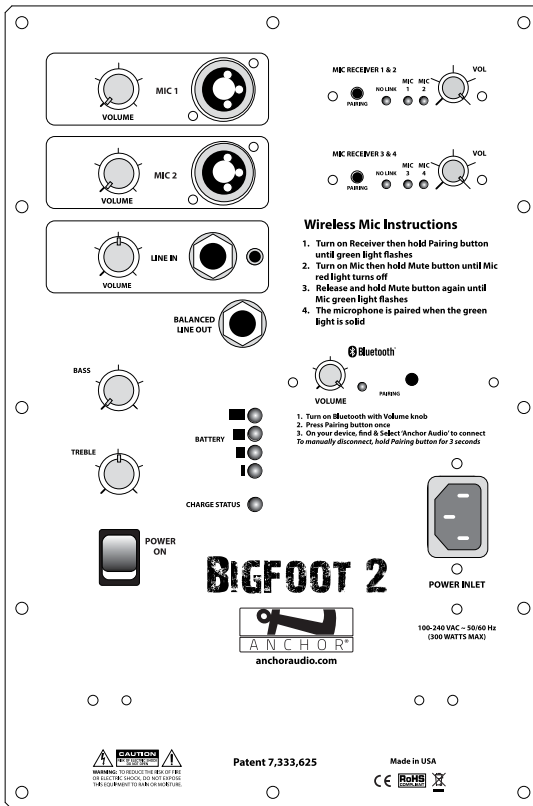
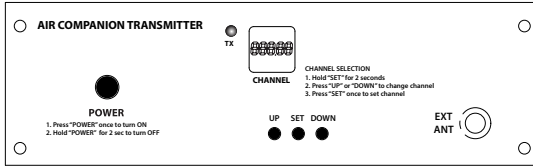

(BIG2-XU4 Back Panel)

Bigfoot 2 Models

BIG2	Bigfoot with built-in Bluetooth
BIG2-U2	Bigfoot with built-in Bluetooth & dual wireless mic receiver
BIG2-U4	Bigfoot with built-in Bluetooth & two dual wireless mic receivers
BIG2-X	Bigfoot with built-in Bluetooth & AIR wireless transmitter
BIG2-XU2	Bigfoot with built-in Bluetooth, AIR wireless transmitter & dual wireless mic receiver
BIG2-XU4	Bigfoot with built-in Bluetooth, AIR wireless transmitter & two dual wireless mic receivers
BIG2-R	Bigfoot with built-in Bluetooth & AIR wireless receiver
BIG2-RU2	Bigfoot with built-in Bluetooth, AIR wireless receiver & dual wireless mic receiver
BIG2-RU4	Bigfoot with built-in Bluetooth, AIR wireless receiver & two dual wireless mic receivers

Microphones

WH-LINK	Wireless handheld mic (1.9 GHz)
WB-LINK	Wireless belt pack transmitter (1.9 GHz)
HBM-LINK	Headband mic (3.5 mm plug)
CM-LINK	Collar mic (3.5 mm plug)
EM-LINK	UltraLite mic (3.5 mm plug)
LM-LINK	Lapel mic (3.5 mm plug)
MIC-90	Wired wandheld mic with 20 ft. cable (XLR plug)

Technical Specifications

Rated Power Output	400 watts AC/DC
Max SPL @ Rated Power	130 dB @ 1 meter
Frequency Response	100 Hz - 15 kHz ± 3 dB
Microphone Wireless Frequency	1.9 GHz DECT
Microphone Wireless Range	300'+ line of sight
Mic Inputs	Lo-Z, balanced, XLR & 1/4" 34V DC condenser mic (phantom) power Hi-Z (10 KΩ), unbalanced, 1/4" phone
Line Inputs	Unbalanced 1/4" & 3.5 mm stereo
Line Output (post fader)	Isolated, 600Ω, 1/4" phone
AC Power Reqs.	100 - 240 VAC, 50/60 Hz, 300W max
Battery	Three 12V LFP rechargeable batteries, 7.5 AH
Dimensions Closed (HWD)	42.5" x 14" x 23" (108 x 38.9 x 61 cm)
Dimensions Opened (HWD)	68.5" x 14" x 23" (174 x 38.9 x 61 cm)
Weight	63.5 lbs / 28.8 Kg
Warranty	6 years

Sensitivity For Rated Output

Lo-Z Microphone	-52 dBV (2.5 mVrms)
Hi-Z Microphone	-43 dBV (7.5 mVrms)
Auxiliary (line)	-14 dBV (200 mVrms)

Anchor AIR Technical Specifications

AIR Frequency Range	902 - 928 MHz
AIR Wireless Range	300'+ line of sight



(Features & Specifications Subject to Change Without Notice)



anchoraudio.com | 800.262.4671



TECH SPECS

- 120 dB of clear sound
- 150W AC mode / 125W DC mode
- 1.9 GHz wireless frequency
- Two universal microphone input jacks
- 1/4" & 3.5 mm AUX line input
- 1/4" line output
- Built-in rechargeable Lithium Ion batteries
- Lightweight array tower has eight 4" neodymium speakers
- Base has three 8" neodymium subwoofers

FEATURES

- Reaches crowds of 2,500+
- Connect up to four wireless mics
- Anchor AIR compatible
- Built-in Class 1 Bluetooth
- Nylon mic storage bag
- Durable wheels for easy transport
- Built-in rechargeable batteries operate 6 - 8 hours on a single charge

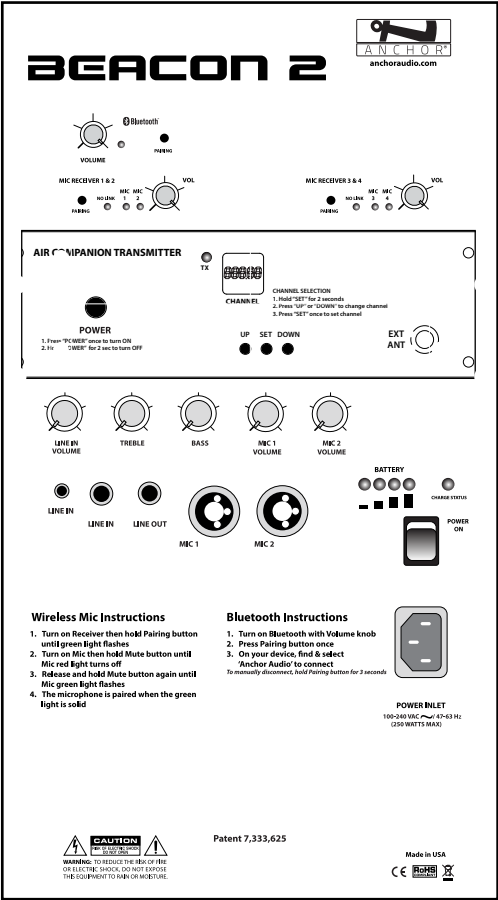

(BEA2-XU4 Back Panel)

Anchor AIR Technical Specifications	
AIR Frequency Range	902 - 928 MHz
AIR Wireless Range	300' + line of sight



(Features & Specifications Subject to Change Without Notice)



anchoraudio.com | 800.262.4671



Beacon 2 Models	
BEA2	Beacon with built-in Bluetooth
BEA2-U2	Beacon with built-in Bluetooth & dual wireless mic receiver
BEA2-U4	Beacon with built-in Bluetooth & two dual wireless mic receivers
BEA2-X	Beacon with built-in Bluetooth & AIR wireless transmitter
BEA2-XU2	Beacon with built-in Bluetooth, AIR wireless transmitter & dual wireless mic receiver
BEA2-XU4	Beacon with built-in Bluetooth, AIR wireless transmitter & two dual wireless mic receivers
BEA2-R	Beacon with built-in Bluetooth & AIR wireless receiver
BEA2-RU2	Beacon with built-in Bluetooth, AIR wireless receiver & dual wireless mic receiver
BEA2-RU4	Beacon with built-in Bluetooth, AIR wireless receiver & two dual wireless mic receivers
Microphones	
WH-LINK	Wireless handheld mic (1.9 GHz)
WB-LINK	Wireless belt pack transmitter (1.9 GHz)
HBM-LINK	Headband mic (3.5 mm plug)
CM-LINK	Collar mic (3.5 mm plug)
EM-LINK	UltraLite mic (3.5 mm plug)
LM-LINK	Lapel mic (3.5 mm plug)
MIC-90	Wired handheld mic with 20 ft. cable (XLR plug)
Technical Specifications	
Rated Power Output	150 watts AC/DC
Max SPL @ Rated Power	120 dB @ 1 meter
Frequency Response	60 Hz – 15 kHz ± 3 dB
Microphone Wireless Frequency	1.9 GHz DECT
Microphone Wireless Range	300' + line of sight
Mic Inputs	Lo-Z, balanced, XLR & 1/4" 34V DC condenser mic (phantom) power Hi-Z (10 KΩ), unbalanced, 1/4" phone
Line Inputs	Unbalanced 1/4" & 3.5 mm stereo
Line Output (post fader)	Isolated, 600Ω, 1/4" phone
AC Power Reqs.	100 – 240 VAC, 50/60 Hz, 250W max
Battery	Two 12V LFP rechargeable batteries, 7.5 AH
Dimensions Closed (HWD)	28" x 11" x 18.5" (71.1 x 28 x 47 cm)
Dimensions Opened (HWD)	71.5" x 11" x 18.5" (181.6 x 28 x 47 cm)
Weight	43 lbs / 19.5 Kg
Warranty	6 years
Sensitivity For Rated Output	
Lo-Z Microphone	-52 dBV (2.5 mVrms)
Hi-Z Microphone	-43 dBV (7.5 mVrms)
Auxiliary (line)	-14 dBV (200 mVrms)

TECH SPECS

- 117 dB of clear sound
- 125W AC mode / 100W DC mode
- 1.9 GHz wireless frequency
- Two universal mic inputs
- 1/4" & 3.5 mm AUX line input
- 1/4" line output
- Built-in rechargeable Lithium Ion batteries
- One 10" woofer
- One ceramic compression driver
- External speaker output powers optional Liberty 2 companion speaker

FEATURES

- Reaches crowds up to 1,500+
- Connect up to four wireless mics
- Anchor AIR compatible
- Built-in Class 1 Bluetooth
- Built-in rechargeable batteries operate 6 - 8 hours on a single charge

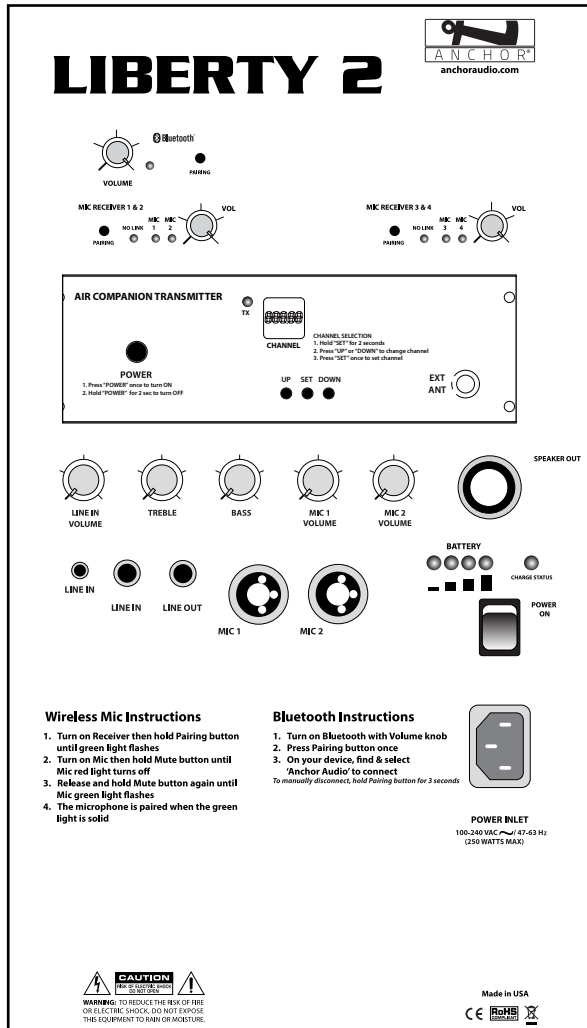

(LIB2-XU4 Back Panel)

LIB-AIR Technical Specifications

AIR Frequency Range	902 - 928 MHz
AIR Wireless Range	300' + line of sight
Speaker In	4-pole Neutrik Speakon® input



(Features & Specifications Subject to Change Without Notice)



anchoraudio.com | 800.262.4671



Liberty 2 Models

LIB2	Liberty with built-in Bluetooth
LIB2-U2	Liberty with built-in Bluetooth & dual wireless mic receiver
LIB2-U4	Liberty with built-in Bluetooth & two dual wireless mic receivers
LIB2-X	Liberty with built-in Bluetooth & AIR wireless transmitter
LIB2-XU2	Liberty with built-in Bluetooth, AIR wireless transmitter & dual wireless mic receiver
LIB2-XU4	Liberty with built-in Bluetooth, AIR wireless transmitter & two dual wireless mic receivers
LIB2-AIR	Liberty AIR wireless companion speaker
LIB2-COMP	Liberty unpowered wired companion speaker

Microphones

WH-LINK	Wireless handheld mic (1.9 GHz)
WB-LINK	Wireless belt pack transmitter (1.9 GHz)
HBM-LINK	Headband mic (3.5 mm plug)
CM-LINK	Collar mic (3.5 mm plug)
EM-LINK	UltraLite mic (3.5 mm plug)
LM-LINK	Lapel mic (3.5 mm plug)
MIC-90	Wired handheld mic with 20 ft. cable (XLR plug)

Technical Specifications

Rated Power Output	125 watts AC/DC
Max SPL @ Rated Power	117 dB @ 1 meter
Frequency Response	60 Hz - 15 kHz ± 3dB
Microphone Wireless Frequency	1.9 GHz DECT
Microphone Wireless Range	300' + line of sight
Line Output (post fader)	Isolated, 600Ω, 1/4" phone
Mic Inputs	Lo-Z, balanced, XLR & 1/4" 34V DC condenser mic (phantom) power Hi-Z (10 KΩ), unbalanced, 1/4" phone
Line Inputs	Unbalanced 1/4" & 3.5 mm stereo
Speaker Out	4-pole Neutrik Speakon® jack
AC Power Reqs.	100 - 240 VAC, 50/60 Hz, 250W max
Battery	Two 12V LFP rechargeable batteries, 7.5 AH
Dimensions (HWD)	23" x 14" x 11.5" (58.4 x 35.6 x 29.26 cm)
Weight	28 lbs / 12.7Kg
Warranty	6 years

Sensitivity For Rated Output

Lo-Z Microphone	-52 dBV (2.5 mVrms)
Hi-Z Microphone	-43 dBV (7.5 mVrms)
Auxiliary (line)	-14 dBV (200 mVrms)

TECH SPECS

- 109 dB of clear sound
- 75W AC mode / 50W DC mode
- 1.9 GHz wireless frequency
- Two universal microphone input jacks
- 1/4" & 3.5 mm AUX line input
- 1/4" line output
- Built-in rechargeable Lithium Ion batteries
- One high-output horn tweeter
- One 6.5" woven fiber woofer
- External speaker output powers optional Go Getter 2 companion speaker

FEATURES

- Reaches crowds of 500+
- Connect up to four wireless mics
- Anchor AIR compatible
- Built-in Class 1 Bluetooth
- Built-in rechargeable batteries operate 6 - 8 hours on a single charge

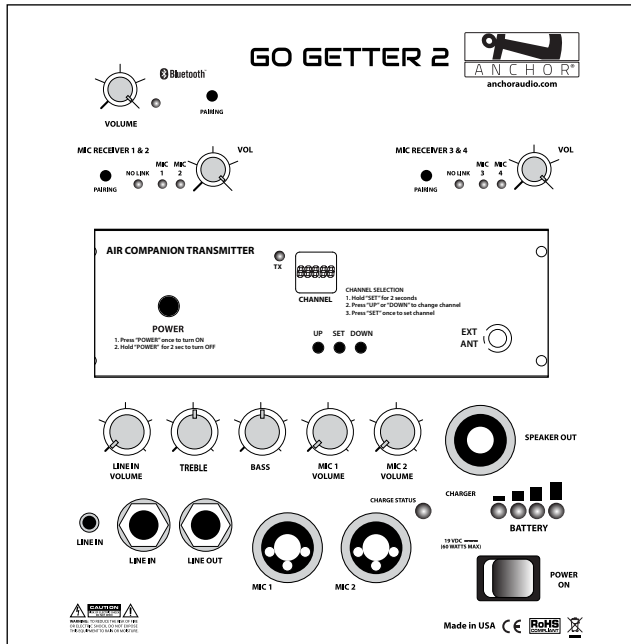

(GG2-XU4 Back Panel)

GG-AIR Technical Specifications	
AIR Frequency Range	902 - 928 MHz
AIR Wireless Range	300' + line of sight
Speaker In	4-pole Neutrik Speakon® input



(Features & Specifications Subject to Change Without Notice)



anchoraudio.com | 800.262.4671



Go Getter 2 Models	
GG2	Go Getter with built-in Bluetooth
GG2-U2	Go Getter with built-in Bluetooth & dual wireless mic receiver
GG2-U4	Go Getter with built-in Bluetooth & two dual wireless mic receivers
GG2-X	Go Getter with built-in Bluetooth & AIR transmitter
GG2-XU2	Go Getter with built-in Bluetooth, AIR transmitter & dual wireless mic receiver
GG2-XU4	Go Getter with built-in Bluetooth, AIR transmitter & two dual wireless mic receivers
GG2-AIR	Go Getter AIR wireless companion speaker
GG2-COMP	Go Getter unpowered wired companion speaker
Microphones	
WH-LINK	Wireless handheld mic (1.9 GHz)
WB-LINK	Wireless belt pack transmitter (1.9 GHz)
HBM-LINK	Headband mic (3.5 mm plug)
CM-LINK	Collar mic (3.5 mm plug)
EM-LINK	UltraLite mic (3.5 mm plug)
LM-LINK	Lapel mic (3.5 mm plug)
MIC-90	Wired handheld mic with 20 ft. cable (XLR plug)

Technical Specifications	
Rated Power Output	75 watts AC / 50 watts DC
Max SPL @ Rated Power	109 dB @ 1 meter
Frequency Response	50 Hz – 16 kHz ± 3 dB
Microphone Wireless Frequency	1.9 GHz DECT
Microphone Wireless Range	300' + line of sight
Mic Inputs	Lo-Z, balanced, XLR & 1/4" 12V DC condenser mic (phantom) power Hi-Z (10 KΩ), unbalanced, 1/4" phone
Line Inputs	Unbalanced 1/4" & 3.5 mm stereo
Line Output (post fader)	Isolated, 600Ω, 1/4" phone
Speaker Out	4-pole Neutrik Speakon® jack
DC Power	19 VDC, 60 watts max
Battery	One 12V LFP rechargeable battery, 7.5 AH
Dimensions (HWD)	18" x 11.5" x 9" (45.7 x 29.2 x 22.86 cm)
Weight	15 lbs / 6.7 Kg
Warranty	6 years

TECH SPECS

- 119 dB of clear sound
- 20W AC/DC mode
- 1.9 GHz wireless frequency
- 1/4" line input
- 1/4" line output
- Built-in rechargeable Lithium Ion battery
- High-efficiency re-entrant horn driver
- External speaker output powers optional MegaVox 2 companion speaker

FEATURES

- Reaches crowds of 1,000+
- Connect up to four wireless mics
- Anchor AIR compatible
- Built-in Class 1 Bluetooth
- Signal alert button
- Built-in rechargeable batteries operate 6 - 8 hours on a single charge

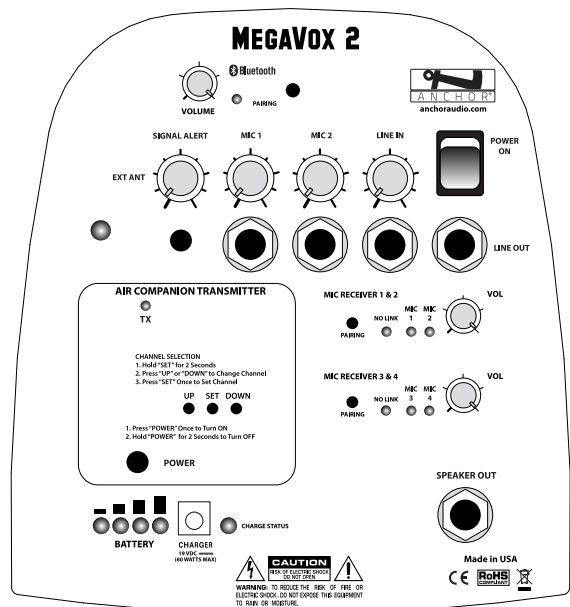

(MEGA2-XU4 Back Panel)

MEGA-AIR Technical Specifications

AIR Frequency Range	902 - 928 MHz
AIR Wireless Range	300' + line of sight
Speaker In	1/4" phone



(Features & Specifications Subject to Change Without Notice)



anchoraudio.com | 800.262.4671



MegaVox 2 Models

MEGA2	MegaVox with built-in Bluetooth
MEGA2-U2	MegaVox with built-in Bluetooth & dual wireless mic receiver
MEGA2-U4	MegaVox with built-in Bluetooth & two dual wireless mic receivers
MEGA2-X	MegaVox with built-in Bluetooth & AIR transmitter
MEGA2-XU2	MegaVox with built-in Bluetooth, AIR transmitter & dual wireless mic receiver
MEGA2-XU4	MegaVox with built-in Bluetooth, AIR transmitter & two dual wireless mic receivers
MEGA2-AIR	MegaVox AIR wireless companion speaker
MEGA2-COMP	MegaVox unpowered wired companion speaker

Microphones

WH-LINK	Wireless handheld mic (1.9 GHz)
WB-LINK	Wireless belt pack transmitter (1.9 GHz)
HBM-LINK	Headband mic (3.5mm plug)
CM-LINK	Collar mic (3.5mm plug)
EM-LINK	UltraLite mic (3.5mm plug)
LM-LINK	Lapel mic (3.5mm plug)
HBM-50	Wired headband mic (1/4" plug)
MIC-50	Wired handheld mic (1/4" plug)

Technical Specifications

Rated Power Output	20 watts AC/DC
Max SPL @ Rated Power	119 dB @ 1 meter
Frequency Response	400 Hz - 10 kHz ± 3 dB
Microphone Wireless Frequency	1.9 GHz DECT
Microphone Wireless Range	300' + line of sight
Battery	One 12V LFP rechargeable battery, 5.0 AH
Charger (RC-2)	19 VDC / universal input, (100Vac - 240Vac, 50 - 60 Hz)
Dimensions (HWD)	14" x 8.5" x 3" (35.6 x 21.6 x 33 cm)
Weight	13 lbs / 5.9 Kg
Warranty	6 years

Inputs

Line	Hi-Z, unbalanced, 1/4" phone
Wired Mic 1	Lo-Z, unbalanced, 1/4" phone
Wired Mic 2	Lo-Z, unbalanced, 1/4" phone

Outputs

Line (post fader)	Lo-Z, 1/4" phone
Speaker Out	4Ω, unswitched, 1/4" phone

MiniVox Lite / AN-MINI



MiniVox Lite

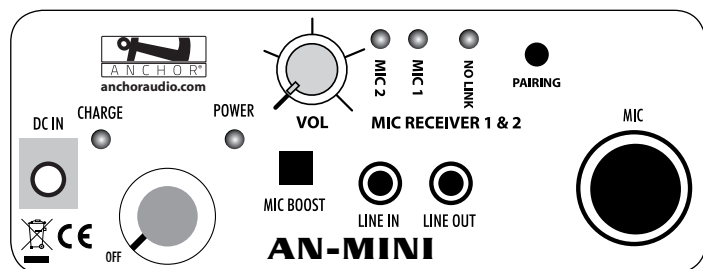

(AN-MINI2 Back Panel)

TECH SPECS

- 100 dB of clear sound
- 30W AC/DC mode
- 1.9 GHz wireless frequency
- 1/4" mic input
- 3.5 mm AUX line input
- Rechargeable AA alkaline batteries
- One 4.5" woofer

FEATURES

- Reaches crowds of 100+
- Connect up to two wireless mics
- Mic boost button
- Batteries operate 10 - 12 hours on a single charge
- Optional rechargeable battery kit

MiniVox Lite / AN-Mini Models

AN-MINI	Personal PA System (does not include RC-30)
AN-MINI2	AN-MINI with built-in dual wireless receiver (does not include RC-30)

MiniVox Lite / AN-Mini Packages

Lite-BP	<ul style="list-style-type: none"> - AN-MINI - Soft case (SOFT-MINI) - Wired handheld mic - 1/4" plug (MIC-50) - Battery recharge kit (RC-30)
Lite-DP	<ul style="list-style-type: none"> - AN-MINI2 with built-in dual wireless receiver - Soft case (SOFT-MINI) - Wired handheld mic - 1/4" plug (MIC-50) - Battery recharge kit (RC-30) - Choice of one wireless handheld mic or headband and lapel mic with belt pack
AN-MINIDP	<ul style="list-style-type: none"> - AN-MINI2 - Battery recharge kit (RC-30) - Choice of one wireless handheld mic or headband and lapel mic with belt pack

Microphones

WH-LINK	Wireless handheld mic (1.9 GHz)
WB-LINK	Wireless belt pack transmitter (1.9 GHz)
HBM-LINK	Headband mic (3.5 mm plug)
LM-LINK	Lapel mic (3.5 mm plug)
CM-LINK	Collar mic (3.5 mm plug)
EM-LINK	UltraLite mic (3.5 mm plug)
HBM-50	Wired headband mic (1/4" plug)
MIC-50	Wired handheld mic (1/4" plug)

Accessories

MINI-15ST	Stereo mini-plug cable - 15 ft.
SS-300	Speaker stand for AN-MINI, MiniVox Lite, and AN-30
SOFT-MINI	Soft case - AN-MINI
RC-30	Battery recharge kit for AN-MINI, MiniVox, and TourVox
AC-30	AN-MINI adapter

Technical Specifications

Rated Power Output	30 watts AC/DC
Max SPL @ Rated Power	100 dB @ 1 meter
Frequency Response	100 Hz - 15 kHz ± 3 dB
Microphone Wireless Frequency	1.9 GHz DECT
Microphone Wireless Range	150' + line of sight
Line Input	Line level, 3.5 mm
Microphone Input	Lo-Z, 1/4" phone
Line Output	Line level, 3.5 mm
Speaker Type	4.5" Neodymium woofer
Battery	Ten 'AA' alkaline
Dimensions (HWD)	5.5" x 5.5" x 6" (14 x 14 x 15.24 cm)
Weight	2.5 lbs / 1.13 Kg
Warranty	6 years
RC-30 - Battery Recharge Kit	
Battery Type	Ten 'AA' size, NiMH 2.5 Ah
AC-30 Input	120 VAC, 60 Hz
AC-30/220 Input	220 VAC, 50 Hz



anchoraudio.com | 800.262.4671



(Features & Specifications Subject to Change Without Notice)

ATHLETICS



anchoraudio.com

| 800.262.4671 |



BUYING GUIDE: Portable PA Systems for Athletics

Outdoor amplification systems make it easy for athletes and spectators to hear the coach, athletic director, and announcer no matter where they are on the field, in the gym, or in the stands. To ensure coaches and athletic directors purchase the best outdoor audio system, consider the following points.

QUESTIONS TO CONSIDER

- What is your budget?
- What is your typical audience size? How much space do you need to cover?
- Do you need a wireless microphone? How many? Distance of wireless range?
- What inputs and outputs do you need?
- Do you have easy access to a power source?
- Do you need any special features or accessories for their PA system?

Audience Size & Coverage

The audience size and coverage area will determine the size portable PA system you will need whether that is a full-size public address system or personal PA. These answers will also help to determine if multiple speakers are needed and how and where they are placed. Many full-size systems are a single, easy to move unit with the capability to be expandable with companion units. A personal PA system is usually small in size and often wearable.

Wireless Range & Applications

When choosing an outdoor amplification system, knowing the wireless range, capabilities, and applications you will need for your system is a critical piece of information. How large or small is the venue or facility? Are there any obstructions that would block or interfere with the wireless signal? What is the wireless range desired or needed for this particular space? The wireless range of an outdoor audio system will vary from product to product with some signals reaching up to 50 feet and others extending over 100 feet. How many wireless microphones do you need? Do you plan to wirelessly connect any devices such as mobile phone to the system? Understanding how the wireless will be used will help determine the appropriate wireless microphone choices.

Inputs/Outputs

Understanding how you intend to use the system in terms of devices and connections will determine what inputs and outputs are required. Requirements may include microphones, companion speakers, and other auxiliary sources such as a mobile device or MP3 player. Find a portable PA system that meets or exceeds these needs. The two most common connectors include XLR and 1/4".

Power Source

A PA system will operate on either AC (alternating current) power, DC (direct current) power, or both. AC units are powered using a wall outlet while DC units utilize a rechargeable battery. A rechargeable self contained public address system is completely portable and can therefore easily be transported around the school. Plus there are no messy cables to connect to a power source.

Portability

This feature comes into play not only with the power source but also in how easily you can move the system around the school. Factors to consider with portability include battery power, weight, carrying case accessories, and built-in features such as wheels or a handle.

Special Features & Accessories

Depending on how you will use the PA or sound system, there are a variety of special features and accessories to enhance your experience and performance such as wireless microphones, Bluetooth, media device players, wired or wireless companion speakers, carrying cases, speaker stands, and more.



anchoraudio.com | 800.262.4671



Start the Race Right using the Right PA System

Ensuring a fair start and sound clarity at track & field and cross country meets

Executive Summary

The Wisconsin Interscholastic Athletic Association (WIAA) was faced with the challenge to provide precise, clear, and loud voice amplification of instructions and starting commands for its track and cross country meets. The sound needed to reach the athletes, staff, and spectators alike. The Anchor Audio MegaVox Pro met all of these needs and more.

Challenges

- Clear and precise sound
- Loud, high quality sound for athletes and spectators to hear
- Portable and easy to transport

About Wisconsin Interscholastic Athletic Association (WIAA)

The Wisconsin Interscholastic Athletic Association (WIAA) is a voluntary, unincorporated, and nonprofit organization. It currently sponsors State Tournaments for 24 sports - one being track and field as well as cross country. The WIAA includes a diversified membership of both middle schools and high schools.

How the MegaVox Pro Helped WIAA



With previous experience using portable sound systems, the WIAA knew what they wanted and needed out of a newer and upgraded portable PA system. After seeing an Anchor Audio MegaVox in use at another event, they started their research. The range and quality of amplification plus the wireless and wired microphone options were appealing. Because the WIAA sponsors events all over the state of Wisconsin, portability was crucial. They found the MegaVox to be highly portable as well as offer directional sound. The signal alert button was also perfect for getting the attention of athletes and could be used at the start of a race. To help reach crowds of 1,000 or more, WIAA also purchased the MegaVox companion speaker for double the sound coverage.

Results & Review

The WIAA is very satisfied and couldn't be happier with the MegaVox portable PA system. In fact, they use the MegaVox at least 40 times a year... or more! The impressive performance of the MegaVox was noted by many other industry officials as well as athletic directors, so they began purchasing and using them, too. "The 6-year warranty, clear sound, ease of use and setup helped make our purchase decision even easier," said John Miller, WIAA Official. The WIAA has owned the MegaVox for over 10 years and applauds its reliability and also loves that the batteries can be easily replaced.

"We have used the MegaVox for many years at the Wisconsin (WIAA) State Track and Cross-Country Meets. Officials using these units were enthusiastic with their performance and dependability. The clarity of sound offered thousands of athletes to have a 'fair' start. Spectators also benefited from the quality of [the sound]."

- John Miller, WIAA Track/Cross-Country Official



anchoraudio.com | 800.262.4671



BLOG: There's No Competition for the Best Portable PA System - Anchor's the Winner

"Sport is not only a form of entertainment, but also – and above all I would say – a tool to communicate values that promote the good that is in humans and help build a more peaceful and fraternal society." – Pope Francis

Sports connect the public, unites nations, and brings people of all sorts together to compete and determine who is the best. Whether playing a friendly game of basketball on the court at recess or watching a competitive match between rivalry schools, sports bring people together.

Anchor Audio portable sound systems are the perfect solution to keep the event going in any environment. Athletes are full of high energy, discipline, and commitment, and they need a PA system that can keep up with all of these qualities. With durable, UV resistant enclosures, Anchor portable PA systems can stand both the dead of the winter and the heat of the summer. Both athletes and spectators should always be able to hear instruction, keep track of the score, and listen to music to pump them up. Whether indoor or outdoor, small or large, every Anchor sound system is completely portable, which means they are battery powered and can be easily transported anywhere.

Below are the school athletic activities that are perfect for your Anchor Audio portable sound system:

Tackle Football Season

Get the team pumped up for the big game or spread the excitement of the game play announcements with a portable PA system. Don't let a nonexistent or poor quality installed system hold you back. A single Bigfoot Line Array is designed to cover the whole football field from one end zone to the other. Join the NFL and Big Ten football teams that use it in the locker room and during practice and games. A portable PA system can be used for the team or for spectators for music and voice announcements.

Slide into Baseball Season

Whether it is a practice after school, a home game, or the school's annual baseball tournament, your Anchor Audio portable sound system is sure to be a home run at your next baseball game. Our systems are perfect for providing fun summer tunes and announcements during the game. You can place your sound system on the field for player communication, or near the stands for chanting encouragement. With an Anchor Audio sound system you will never strike out!

Kick your way into Soccer

If you need a PA system or sound system that can withstand the dirty cleats and bruises of soccer season, Anchor Audio is your answer. Round all of the teams up and choose a portable sound system that is ideal for wireless, outdoor amplification. Anchor Audio's sound systems are completely portable, requiring no wires or cords on the field, and are rugged and durable to withstand weather. Make sure your opening and closing ceremonies, group practices, activities, or games can be heard with across the wide array of spectators.

Keep up with the Sounds of Track & Field

The track & field and cross country trend continues to hold true across the US and is now even stretching into fitness competitions such as wrestling and crossfit. Quality sound equipment is especially important in any meet or race for announcing the start of the event to the music during the event, and the awards at the end of the event. The placement of portable sound systems throughout the event areas are essential in such large outdoor events.

Gear Up for the New School Year

When summer approaches, that means school is out! Time to rest, rejuvenate, and gear up for the new school year. Summer is a great time to get prepared for the coming Fall when all of the students return. Summer is the ideal time to reflect on the previous school year and assess what audio solutions you already have and what audio solutions need to be upgraded and/or purchased. Do you need new speaker monitors? How about a portable sound system for the gym, auditorium, or sports fields? When is the last time you upgraded your lectern? Although time should be set aside to enjoy summer, it is also a great opportunity to start preparing for another successful year of education and athletics.

With our free 30-day demo program, you can try Anchor Audio products for yourself before purchasing a portable sound system. Made in the USA, Anchor Audio products are backed by an industry leading six-year warranty and has same day shipping which means that you get your product fast. No back orders! We are happy to help you find the right Anchor Audio product for your audio needs!



anchoraudio.com | 800.262.4671



Customer Experiences & Reviews

Our customers say it best...



Sound Amplification at Track & Field Practice

Whitney DeWeese, a San Diego track & field coach, explains how she uses the Anchor Audio Beacon Line Array portable sound system for her track and field practices. She loves it! It's the perfect audio solution.

Link: https://youtu.be/AekX-_46sJM



Wireless Portable Speakers for the Outdoors

A San Diego mentoring program relies on Anchor Audio portable sound systems for outdoor events. The battery powered PA systems are perfect when they can't have power at an event.

Link: <https://youtu.be/KgcOfzFcnUg>

Bigfoot Line Array

"We were looking for a system that was easy to use, easy to transport, and loud enough for our multiple practice areas. We found that with the Bigfoot Sound System. We play music every day for practice and the simplicity of the Bigfoot has reduced the time and complexity of our set-up significantly. The sound quality is excellent, the simplicity is awesome, and best of all the coaches are happy! It's the best new addition to our practice set-up"

– Jordan Strickler, University of Texas Football

Beacon Line Array

"Last year, I found something I had to have while at a National Championship Track meet, The Anchor Audio Beacon system. Another starter brought this amazing system to the meet and I was immediately sold. . . and had to have one. It is compact, powerful, pure, and extremely impressive to not only us starters, but the athletes, fans, and coaches. As a USA Track and Field "Master Level" Starter, professionalism is paramount. To that end, the audio equipment I use also must be impeccable, professional, and state-of-the-art. That is why I use Anchor Audio sound systems. I now can present an even more professional image while being the best starter I can be. This is one incredible system. I would recommend it to anyone needing a great sound system for any athletic event needing amplification."

– USA Track and Field "Master Level" Starter, Chico, CA

Liberty Platinum

"This system has proven to provide excellent sound for the PA at Legion baseball games. Portability is excellent."

– Steven Johnson, Cambridge American Legion Post #199 Baseball Manager

MiniVox Lite

"The AN-Mini sound system saved my voice. As a teacher and coach, I often have to raise my voice above students working in groups or cheerleaders chanting and cheering. The sound system amplified my voice loud enough that students and cheerleaders could hear me right away and were able to get my directions loud and clear. During rallies, the cheerleaders were able to communicate with the crowd and each other using the AN-Mini sound system with less effort and greater success."

– Portola Middle School, Los Angeles, CA



anchoraudio.com | 800.262.4671





Features	Bigfoot 2	Beacon 2	Liberty 2	Go Getter 2	MegaVox 2	MiniVox Lite
Crowd Size	5,000+	2,500+	1,500+	500+	1,000+	100+
Max SPL	130 dB	120 dB	117 dB	109 dB	119 dB	100 dB
Power Output (Watts)	400W AC/DC mode	150W AC mode / 125W DC mode	125W AC mode / 100W DC mode	75W AC mode / 50W DC mode	20W AC/DC mode	30W AC/DC mode
Battery Life	6 - 8 hours	6 - 8 hours	6 - 8 hours	6 - 8 hours	6 - 8 hours	10 - 12 hours
Battery Type	Lithium Iron Phosphate Rechargeable	Lithium Iron Phosphate Rechargeable	Lithium Iron Phosphate Rechargeable	Lithium Iron Phosphate Rechargeable	Lithium Iron Phosphate Rechargeable	AA NIMH 2.5 Ah
Warranty	6 years	6 years	6 years	6 years	6 years	6 years
Country of Origin	USA	USA	USA	USA	USA	USA
Inputs & Outputs						
3.5 mm AUX Line In	X	X	X	X		X
XLR Mic Input	X	X	X	X		
1/4" Mic Input	X	X	X	X	X	X
1/4" Line In	X	X	X	X	X	
3.5 mm AUX Mic Input						X
1/4" Line Out	X	X	X	X	X	
Companion Speaker Out			X	X	X	
3.5 mm AUX Line Out						X
Advanced Features						
Ideal for Music	X	X	X	X		X
Ideal for Voice	X	X	X	X	X	X
Siren Alert Button					X	
Bluetooth	X	X	X	X	X	
Anchor AIR	X	X	X	X	X	
Up to Two Wireless Mics	X	X	X	X	X	X
Up to Four Wireless Mics	X	X	X	X	X	
CD/MP3 Player	X	X	X	X		



TECH SPECS

- 130 dB of clear sound
- 400W AC/DC mode
- 1.9 GHz wireless frequency
- Two universal microphone input jacks
- 1/4" & 3.5 mm AUX line input
- 1/4" line output
- Built-in rechargeable Lithium Ion batteries
- Five 8" neodymium woofers
- One neodymium compression driver

FEATURES

- Reaches crowds of 5,000+
- Connect up to four wireless mics
- Anchor AIR compatible
- Built-in Class 1 Bluetooth
- Onboard mic storage bag
- Heavy duty wheels for easy transport
- Built-in rechargeable batteries operate 6 - 8 hours on a single charge
- Designed to cover a football field or large auditorium

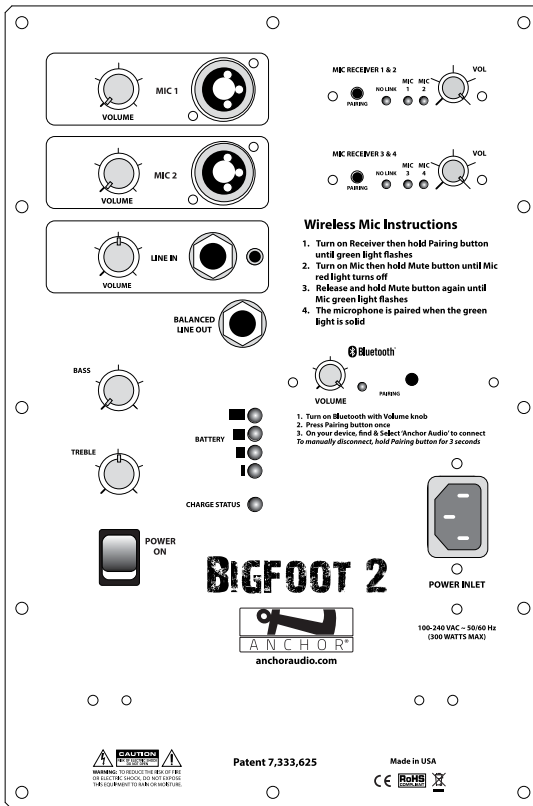
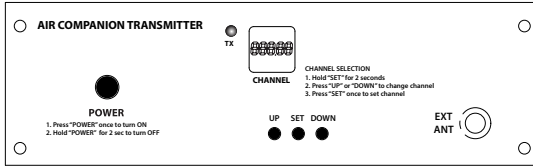

(BIG2-XU4 Back Panel)

Bigfoot 2 Models

BIG2	Bigfoot with built-in Bluetooth
BIG2-U2	Bigfoot with built-in Bluetooth & dual wireless mic receiver
BIG2-U4	Bigfoot with built-in Bluetooth & two dual wireless mic receivers
BIG2-X	Bigfoot with built-in Bluetooth & AIR wireless transmitter
BIG2-XU2	Bigfoot with built-in Bluetooth, AIR wireless transmitter & dual wireless mic receiver
BIG2-XU4	Bigfoot with built-in Bluetooth, AIR wireless transmitter & two dual wireless mic receivers
BIG2-R	Bigfoot with built-in Bluetooth & AIR wireless receiver
BIG2-RU2	Bigfoot with built-in Bluetooth, AIR wireless receiver & dual wireless mic receiver
BIG2-RU4	Bigfoot with built-in Bluetooth, AIR wireless receiver & two dual wireless mic receivers

Microphones

WH-LINK	Wireless handheld mic (1.9 GHz)
WB-LINK	Wireless belt pack transmitter (1.9 GHz)
HBM-LINK	Headband mic (3.5 mm plug)
CM-LINK	Collar mic (3.5 mm plug)
EM-LINK	UltraLite mic (3.5 mm plug)
LM-LINK	Lapel mic (3.5 mm plug)
MIC-90	Wired wandheld mic with 20 ft. cable (XLR plug)

Technical Specifications

Rated Power Output	400 watts AC/DC
Max SPL @ Rated Power	130 dB @ 1 meter
Frequency Response	100 Hz - 15 kHz ± 3 dB
Microphone Wireless Frequency	1.9 GHz DECT
Microphone Wireless Range	300'+ line of sight
Mic Inputs	Lo-Z, balanced, XLR & 1/4" 34V DC condenser mic (phantom) power Hi-Z (10 KΩ), unbalanced, 1/4" phone
Line Inputs	Unbalanced 1/4" & 3.5 mm stereo
Line Output (post fader)	Isolated, 600Ω, 1/4" phone
AC Power Reqs.	100 - 240 VAC, 50/60 Hz, 300W max
Battery	Three 12V LFP rechargeable batteries, 7.5 AH
Dimensions Closed (HWD)	42.5" x 14" x 23" (108 x 38.9 x 61 cm)
Dimensions Opened (HWD)	68.5" x 14" x 23" (174 x 38.9 x 61 cm)
Weight	63.5 lbs / 28.8 Kg
Warranty	6 years

Sensitivity For Rated Output

Lo-Z Microphone	-52 dBV (2.5 mVrms)
Hi-Z Microphone	-43 dBV (7.5 mVrms)
Auxiliary (line)	-14 dBV (200 mVrms)

Anchor AIR Technical Specifications

AIR Frequency Range	902 - 928 MHz
AIR Wireless Range	300'+ line of sight



(Features & Specifications Subject to Change Without Notice)



anchoraudio.com | 800.262.4671



TECH SPECS

- 120 dB of clear sound
- 150W AC mode / 125W DC mode
- 1.9 GHz wireless frequency
- Two universal microphone input jacks
- 1/4" & 3.5 mm AUX line input
- 1/4" line output
- Built-in rechargeable Lithium Ion batteries
- Lightweight array tower has eight 4" neodymium speakers
- Base has three 8" neodymium subwoofers

FEATURES

- Reaches crowds of 2,500+
- Connect up to four wireless mics
- Anchor AIR compatible
- Built-in Class 1 Bluetooth
- Nylon mic storage bag
- Durable wheels for easy transport
- Built-in rechargeable batteries operate 6 - 8 hours on a single charge

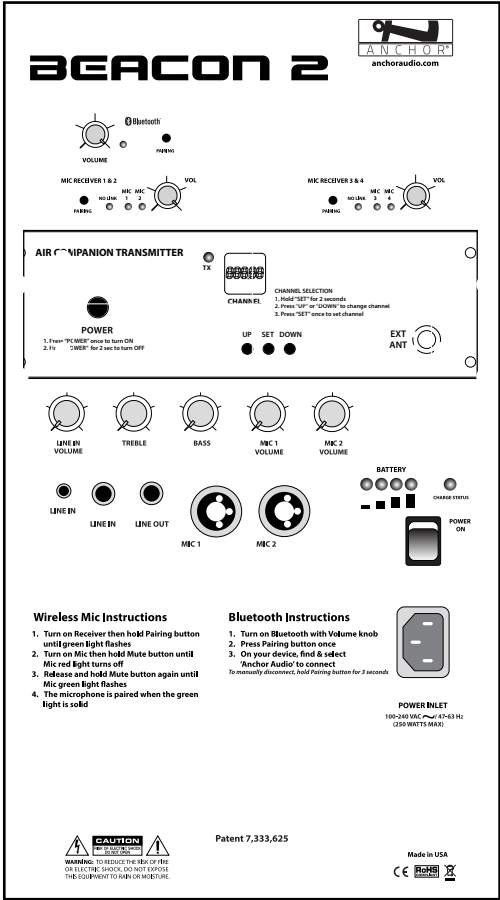

(BEA2-XU4 Back Panel)

Anchor AIR Technical Specifications	
AIR Frequency Range	902 - 928 MHz
AIR Wireless Range	300' + line of sight



(Features & Specifications Subject to Change Without Notice)

Beacon 2 Models	
BEA2	Beacon with built-in Bluetooth
BEA2-U2	Beacon with built-in Bluetooth & dual wireless mic receiver
BEA2-U4	Beacon with built-in Bluetooth & two dual wireless mic receivers
BEA2-X	Beacon with built-in Bluetooth & AIR wireless transmitter
BEA2-XU2	Beacon with built-in Bluetooth, AIR wireless transmitter & dual wireless mic receiver
BEA2-XU4	Beacon with built-in Bluetooth, AIR wireless transmitter & two dual wireless mic receivers
BEA2-R	Beacon with built-in Bluetooth & AIR wireless receiver
BEA2-RU2	Beacon with built-in Bluetooth, AIR wireless receiver & dual wireless mic receiver
BEA2-RU4	Beacon with built-in Bluetooth, AIR wireless receiver & two dual wireless mic receivers

Microphones	
WH-LINK	Wireless handheld mic (1.9 GHz)
WB-LINK	Wireless belt pack transmitter (1.9 GHz)
HBM-LINK	Headband mic (3.5 mm plug)
CM-LINK	Collar mic (3.5 mm plug)
EM-LINK	UltraLite mic (3.5 mm plug)
LM-LINK	Lapel mic (3.5 mm plug)
MIC-90	Wired handheld mic with 20 ft. cable (XLR plug)

Technical Specifications	
Rated Power Output	150 watts AC/DC
Max SPL @ Rated Power	120 dB @ 1 meter
Frequency Response	60 Hz – 15 kHz ± 3 dB
Microphone Wireless Frequency	1.9 GHz DECT
Microphone Wireless Range	300' + line of sight
Mic Inputs	Lo-Z, balanced, XLR & 1/4" 34V DC condenser mic (phantom) power Hi-Z (10 KΩ), unbalanced, 1/4" phone
Line Inputs	Unbalanced 1/4" & 3.5 mm stereo
Line Output (post fader)	Isolated, 600Ω, 1/4" phone
AC Power Reqs.	100 – 240 VAC, 50/60 Hz, 250W max
Battery	Two 12V LFP rechargeable batteries, 7.5 AH
Dimensions Closed (HWD)	28" x 11" x 18.5" (71.1 x 28 x 47 cm)
Dimensions Opened (HWD)	71.5" x 11" x 18.5" (181.6 x 28 x 47 cm)
Weight	43 lbs / 19.5 Kg
Warranty	6 years
Sensitivity For Rated Output	
Lo-Z Microphone	-52 dBV (2.5 mVrms)
Hi-Z Microphone	-43 dBV (7.5 mVrms)
Auxiliary (line)	-14 dBV (200 mVrms)



TECH SPECS

- 117 dB of clear sound
- 125W AC mode / 100W DC mode
- 1.9 GHz wireless frequency
- Two universal mic inputs
- 1/4" & 3.5 mm AUX line input
- 1/4" line output
- Built-in rechargeable Lithium Ion batteries
- One 10" woofer
- One ceramic compression driver
- External speaker output powers optional Liberty 2 companion speaker

FEATURES

- Reaches crowds up to 1,500+
- Connect up to four wireless mics
- Anchor AIR compatible
- Built-in Class 1 Bluetooth
- Built-in rechargeable batteries operate 6 - 8 hours on a single charge

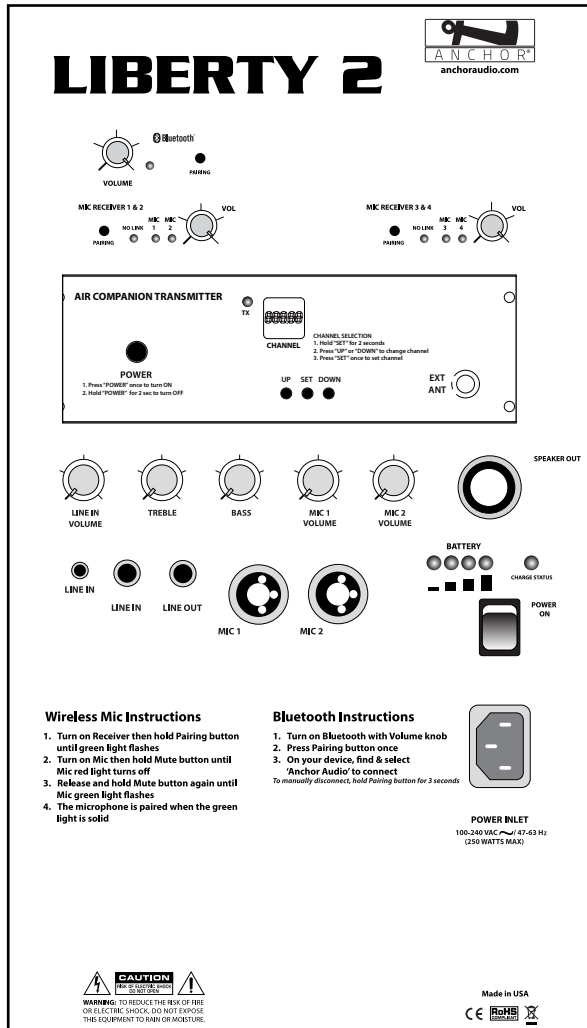

(LIB2-XU4 Back Panel)

LIB-AIR Technical Specifications

AIR Frequency Range	902 - 928 MHz
AIR Wireless Range	300' + line of sight
Speaker In	4-pole Neutrik Speakon® input



(Features & Specifications Subject to Change Without Notice)



anchoraudio.com | 800.262.4671



Liberty 2 Models

LIB2	Liberty with built-in Bluetooth
LIB2-U2	Liberty with built-in Bluetooth & dual wireless mic receiver
LIB2-U4	Liberty with built-in Bluetooth & two dual wireless mic receivers
LIB2-X	Liberty with built-in Bluetooth & AIR wireless transmitter
LIB2-XU2	Liberty with built-in Bluetooth, AIR wireless transmitter & dual wireless mic receiver
LIB2-XU4	Liberty with built-in Bluetooth, AIR wireless transmitter & two dual wireless mic receivers
LIB2-AIR	Liberty AIR wireless companion speaker
LIB2-COMP	Liberty unpowered wired companion speaker

Microphones

WH-LINK	Wireless handheld mic (1.9 GHz)
WB-LINK	Wireless belt pack transmitter (1.9 GHz)
HBM-LINK	Headband mic (3.5 mm plug)
CM-LINK	Collar mic (3.5 mm plug)
EM-LINK	UltraLite mic (3.5 mm plug)
LM-LINK	Lapel mic (3.5 mm plug)
MIC-90	Wired handheld mic with 20 ft. cable (XLR plug)

Technical Specifications

Rated Power Output	125 watts AC/DC
Max SPL @ Rated Power	117 dB @ 1 meter
Frequency Response	60 Hz - 15 kHz ± 3dB
Microphone Wireless Frequency	1.9 GHz DECT
Microphone Wireless Range	300' + line of sight
Line Output (post fader)	Isolated, 600Ω, 1/4" phone
Mic Inputs	Lo-Z, balanced, XLR & 1/4" 34V DC condenser mic (phantom) power Hi-Z (10 KΩ), unbalanced, 1/4" phone
Line Inputs	Unbalanced 1/4" & 3.5 mm stereo
Speaker Out	4-pole Neutrik Speakon® jack
AC Power Reqs.	100 - 240 VAC, 50/60 Hz, 250W max
Battery	Two 12V LFP rechargeable batteries, 7.5 AH
Dimensions (HWD)	23" x 14" x 11.5" (58.4 x 35.6 x 29.26 cm)
Weight	28 lbs / 12.7Kg
Warranty	6 years

Sensitivity For Rated Output

Lo-Z Microphone	-52 dBV (2.5 mVrms)
Hi-Z Microphone	-43 dBV (7.5 mVrms)
Auxiliary (line)	-14 dBV (200 mVrms)

TECH SPECS

- 109 dB of clear sound
- 75W AC mode / 50W DC mode
- 1.9 GHz wireless frequency
- Two universal microphone input jacks
- 1/4" & 3.5 mm AUX line input
- 1/4" line output
- Built-in rechargeable Lithium Ion batteries
- One high-output horn tweeter
- One 6.5" woven fiber woofer
- External speaker output powers optional Go Getter 2 companion speaker

FEATURES

- Reaches crowds of 500+
- Connect up to four wireless mics
- Anchor AIR compatible
- Built-in Class 1 Bluetooth
- Built-in rechargeable batteries operate 6 - 8 hours on a single charge

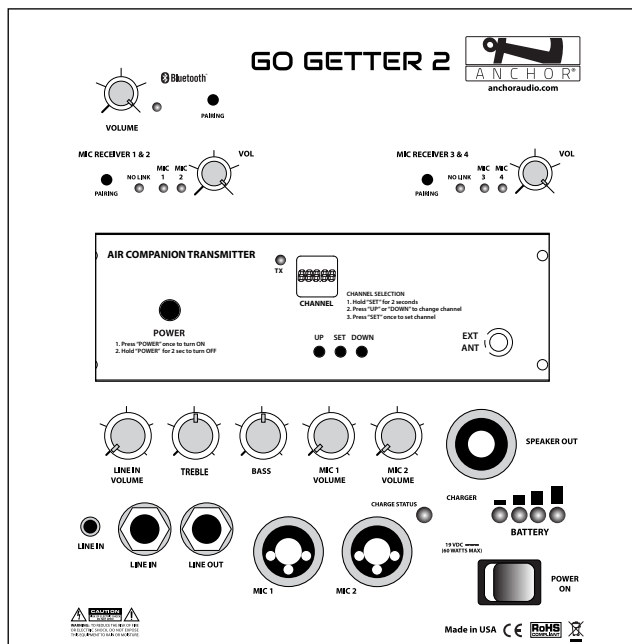

(GG2-XU4 Back Panel)

GG-AIR Technical Specifications	
AIR Frequency Range	902 - 928 MHz
AIR Wireless Range	300' + line of sight
Speaker In	4-pole Neutrik Speakon® input



(Features & Specifications Subject to Change Without Notice)



anchoraudio.com | 800.262.4671



Go Getter 2 Models	
GG2	Go Getter with built-in Bluetooth
GG2-U2	Go Getter with built-in Bluetooth & dual wireless mic receiver
GG2-U4	Go Getter with built-in Bluetooth & two dual wireless mic receivers
GG2-X	Go Getter with built-in Bluetooth & AIR transmitter
GG2-XU2	Go Getter with built-in Bluetooth, AIR transmitter & dual wireless mic receiver
GG2-XU4	Go Getter with built-in Bluetooth, AIR transmitter & two dual wireless mic receivers
GG2-AIR	Go Getter AIR wireless companion speaker
GG2-COMP	Go Getter unpowered wired companion speaker
Microphones	
WH-LINK	Wireless handheld mic (1.9 GHz)
WB-LINK	Wireless belt pack transmitter (1.9 GHz)
HBM-LINK	Headband mic (3.5 mm plug)
CM-LINK	Collar mic (3.5 mm plug)
EM-LINK	UltraLite mic (3.5 mm plug)
LM-LINK	Lapel mic (3.5 mm plug)
MIC-90	Wired handheld mic with 20 ft. cable (XLR plug)

Technical Specifications	
Rated Power Output	75 watts AC / 50 watts DC
Max SPL @ Rated Power	109 dB @ 1 meter
Frequency Response	50 Hz – 16 kHz ± 3 dB
Microphone Wireless Frequency	1.9 GHz DECT
Microphone Wireless Range	300' + line of sight
Mic Inputs	Lo-Z, balanced, XLR & 1/4" 12V DC condenser mic (phantom) power Hi-Z (10 KΩ), unbalanced, 1/4" phone
Line Inputs	Unbalanced 1/4" & 3.5 mm stereo
Line Output (post fader)	Isolated, 600Ω, 1/4" phone
Speaker Out	4-pole Neutrik Speakon® jack
DC Power	19 VDC, 60 watts max
Battery	One 12V LFP rechargeable battery, 7.5 AH
Dimensions (HWD)	18" x 11.5" x 9" (45.7 x 29.2 x 22.86 cm)
Weight	15 lbs / 6.7 Kg
Warranty	6 years

TECH SPECS

- 119 dB of clear sound
- 20W AC/DC mode
- 1.9 GHz wireless frequency
- 1/4" line input
- 1/4" line output
- Built-in rechargeable Lithium Ion battery
- High-efficiency re-entrant horn driver
- External speaker output powers optional MegaVox 2 companion speaker

FEATURES

- Reaches crowds of 1,000+
- Connect up to four wireless mics
- Anchor AIR compatible
- Built-in Class 1 Bluetooth
- Signal alert button
- Built-in rechargeable batteries operate 6 - 8 hours on a single charge

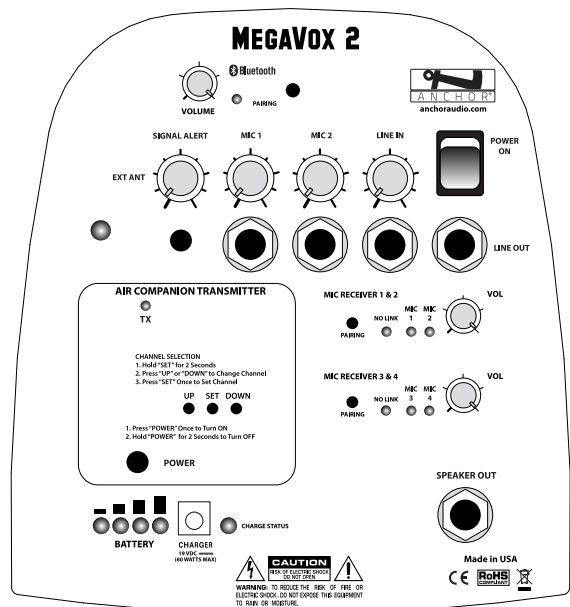

(MEGA2-XU4 Back Panel)

MEGA-AIR Technical Specifications

AIR Frequency Range	902 - 928 MHz
AIR Wireless Range	300' + line of sight
Speaker In	1/4" phone



(Features & Specifications Subject to Change Without Notice)



anchoraudio.com | 800.262.4671



MegaVox 2 Models

MEGA2	MegaVox with built-in Bluetooth
MEGA2-U2	MegaVox with built-in Bluetooth & dual wireless mic receiver
MEGA2-U4	MegaVox with built-in Bluetooth & two dual wireless mic receivers
MEGA2-X	MegaVox with built-in Bluetooth & AIR transmitter
MEGA2-XU2	MegaVox with built-in Bluetooth, AIR transmitter & dual wireless mic receiver
MEGA2-XU4	MegaVox with built-in Bluetooth, AIR transmitter & two dual wireless mic receivers
MEGA2-AIR	MegaVox AIR wireless companion speaker
MEGA2-COMP	MegaVox unpowered wired companion speaker

Microphones

WH-LINK	Wireless handheld mic (1.9 GHz)
WB-LINK	Wireless belt pack transmitter (1.9 GHz)
HBM-LINK	Headband mic (3.5mm plug)
CM-LINK	Collar mic (3.5mm plug)
EM-LINK	UltraLite mic (3.5mm plug)
LM-LINK	Lapel mic (3.5mm plug)
HBM-50	Wired headband mic (1/4" plug)
MIC-50	Wired handheld mic (1/4" plug)

Technical Specifications

Rated Power Output	20 watts AC/DC
Max SPL @ Rated Power	119 dB @ 1 meter
Frequency Response	400 Hz - 10 kHz ± 3 dB
Microphone Wireless Frequency	1.9 GHz DECT
Microphone Wireless Range	300' + line of sight
Battery	One 12V LFP rechargeable battery, 5.0 AH
Charger (RC-2)	19 VDC / universal input, (100Vac - 240Vac, 50 - 60 Hz)
Dimensions (HWD)	14" x 8.5" x 3" (35.6 x 21.6 x 33 cm)
Weight	13 lbs / 5.9 Kg
Warranty	6 years

Inputs

Line	Hi-Z, unbalanced, 1/4" phone
Wired Mic 1	Lo-Z, unbalanced, 1/4" phone
Wired Mic 2	Lo-Z, unbalanced, 1/4" phone

Outputs

Line (post fader)	Lo-Z, 1/4" phone
Speaker Out	4Ω, unswitched, 1/4" phone

MiniVox Lite / AN-MINI



MiniVox Lite

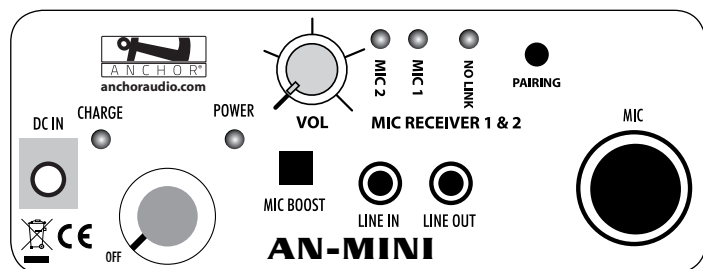

(AN-MINI2 Back Panel)

TECH SPECS

- 100 dB of clear sound
- 30W AC/DC mode
- 1.9 GHz wireless frequency
- 1/4" mic input
- 3.5 mm AUX line input
- Rechargeable AA alkaline batteries
- One 4.5" woofer

FEATURES

- Reaches crowds of 100+
- Connect up to two wireless mics
- Mic boost button
- Batteries operate 10 - 12 hours on a single charge
- Optional rechargeable battery kit

MiniVox Lite / AN-Mini Models

AN-MINI	Personal PA System (does not include RC-30)
AN-MINI2	AN-MINI with built-in dual wireless receiver (does not include RC-30)

MiniVox Lite / AN-Mini Packages

Lite-BP	<ul style="list-style-type: none"> - AN-MINI - Soft case (SOFT-MINI) - Wired handheld mic - 1/4" plug (MIC-50) - Battery recharge kit (RC-30)
Lite-DP	<ul style="list-style-type: none"> - AN-MINI2 with built-in dual wireless receiver - Soft case (SOFT-MINI) - Wired handheld mic - 1/4" plug (MIC-50) - Battery recharge kit (RC-30) - Choice of one wireless handheld mic or headband and lapel mic with belt pack
AN-MINIDP	<ul style="list-style-type: none"> - AN-MINI2 - Battery recharge kit (RC-30) - Choice of one wireless handheld mic or headband and lapel mic with belt pack

Microphones

WH-LINK	Wireless handheld mic (1.9 GHz)
WB-LINK	Wireless belt pack transmitter (1.9 GHz)
HBM-LINK	Headband mic (3.5 mm plug)
LM-LINK	Lapel mic (3.5 mm plug)
CM-LINK	Collar mic (3.5 mm plug)
EM-LINK	UltraLite mic (3.5 mm plug)
HBM-50	Wired headband mic (1/4" plug)
MIC-50	Wired handheld mic (1/4" plug)

Accessories

MINI-15ST	Stereo mini-plug cable - 15 ft.
SS-300	Speaker stand for AN-MINI, MiniVox Lite, and AN-30
SOFT-MINI	Soft case - AN-MINI
RC-30	Battery recharge kit for AN-MINI, MiniVox, and TourVox
AC-30	AN-MINI adapter

Technical Specifications

Rated Power Output	30 watts AC/DC
Max SPL @ Rated Power	100 dB @ 1 meter
Frequency Response	100 Hz - 15 kHz ± 3 dB
Microphone Wireless Frequency	1.9 GHz DECT
Microphone Wireless Range	150' + line of sight
Line Input	Line level, 3.5 mm
Microphone Input	Lo-Z, 1/4" phone
Line Output	Line level, 3.5 mm
Speaker Type	4.5" Neodymium woofer
Battery	Ten 'AA' alkaline
Dimensions (HWD)	5.5" x 5.5" x 6" (14 x 14 x 15.24 cm)
Weight	2.5 lbs / 1.13 Kg
Warranty	6 years
RC-30 - Battery Recharge Kit	
Battery Type	Ten 'AA' size, NiMH 2.5 Ah
AC-30 Input	120 VAC, 60 Hz
AC-30/220 Input	220 VAC, 50 Hz



anchoraudio.com | 800.262.4671



(Features & Specifications Subject to Change Without Notice)

MARCHING BAND & PAGEANTRY



anchoraudio.com

| 800.262.4671 |



BUYING GUIDE: Portable PA Systems for Marching Band & Pageantry

Outdoor amplification systems make it easy for students to hear the director no matter where they are on the field, in the band room, or in the gym. Band directors like them because they help to reduce vocal strain as well as allow for easy voice instruction and metronome amplification. To ensure band directors purchase the best outdoor audio system, consider the following points.

QUESTIONS TO CONSIDER

- What is your budget?
- Will the system be used for music only, voice only, or music and voice together?
- Do you need a wireless microphone? How many? How do you plan to use the wireless?
- What inputs and outputs do you need?
- Is there easy access to a power source?
- Do you need any features or accessories for their PA system?

Music or Voice

Knowing how you plan to utilize the PA system will help narrow down the style of speaker. For example, if the system is only needed for voice amplification then a horn driven speaker, such as the Anchor Audio MegaVox, is the ideal solution. However, if you need it for music or music and voice, then a speaker with high fidelity and a full range of sound, such as the Anchor Audio Liberty, is a perfect match.

Wireless Applications

When choosing an outdoor amplification system, knowing the wireless capabilities and applications you will need for your system is a critical piece of information. How many wireless microphones do you need? Do you plan to wirelessly connect a Dr. Beat or other metronome device? Understanding how the wireless will be used will help determine the appropriate wireless microphone choices, too.

Inputs and Outputs

Understanding how you intend to use the system in terms of devices and connections will determine what inputs and outputs are required. Requirements may include microphones, companion speakers, and other auxiliary sources such as a metronome or mobile device. Find a portable PA system that meets or exceeds these needs. The two most common connectors include XLR and 1/4".

Power Source

A PA system will operate on either AC (alternating current) power, DC (direct current) power, or both. AC units are powered using a wall outlet while DC units utilize a rechargeable battery power. A rechargeable public address system is completely portable and can therefore easily be transported around the school plus there are no messy cables to connect to a power source.

Portability

This feature comes into play not only with the power source but also in how easily you can move the system around the school. Factors to consider with portability include battery power, weight, carrying case accessories, and built-in features such as wheels or a handle.

Special Features & Accessories

Depending on how you will use the PA or sound system, there are a variety of special features and accessories to enhance your experience and performance such as wireless microphones, Bluetooth, media device players, wired or wireless companion speakers, carrying cases, speaker stands, and more.



anchoraudio.com | 800.262.4671



Improve Efficiency & Performance at Practice



Keep Everyone Marching to the Same Beat with a Portable PA System



Executive Summary

Tuscarora High School, a public high school in Leesburg, Virginia, found itself in need of a voice amplification system when on the football field during marching band practice. All band directors know the voice vs. instrument struggle – it's time for band practice, you're out on the field, you have to dictate instructions to your ensemble, but they can't hear you over the sound of practice – no matter how loud you yell. While a public address system is not necessarily required to hold a marching band practice or rehearsal, it certainly makes it a lot easier on both the band director and the ensemble.

The Importance of Voice Amplification During Marching Band Practice

With any live show, it is necessary to display precision and skill during every performance. The struggle of using an inadequate or hand-me-down PA system can make band practice much more difficult when it should be fun and productive. Marching bands practice on football fields, most often leaving both instructors and students struggling with voice amplification and hearing the instruction over the beat of the metronome and the instruments themselves. Spending long days and nights on the field practicing songs over and over again and running back and forth from one side to another to instruct different groups of the band is not a desired task by anyone. Let's face it, your voice can't compete with a tuba.

Challenges

- Hear from across the football field
- Loud, high quality sound for effective instruction

How the MegaVox Pro Helped Tuscarora High School

The Tuscarora High School Band found its voice amplification solution in Anchor Audio's MegaVox Pro portable PA system. It is battery powered, so there was no need to run cables across the football field to power it. Plus, with 119 dB of clear sound, the MegaVox impressively carries sound up to 300 feet (100 yards) away. With built-in Bluetooth, the band director and coach can easily and wirelessly connect the Dr. Beat to keep everyone - marching band and pageantry - on tempo during practice. Anchor Audio's MegaVox Pro continues to accommodate all of Tuscarora High School marching band and pageantry's wants and needs.

Results & Review

Tuscarora High School Band was impressed by the Anchor's 6-year warranty, as well as the fact that all of their products are made in the USA, so they know that they can depend on the quality and durability of their MegaVox to stand the test of time and being transported and roughed up by high school students and staff. With Anchor Audio's MegaVox Pro portable PA system, Tuscarora High School and all of their band members were able to effortlessly hear direction and critique from their band director allowing the students the opportunity to evolve and become better and better throughout each one of their practices.

"Without the MegaVox, there is a high chance our band director would have lost her voice more than once trying to yell from one side of the field to the other. We are extremely satisfied with the Anchor Audio MegaVox. It has been a great addition to the band, worked extremely well for our program, and has helped us improve greatly over the past couple years.

The MegaVox system is doing everything we want and need and more!"

- Annika Pracher, Head of Fundraising at Tuscarora High School Band



anchoraudio.com | 800.262.4671



BLOG: Metronomes, Marching Bands, and MegaVoxs... Oh My!

Why the MegaVox is the Perfect Portable PA System for Marching Bands

Something as simple as using a metronome during rehearsal and amplifying voice instruction during practice can eliminate confusion and increase the efficiency of band practice. While each marching band may have different goals and desires for their ensembles, they all have one thing in common – the need for a quality public address (PA) system.

One of the biggest problems marching bands come across when searching for PA and/or sound systems is finding a system that can be heard clearly and concisely over the powerful jingles and crashes of their instruments.

Southridge High School Marching Band from Beaverton, Oregon uses a Dr. Beat metronome (model DB-90) and connects it to their MegaVox using a 6000-18PS cable. “Every rehearsal, we warm up with it. On the field, we plug it into an Anchor MegaVox, hold it behind the drum line, and travel with it,” says director Todd Zimbelman.

The MegaVox is known by many band directors as the most durable PA system available to marching bands and other ensemble groups. Because it is battery powered, completely wireless, and designed to be portable, the MegaVox allows you eliminate dangerous cords running across the field or gymnasium floor. The MegaVox can be stand mounted or carried with a convenient shoulder strap. Outfitted with a powerful re-entrant horn driven speaker, the MegaVox system is ideal for voice amplification and allows band directors to hold the attention of their ensemble over long distances.

“The MegaVox has totally revamped the way we run rehearsals. Gone are the days of sticks and gock blocks. By using the MegaVox, we are able to wirelessly connect both our Dr. Beat, as well as the headset mic, so I can run a metronome while continuing to give feedback to our students.” – Peter Manzi, Director of Bands, Carlsbad High School.

Built-in Bluetooth allows you to wirelessly connect your Dr. Beat or other metronome, while still having the ability to project and amplify voice instruction. This enables you to play a metronome to keep the ensemble together while also amplifying clear instruction at the same time.

If one MegaVox isn't enough for your ensemble, a wireless battery powered companion speaker (MegaVox AIR) is available, which allows for the ability to sync with an unlimited number of companion speakers - doubling, tripling, or even quadrupling your sound across the field or marching area.

“As a high school director who has used multiple different products, I can't think of one better than the MegaVox system and headset mic that goes with it. The MegaVox allows me to free up my hands and have one on one contact with my students. Everybody can hear all of the time.

The efficiency and amount we can get done has improved so much because of this product. I am forever sold on it.” – Peter Manzi, Director of Bands, Carlsbad High School.



If you need the efficiency and effectiveness for your marching band to improve immensely and never want to wonder if people from one side of the field to the other can hear, choose the Anchor Audio MegaVox portable PA system for your marching band.

Like all of Anchor Audio's portable sound systems, the MegaVox Pro PA system is manufactured in the USA, ships same day, and is backed by an industry-leading six-year warranty.



anchoraudio.com | 800.262.4671



Customer Experiences & Reviews

Our customers say it best...



Director of Bands Explains the Benefits of a Voice Amplification System at Practice

Carlsbad High School Director of Bands, Peter Manzi, tells us how much the MegaVox has revamped and totally changed practice. Their efficiency and effectiveness has improved immensely due to the Anchor Audio MegaVox portable PA.

Link: <https://youtu.be/I9OY5DEV7x0>



How to Connect Your MegaVox to a Metronome

Did you know that you can connect your Anchor Audio MegaVox Pro portable PA system to a metronome THREE different ways?! We'll show you how in this quick video.

Link: <https://youtu.be/VzPNp8MdTzA>



Marching Band & Pageantry Using the MegaVox with a Metronome

West Salem High School Marching Band is shown rehearsing while using the Anchor Audio MegaVox Pro PA system. They have attached a metronome to the speaker and are using it to help the drum line march to the beat. You can hear the MegaVox loud and clear.

Link: <https://youtu.be/halqee12HWA>



Marching to the Same Beat with the MegaVox and a Metronome

The marching band and pageantry rehearse with a metronome connected to a MegaVox portable PA system to ensure everyone is marching to the same beat. It can easily be heard across the field.

Link: <https://youtu.be/zpo11nhD7kw>



anchoraudio.com | 800.262.4671



Customer Experiences & Reviews

Our customers say it best...

Bigfoot Line Array

"We use the Bigfoot Portable Sound System on the football field for all of our marching band rehearsals. By far this is the best product I have used in my 21 years of teaching. We have 230 students in the ensemble – we have been looking for a sound system like this for outdoor use. The sound is clear and heard by every student. We also use the Bluetooth option with the system for our indoor rehearsals with the flag line and dance team. One student is responsible for taking Bigfoot back and forth to the field and setting it up – the system is very easy to use and we love it!"

– Brett Robinson, Director of Bands, Barron Collier High School

Beacon Line Array

"We ordered a [Beacon] for the Plant City High School Raider Regiment this summer and we love it! A friend of a staff member has one for his band program and has been using it for almost four years now. It's working as well as the first day he took it out of the box. We considered others but ultimately this one was the best option for us. It's durable and can withstand the requirements of a marching band. It can easily be transported by one student and doesn't require any cables or tripods. Setup time is a minute or less and is very simple. We can run our drill sets with music as well as play music during warm-up block. The 'voice over' music feature comes in handy! Also, the winter guard will be able to utilize it during the spring for rehearsals. It's a great tool for any band program. For us, this was a 'buy it once, buy it right' decision."

– Plant City High School Raider Regiment

"We just got one of your Beacon audio systems yesterday for our fall field show, and it's awesome!"

– Sacred Heart University Band/Guard/Strings, Fairfield, CT

MegaVox Pro

"Hail to the MegaVox! My staff and I do not know what we would do without this amplification system. Trying to talk to a marching band spread out on a 100 yard field is simple with the MegaVox. It allows you to sit in a press box to see the overall designs while still being able to communicate to the band members. It saves my voice and makes our rehearsals as efficient as possible. A great feature is the ability to connect a metronome to the MegaVox. When you are finished for the day, just recharge it and you're ready to go again. It does not require much maintenance, and we use the MegaVox all year round. It's a great public address sound system."

– Nogales High School

"The Solid Gold Sound of the UCLA Bruin Marching Band depends on Anchor Audio's amazing speakers for all of our rehearsals. We've used them outdoors even in freezing weather and rain. No other speaker system has been as reliable or had such a quality sound."

– University of California Los Angeles

"I'm a band director, and the MegaVox allows me to sit in the press box to see the overall designs while still being able to communicate to the band members. It saves my voice and makes our rehearsals as efficient as possible. Another great feature is the ability to connect a metronome to the MegaVox."

– Lafayette, Louisiana



anchoraudio.com | 800.262.4671



Marching Band & Pagaentry

Compare our solutions side by side



Features	Bigfoot 2	Beacon 2	Liberty 2	MegaVox 2	MiniVox Lite
Crowd Size	5,000+	2,500+	1,500+	1,000+	100+
Max SPL	130 dB	120 dB	117 dB	119 dB	100 dB
Power Output (Watts)	400W AC/DC mode	150W AC mode / 125W DC mode	125W AC mode / 100W DC mode	20W AC/DC mode	30W AC/DC mode
Battery Life	6 - 8 hours	6 - 8 hours	6 - 8 hours	6 - 8 hours	10 - 12 hours
Battery Type	Lithium Iron Phosphate Rechargeable	Lithium Iron Phosphate Rechargeable	Lithium Iron Phosphate Rechargeable	Lithium Iron Phosphate Rechargeable	AA NIMH 2.5 Ah
Warranty	6 years	6 years	6 years	6 years	6 years
Country of Origin	USA	USA	USA	USA	USA
Inputs & Outputs					
3.5 mm AUX Line In	X	X	X		X
XLR Mic Input	X	X	X		
1/4" Mic Input	X	X	X	X	X
1/4" Line In	X	X	X	X	
3.5 mm AUX Mic Input					X
1/4" Line Out	X	X	X	X	
Companion Speaker Out			X	X	
3.5 mm AUX Line Out					X
Advanced Features					
Ideal for Music	X	X	X		X
Ideal for Voice	X	X	X	X	X
Siren Alert Button				X	
Bluetooth	X	X	X	X	
Anchor AIR	X	X	X	X	
Up to Two Wireless Mics	X	X	X	X	X
Up to Four Wireless Mics	X	X	X	X	
CD/MP3 Player	X	X	X		



anchoraudio.com | 800.262.4671



TECH SPECS

- 130 dB of clear sound
- 400W AC/DC mode
- 1.9 GHz wireless frequency
- Two universal microphone input jacks
- 1/4" & 3.5 mm AUX line input
- 1/4" line output
- Built-in rechargeable Lithium Ion batteries
- Five 8" neodymium woofers
- One neodymium compression driver

FEATURES

- Reaches crowds of 5,000+
- Connect up to four wireless mics
- Anchor AIR compatible
- Built-in Class 1 Bluetooth
- Onboard mic storage bag
- Heavy duty wheels for easy transport
- Built-in rechargeable batteries operate 6 - 8 hours on a single charge
- Designed to cover a football field or large auditorium

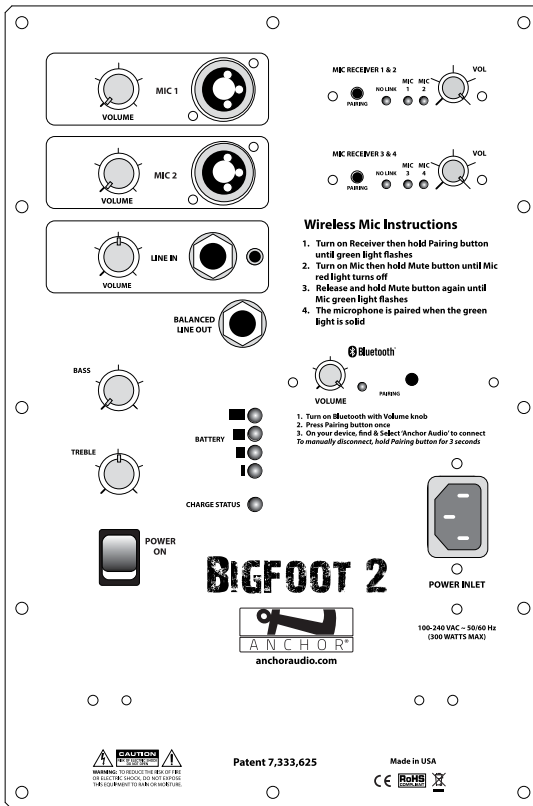
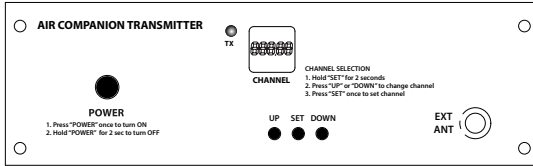

(BIG2-XU4 Back Panel)

Bigfoot 2 Models

BIG2	Bigfoot with built-in Bluetooth
BIG2-U2	Bigfoot with built-in Bluetooth & dual wireless mic receiver
BIG2-U4	Bigfoot with built-in Bluetooth & two dual wireless mic receivers
BIG2-X	Bigfoot with built-in Bluetooth & AIR wireless transmitter
BIG2-XU2	Bigfoot with built-in Bluetooth, AIR wireless transmitter & dual wireless mic receiver
BIG2-XU4	Bigfoot with built-in Bluetooth, AIR wireless transmitter & two dual wireless mic receivers
BIG2-R	Bigfoot with built-in Bluetooth & AIR wireless receiver
BIG2-RU2	Bigfoot with built-in Bluetooth, AIR wireless receiver & dual wireless mic receiver
BIG2-RU4	Bigfoot with built-in Bluetooth, AIR wireless receiver & two dual wireless mic receivers

Microphones

WH-LINK	Wireless handheld mic (1.9 GHz)
WB-LINK	Wireless belt pack transmitter (1.9 GHz)
HBM-LINK	Headband mic (3.5 mm plug)
CM-LINK	Collar mic (3.5 mm plug)
EM-LINK	UltraLite mic (3.5 mm plug)
LM-LINK	Lapel mic (3.5 mm plug)
MIC-90	Wired wandheld mic with 20 ft. cable (XLR plug)

Technical Specifications

Rated Power Output	400 watts AC/DC
Max SPL @ Rated Power	130 dB @ 1 meter
Frequency Response	100 Hz - 15 kHz ± 3 dB
Microphone Wireless Frequency	1.9 GHz DECT
Microphone Wireless Range	300'+ line of sight
Mic Inputs	Lo-Z, balanced, XLR & 1/4" 34V DC condenser mic (phantom) power Hi-Z (10 KΩ), unbalanced, 1/4" phone
Line Inputs	Unbalanced 1/4" & 3.5 mm stereo
Line Output (post fader)	Isolated, 600Ω, 1/4" phone
AC Power Reqs.	100 - 240 VAC, 50/60 Hz, 300W max
Battery	Three 12V LFP rechargeable batteries, 7.5 AH
Dimensions Closed (HWD)	42.5" x 14" x 23" (108 x 38.9 x 61 cm)
Dimensions Opened (HWD)	68.5" x 14" x 23" (174 x 38.9 x 61 cm)
Weight	63.5 lbs / 28.8 Kg
Warranty	6 years

Sensitivity For Rated Output

Lo-Z Microphone	-52 dBV (2.5 mVrms)
Hi-Z Microphone	-43 dBV (7.5 mVrms)
Auxiliary (line)	-14 dBV (200 mVrms)

Anchor AIR Technical Specifications

AIR Frequency Range	902 - 928 MHz
AIR Wireless Range	300'+ line of sight



(Features & Specifications Subject to Change Without Notice)



anchoraudio.com | 800.262.4671



TECH SPECS

- 120 dB of clear sound
- 150W AC mode / 125W DC mode
- 1.9 GHz wireless frequency
- Two universal microphone input jacks
- 1/4" & 3.5 mm AUX line input
- 1/4" line output
- Built-in rechargeable Lithium Ion batteries
- Lightweight array tower has eight 4" neodymium speakers
- Base has three 8" neodymium subwoofers

FEATURES

- Reaches crowds of 2,500+
- Connect up to four wireless mics
- Anchor AIR compatible
- Built-in Class 1 Bluetooth
- Nylon mic storage bag
- Durable wheels for easy transport
- Built-in rechargeable batteries operate 6 - 8 hours on a single charge

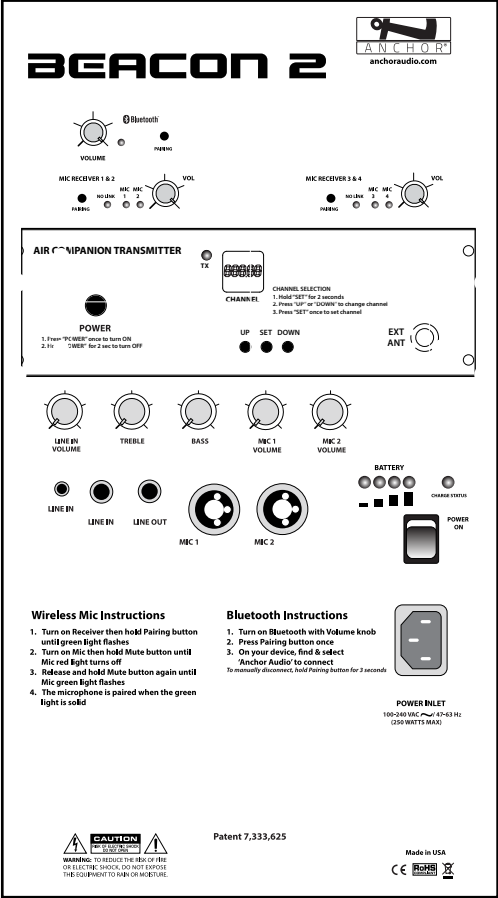

(BEA2-XU4 Back Panel)

Anchor AIR Technical Specifications	
AIR Frequency Range	902 - 928 MHz
AIR Wireless Range	300' + line of sight



(Features & Specifications Subject to Change Without Notice)

Beacon 2 Models	
BEA2	Beacon with built-in Bluetooth
BEA2-U2	Beacon with built-in Bluetooth & dual wireless mic receiver
BEA2-U4	Beacon with built-in Bluetooth & two dual wireless mic receivers
BEA2-X	Beacon with built-in Bluetooth & AIR wireless transmitter
BEA2-XU2	Beacon with built-in Bluetooth, AIR wireless transmitter & dual wireless mic receiver
BEA2-XU4	Beacon with built-in Bluetooth, AIR wireless transmitter & two dual wireless mic receivers
BEA2-R	Beacon with built-in Bluetooth & AIR wireless receiver
BEA2-RU2	Beacon with built-in Bluetooth, AIR wireless receiver & dual wireless mic receiver
BEA2-RU4	Beacon with built-in Bluetooth, AIR wireless receiver & two dual wireless mic receivers
Microphones	
WH-LINK	Wireless handheld mic (1.9 GHz)
WB-LINK	Wireless belt pack transmitter (1.9 GHz)
HBM-LINK	Headband mic (3.5 mm plug)
CM-LINK	Collar mic (3.5 mm plug)
EM-LINK	UltraLite mic (3.5 mm plug)
LM-LINK	Lapel mic (3.5 mm plug)
MIC-90	Wired handheld mic with 20 ft. cable (XLR plug)
Technical Specifications	
Rated Power Output	150 watts AC/DC
Max SPL @ Rated Power	120 dB @ 1 meter
Frequency Response	60 Hz – 15 kHz ± 3 dB
Microphone Wireless Frequency	1.9 GHz DECT
Microphone Wireless Range	300' + line of sight
Mic Inputs	Lo-Z, balanced, XLR & 1/4" 34V DC condenser mic (phantom) power Hi-Z (10 KΩ), unbalanced, 1/4" phone
Line Inputs	Unbalanced 1/4" & 3.5 mm stereo
Line Output (post fader)	Isolated, 600Ω, 1/4" phone
AC Power Reqs.	100 – 240 VAC, 50/60 Hz, 250W max
Battery	Two 12V LFP rechargeable batteries, 7.5 AH
Dimensions Closed (HWD)	28" x 11" x 18.5" (71.1 x 28 x 47 cm)
Dimensions Opened (HWD)	71.5" x 11" x 18.5" (181.6 x 28 x 47 cm)
Weight	43 lbs / 19.5 Kg
Warranty	6 years
Sensitivity For Rated Output	
Lo-Z Microphone	-52 dBV (2.5 mVrms)
Hi-Z Microphone	-43 dBV (7.5 mVrms)
Auxiliary (line)	-14 dBV (200 mVrms)



TECH SPECS

- 117 dB of clear sound
- 125W AC mode / 100W DC mode
- 1.9 GHz wireless frequency
- Two universal mic inputs
- 1/4" & 3.5 mm AUX line input
- 1/4" line output
- Built-in rechargeable Lithium Ion batteries
- One 10" woofer
- One ceramic compression driver
- External speaker output powers optional Liberty 2 companion speaker

FEATURES

- Reaches crowds up to 1,500+
- Connect up to four wireless mics
- Anchor AIR compatible
- Built-in Class 1 Bluetooth
- Built-in rechargeable batteries operate 6 - 8 hours on a single charge

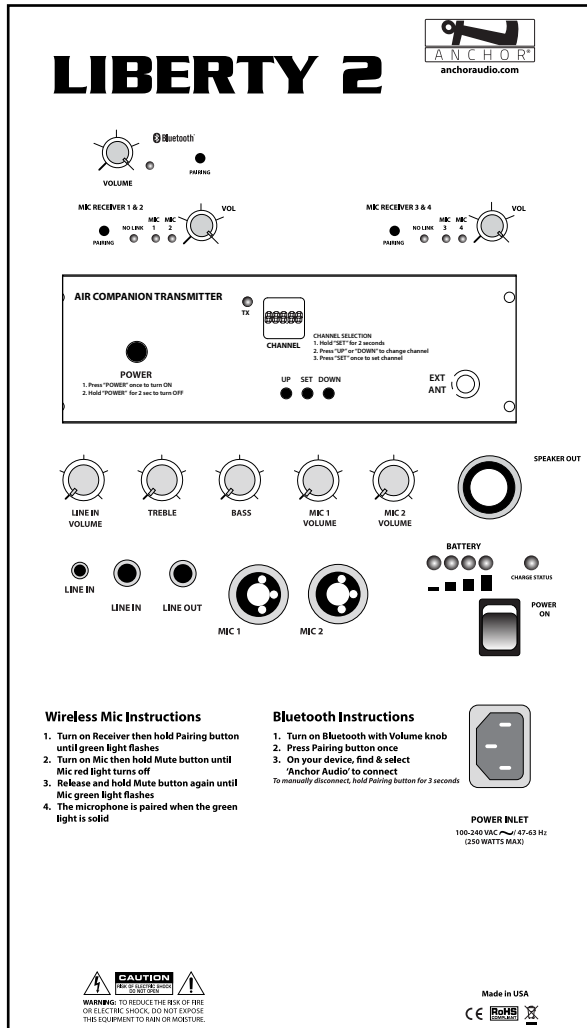

(LIB2-XU4 Back Panel)

LIB-AIR Technical Specifications

AIR Frequency Range	902 - 928 MHz
AIR Wireless Range	300' + line of sight
Speaker In	4-pole Neutrik Speakon® input



(Features & Specifications Subject to Change Without Notice)



anchoraudio.com | 800.262.4671



Liberty 2 Models

LIB2	Liberty with built-in Bluetooth
LIB2-U2	Liberty with built-in Bluetooth & dual wireless mic receiver
LIB2-U4	Liberty with built-in Bluetooth & two dual wireless mic receivers
LIB2-X	Liberty with built-in Bluetooth & AIR wireless transmitter
LIB2-XU2	Liberty with built-in Bluetooth, AIR wireless transmitter & dual wireless mic receiver
LIB2-XU4	Liberty with built-in Bluetooth, AIR wireless transmitter & two dual wireless mic receivers
LIB2-AIR	Liberty AIR wireless companion speaker
LIB2-COMP	Liberty unpowered wired companion speaker

Microphones

WH-LINK	Wireless handheld mic (1.9 GHz)
WB-LINK	Wireless belt pack transmitter (1.9 GHz)
HBM-LINK	Headband mic (3.5 mm plug)
CM-LINK	Collar mic (3.5 mm plug)
EM-LINK	UltraLite mic (3.5 mm plug)
LM-LINK	Lapel mic (3.5 mm plug)
MIC-90	Wired handheld mic with 20 ft. cable (XLR plug)

Technical Specifications

Rated Power Output	125 watts AC/DC
Max SPL @ Rated Power	117 dB @ 1 meter
Frequency Response	60 Hz - 15 kHz ± 3dB
Microphone Wireless Frequency	1.9 GHz DECT
Microphone Wireless Range	300' + line of sight
Line Output (post fader)	Isolated, 600Ω, 1/4" phone
Mic Inputs	Lo-Z, balanced, XLR & 1/4" 34V DC condenser mic (phantom) power Hi-Z (10 KΩ), unbalanced, 1/4" phone
Line Inputs	Unbalanced 1/4" & 3.5 mm stereo
Speaker Out	4-pole Neutrik Speakon® jack
AC Power Reqs.	100 - 240 VAC, 50/60 Hz, 250W max
Battery	Two 12V LFP rechargeable batteries, 7.5 AH
Dimensions (HWD)	23" x 14" x 11.5" (58.4 x 35.6 x 29.26 cm)
Weight	28 lbs / 12.7Kg
Warranty	6 years

Sensitivity For Rated Output

Lo-Z Microphone	-52 dBV (2.5 mVrms)
Hi-Z Microphone	-43 dBV (7.5 mVrms)
Auxiliary (line)	-14 dBV (200 mVrms)

TECH SPECS

- 119 dB of clear sound
- 20W AC/DC mode
- 1.9 GHz wireless frequency
- 1/4" line input
- 1/4" line output
- Built-in rechargeable Lithium Ion battery
- High-efficiency re-entrant horn driver
- External speaker output powers optional MegaVox 2 companion speaker

FEATURES

- Reaches crowds of 1,000+
- Connect up to four wireless mics
- Anchor AIR compatible
- Built-in Class 1 Bluetooth
- Signal alert button
- Built-in rechargeable batteries operate 6 - 8 hours on a single charge

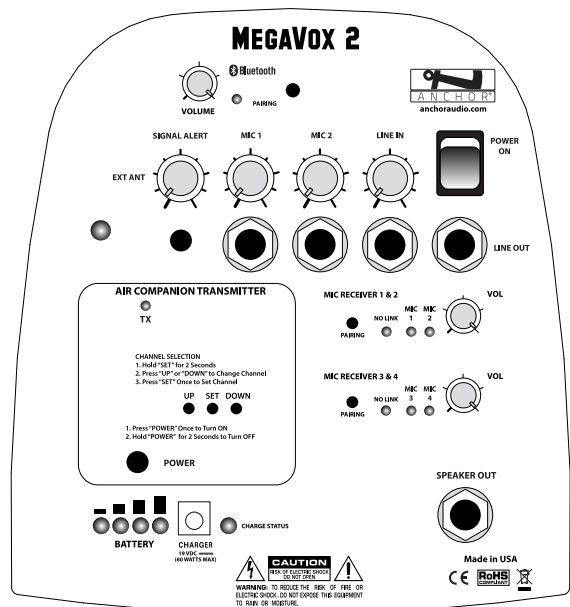

(MEGA2-XU4 Back Panel)

MEGA-AIR Technical Specifications

AIR Frequency Range	902 - 928 MHz
AIR Wireless Range	300' + line of sight
Speaker In	1/4" phone



(Features & Specifications Subject to Change Without Notice)



anchoraudio.com | 800.262.4671



MegaVox 2 Models

MEGA2	MegaVox with built-in Bluetooth
MEGA2-U2	MegaVox with built-in Bluetooth & dual wireless mic receiver
MEGA2-U4	MegaVox with built-in Bluetooth & two dual wireless mic receivers
MEGA2-X	MegaVox with built-in Bluetooth & AIR transmitter
MEGA2-XU2	MegaVox with built-in Bluetooth, AIR transmitter & dual wireless mic receiver
MEGA2-XU4	MegaVox with built-in Bluetooth, AIR transmitter & two dual wireless mic receivers
MEGA2-AIR	MegaVox AIR wireless companion speaker
MEGA2-COMP	MegaVox unpowered wired companion speaker

Microphones

WH-LINK	Wireless handheld mic (1.9 GHz)
WB-LINK	Wireless belt pack transmitter (1.9 GHz)
HBM-LINK	Headband mic (3.5mm plug)
CM-LINK	Collar mic (3.5mm plug)
EM-LINK	UltraLite mic (3.5mm plug)
LM-LINK	Lapel mic (3.5mm plug)
HBM-50	Wired headband mic (1/4" plug)
MIC-50	Wired handheld mic (1/4" plug)

Technical Specifications

Rated Power Output	20 watts AC/DC
Max SPL @ Rated Power	119 dB @ 1 meter
Frequency Response	400 Hz - 10 kHz ± 3 dB
Microphone Wireless Frequency	1.9 GHz DECT
Microphone Wireless Range	300' + line of sight
Battery	One 12V LFP rechargeable battery, 5.0 AH
Charger (RC-2)	19 VDC / universal input, (100Vac - 240Vac, 50 - 60 Hz)
Dimensions (HWD)	14" x 8.5" x 3" (35.6 x 21.6 x 33 cm)
Weight	13 lbs / 5.9 Kg
Warranty	6 years

Inputs

Line	Hi-Z, unbalanced, 1/4" phone
Wired Mic 1	Lo-Z, unbalanced, 1/4" phone
Wired Mic 2	Lo-Z, unbalanced, 1/4" phone

Outputs

Line (post fader)	Lo-Z, 1/4" phone
Speaker Out	4Ω, unswitched, 1/4" phone

MiniVox Lite / AN-MINI



MiniVox Lite

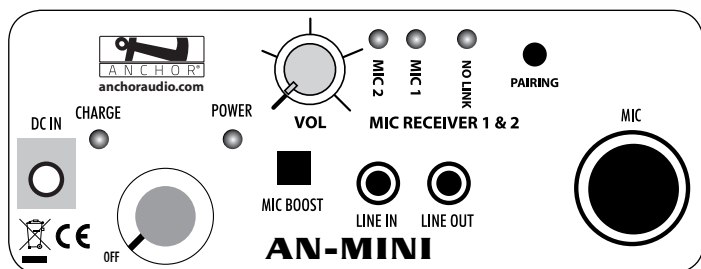

(AN-MINI2 Back Panel)

Technical Specifications

Rated Power Output	30 watts AC/DC
Max SPL @ Rated Power	100 dB @ 1 meter
Frequency Response	100 Hz – 15 kHz \pm 3 dB
Microphone Wireless Frequency	1.9 GHz DECT
Microphone Wireless Range	150' + line of sight
Line Input	Line level, 3.5 mm
Microphone Input	Lo-Z, 1/4" phone
Line Output	Line level, 3.5 mm
Speaker Type	4.5" Neodymium woofer
Battery	Ten 'AA' alkaline
Dimensions (HWD)	5.5" x 5.5" x 6" (14 x 14 x 15.24 cm)
Weight	2.5 lbs / 1.13 Kg
Warranty	6 years
RC-30 - Battery Recharge Kit	
Battery Type	Ten 'AA' size, NiMH 2.5 Ah
AC-30 Input	120 VAC, 60 Hz
AC-30/220 Input	220 VAC, 50 Hz

TECH SPECS

- 100 dB of clear sound
- 30W AC/DC mode
- 1.9 GHz wireless frequency
- 1/4" mic input
- 3.5 mm AUX line input
- Rechargeable AA alkaline batteries
- One 4.5" woofer

FEATURES

- Reaches crowds of 100+
- Connect up to two wireless mics
- Mic boost button
- Batteries operate 10 - 12 hours on a single charge
- Optional rechargeable battery kit

MiniVox Lite / AN-Mini Models

AN-MINI	Personal PA System (does not include RC-30)
AN-MINI2	AN-MINI with built-in dual wireless receiver (does not include RC-30)

MiniVox Lite / AN-Mini Packages

Lite-BP	<ul style="list-style-type: none">- AN-MINI- Soft case (SOFT-MINI)- Wired handheld mic - 1/4" plug (MIC-50)- Battery recharge kit (RC-30)
Lite-DP	<ul style="list-style-type: none">- AN-MINI2 with built-in dual wireless receiver- Soft case (SOFT-MINI)- Wired handheld mic - 1/4" plug (MIC-50)- Battery recharge kit (RC-30)- Choice of one wireless handheld mic or headband and lapel mic with belt pack
AN-MINIDP	<ul style="list-style-type: none">- AN-MINI2- Battery recharge kit (RC-30)- Choice of one wireless handheld mic or headband and lapel mic with belt pack

Microphones

WH-LINK	Wireless handheld mic (1.9 GHz)
WB-LINK	Wireless belt pack transmitter (1.9 GHz)
HBM-LINK	Headband mic (3.5 mm plug)
LM-LINK	Lapel mic (3.5 mm plug)
CM-LINK	Collar mic (3.5 mm plug)
EM-LINK	UltraLite mic (3.5 mm plug)
HBM-50	Wired headband mic (1/4" plug)
MIC-50	Wired handheld mic (1/4" plug)

Accessories

MINI-15ST	Stereo mini-plug cable - 15 ft.
SS-300	Speaker stand for AN-MINI, MiniVox Lite, and AN-30
SOFT-MINI	Soft case - AN-MINI
RC-30	Battery recharge kit for AN-MINI, MiniVox, and TourVox
AC-30	AN-MINI adapter



anchoraudio.com | 800.262.4671



(Features & Specifications Subject to Change Without Notice)



Conclusion

Thank you for downloading and reading our Ultimate Buyer's Guide: Audio Solutions for the Education Market. Emerging trends, technology, and budgets will continue to change, but we hope this guide helps you to better understand the various uses and applications a portable audio solution has for schools and universities. This knowledge will help in your process of finding the best audio solutions available.

We hope you use this as a tool going forward. However, when in doubt or if you have any questions or special requests, call or [email us](#), and we are happy to help!

Do you already own an Anchor Audio product and love it?

Share your story with us, so we can share it with the world. [Send us](#) your product review today!

Are you interested in partnering in a case study? In an effort to continually provide the most up to date information for you, we are always looking to partner with our customers in showcasing the offerings and solutions provided by Anchor Audio, as well as share their feedback, experience, and story. [Contact us](#) today to share your story.



anchoraudio.com | 800.262.4671

