

The background of the page is a technical drawing of a fuel system component, possibly a fuel pump or injector, shown in a cross-sectional or exploded view. The drawing is rendered in light blue and red lines on a white background. A large, faint "JD" logo is visible in the upper left corner. The title "FUEL LINES & FITTINGS" is centered over the drawing.

# FUEL LINES

---

## & FITTINGS

# FUEL LINE & FITTINGS

## CONTENTS

<b>NYLON FUEL LINES</b>	2-2
<b>COMPRESSION UNIONS</b>	
Nylon to Nylon	2-2
Nylon to Steel	2-2
360° Seal Unions	2-2
<b>FITTINGS</b>	
Splice Joiners	2-2
GM Fuel Sender Adapters	2-2
Viton O-Rings	2-2
<b>FUEL LINE ADAPTERS</b>	
	2-3
<b>STEEL REPAIR LINES</b>	
	2-3
<b>CLAMPS</b>	
Oetker360°	2-3
Fuel Injector	2-3
<b>CONNECTORS</b>	
Quick Disconnect—Straight	2-4
Quick Disconnect—90° Bend	2-4
<b>FUEL LINE RETAINER CLIPS</b>	
	2-4
<b>TOOLS</b>	
Quick Disconnect Retainer Removal Tool	2-4
Fuel Line Quick Assembly Tool	2-5
<b>ASSORTMENTS</b>	
	2-5

# FUEL LINES & FITTINGS

## FITTINGS

### Nylon Fuel Lines

Part No.	Tube	Length	Pkg Qty.
FL-14	1/4"	25'	1
FL-56	5/16"	25'	1
FL-38	3/8"	25'	1



### Compression Unions

Part No.	Thread Size	Pkg Qty.
<b>Nylon to Nylon</b>		
BR-62CNN	1/4"	2
BR-62DNN	5/16"	2
BR-62ENN	3/8"	2
<b>Nylon to Steel</b>		
BR-62CNS	1/4"	2
BR-62DNS	5/16"	2
BR-62ENS	3/8"	2



### 360° Seal Compression Unions

For Steel/Nylon/Copper/Aluminum Tubing

Part No.	Thread Size	Pkg Qty.
<b>Reducing</b>		
BR-2841	3/8" to 5/16"	2
BR-2842	10mm to 3/8"	2
<b>Straight</b>		
BR-2856	1/4"	2
BR-2857	5/16"	2
BR-2858	3/8"	2
<b>90° Elbow</b>		
BR-2846	5/16"	2
BR-2847	3/8"	2



### Splice Joiners

Part No.	Thread Size	Pkg Qty.
<b>For Nylon Fuel Line</b>		
BB-14	1/4"	5
BB-516	5/16"	5
BB-38	3/8"	5
<b>For Rubber Fuel Line</b>		
BFC-4	1/4"	5
BFC-5	5/16"	5
BFC-6	3/8"	5



### GM Fuel Sender Adapters

Part No.	Thread Size	Male Connection	Pkg Qty.
<b>To Rubber Fuel Line</b>			
FH-14	14mm	5/16"	5
FH-16	16mm	3/8"	5
<b>To Nylon Fuel Line</b>			
FS-14	14mm	5/16"	5
FS-16	16mm	3/8"	5



### Viton O-Rings

Part No.	Line Size	Pkg Qty.
OR-38	3/8"	10
OR-516	5/16"	10



# FUEL LINES & FITTINGS

## FUEL LINE ADAPTERS

### Quick Connector Fuel Line

Part No.	Female Connection	Male Connection	Pkg Qty.
<b>Quick Connect to Steel to Nylon</b>			
AL-101B	1/4"	1/4"	2
AL-102B	5/16"	5/16"	2
AL-103B	3/8"	3/8"	2
<b>GM to Nylon or Rubber</b>			
AL-104B	14mm	5/16"	2
AL-105B	16mm	3/8"	2
<b>Nylon or Rubber</b>			
AL-106B	5/16"	5/16"	2
AL-107B	3/8"	3/8"	2

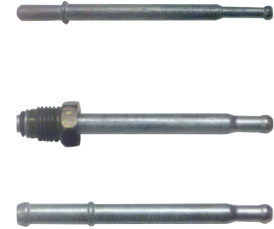

### Fuel Sending Unit Repair Line

Part No.	Line Size	Length	Pkg Qty.
<b>180° Fuel Filter Repair Line with 16mm GM Fitting</b>			
FL-6188B	3/8"	6-1/2"	2



### Steel Repair Lines

Part No.	Line Size	Length	Pkg Qty.
<b>14mm with Fitting &amp; O-Ring</b>			
FL-510B	5/16"	9"	2
FL-518B	5/16"	18"	2
FL-536B	5/16"	36"	2
<b>16mm with Fitting &amp; O-Ring</b>			
FL-610B	3/8"	9"	2
FL-618B	3/8"	18"	2
FL-636B	3/8"	36"	2



### Fuel Line Clamps

Part No.	Tube Size	Pkg Qty.
<b>Oetker360° for Nylon &amp; Rubber Hose</b>		
CSO-14	9/32"	10
CSO-56	3/8"	10
CSO-38	7/16"	10
<b>Fuel Injection Clamps</b>		
HCM-4F	1/4"	10
HCM-6F	5/16"	10
HCM-8F	3/8"	10



# FUEL LINES & FITTINGS

## CONNECTORS

Part No.	Female Connection	Male Connection	Pkg Qty.
<b>Straight - Quick Disconnect</b>			
TCS-58	5/16"	5/16"	2
TCS-68	3/8"	5/16"	2
TCS-510	5/16"	3/8"	2
TCS-610	3/8"	3/8"	2
<b>90° Bend - Quick Disconnect</b>			
TCB-58	5/16"	5/16"	2
TCB-68	3/8"	5/16"	2
TCB-510	5/16"	3/8"	2
TCB-610	3/8"	3/8"	2



## Steel & Nylon Quick Connector Fuel Line Retainer Clips



CL-102B



CL-103B



CL-104B



CL-105B

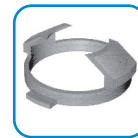

CL-106B



CL-110B



CL-120B



CL-121B

Part No.	Size	Description	Pkg Qty.
CL-102B	3/8"	GM, Chrysler, Ford	10
CL-103B	5/16"	GM, Chrysler, Ford	10
CL-104B	5/16"	Ford (White)	10
CL-105B	3/8"	Ford (Black)	10
CL-106B	1/4"	Ford	10
CL-110B	1/2"	Ford	10
CL-120B	5/16"	Ford (White)	10
CL-121B	3/8"	Ford (Black)	10

## QUICK DISCONNECT RETAINER REMOVAL TOOL

For 5/16" & 3/8"

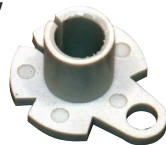

No. DT-1B

# FUEL LINES & FITTINGS

## DYNAMIC - FUEL LINE FITTINGS ASSORTMENT

**Dynamic Fuel Fittings Assortment contains all of the popular fittings needed to replace fuel line connectors on both steel and nylon line. Assortment includes quick connectors (straight and 90°), brass connectors, compression unions, clamps, O-rings, and connector removal tool.**

Each assortment comes in a durable plastic case that keeps all of the fittings organized and easy to find. The detailed lid insert identifies each fitting with a graphic reference and size. Reorder part numbers, quantities and UPC codes are also shown.

### Available Assortments:

See Automotive Service Parts Assortment Catalog for specific part numbers and quantities



### Fuel Line Repair Parts Assortment No. DY-FLA-2

Connectors, fitting and clamps for fuel line repair.

- 24 part numbers
- 86 total pieces