

BINZEL SERIES PUSH/PULL MIG/MAG TORCHES

(All pricing excludes GST)

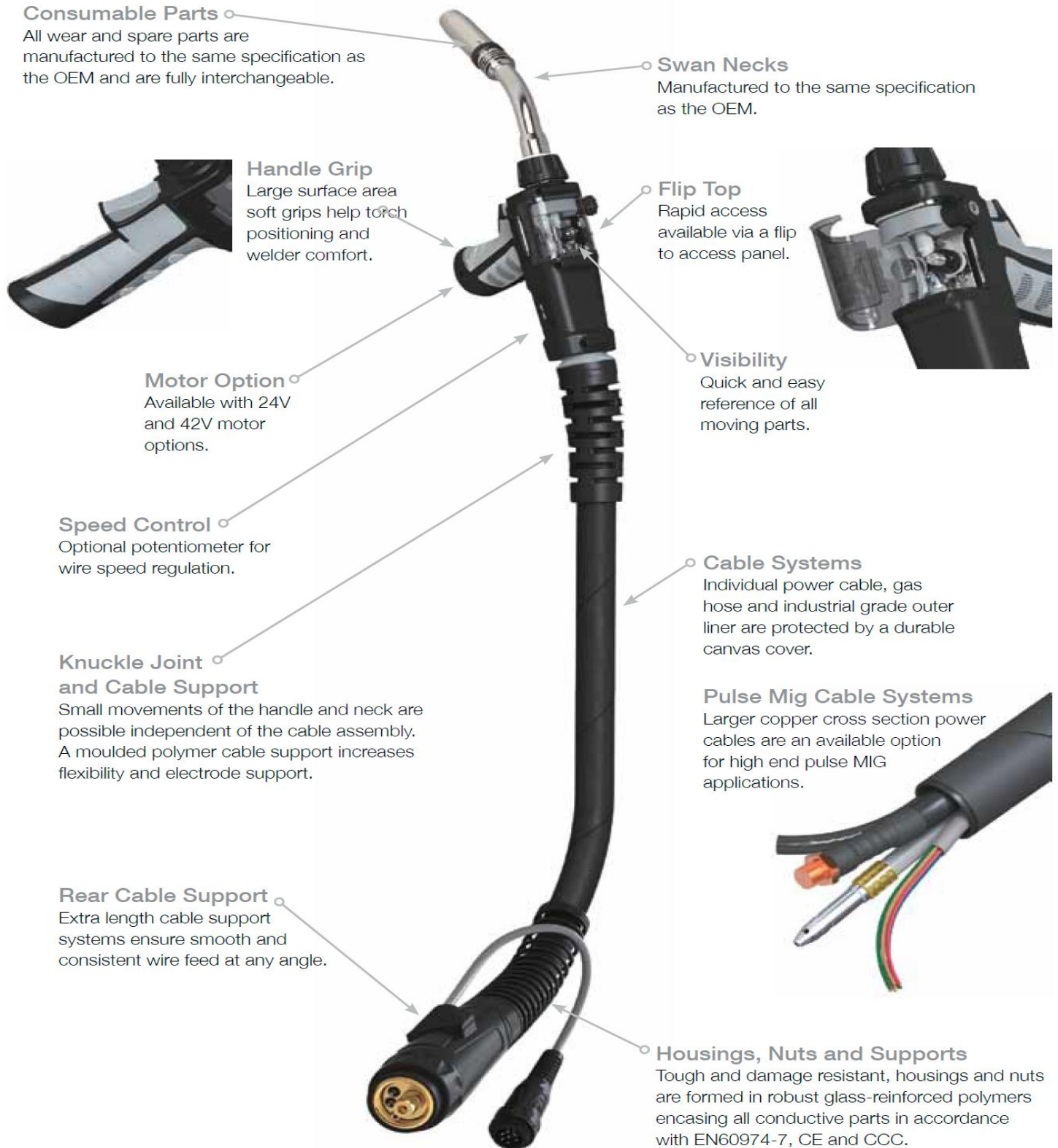

Consumable Parts

All wear and spare parts are manufactured to the same specification as the OEM and are fully interchangeable.

Swan Necks

Manufactured to the same specification as the OEM.

Handle Grip

Large surface area soft grips help torch positioning and welder comfort.

Flip Top

Rapid access available via a flip to access panel.

Motor Option

Available with 24V and 42V motor options.

Visibility

Quick and easy reference of all moving parts.

Speed Control

Optional potentiometer for wire speed regulation.

Cable Systems

Individual power cable, gas hose and industrial grade outer liner are protected by a durable canvas cover.

Knuckle Joint and Cable Support

Small movements of the handle and neck are possible independent of the cable assembly. A moulded polymer cable support increases flexibility and electrode support.

Pulse Mig Cable Systems

Larger copper cross section power cables are an available option for high end pulse MIG applications.

Rear Cable Support

Extra length cable support systems ensure smooth and consistent wire feed at any angle.

Housings, Nuts and Supports

Tough and damage resistant, housings and nuts are formed in robust glass-reinforced polymers encasing all conductive parts in accordance with EN60974-7, CE and CCC.

BINZEL SERIES PUSH/PULL MIG/MAG TORCHES

(All pricing excludes GST)

PP360 Torches

- Air Cooled • 300A Rated (CO2) • 270A Rated (Mixed Gas) • 60% Duty Cycle
- 0.8 – 1.2mm Wire • 24V and 42V Motor

CODE:	DESCRIPTION:	TRADE PRICE:
UPG360A-42MT	MIG/MAG Torch - 8m, Air Cooled	\$2495.00



PP401 Torches

- Water Cooled • 400A Rated (CO2) • 350A Rated (Mixed Gas) • 60% Duty Cycle • 1.0 – 1.6mm Wire
- 24V and 42V Motor • 1.2L/min Water Flow (min) • 2.0 Bar Water Inlet Pressure (min)
- 1600W Water Cooling Requirements (min) • 5.0 Bar Water Inlet Pressure (max) • 50° C Water Inlet Temperature

CODE:	DESCRIPTION:	TRADE PRICE:
UPG401-4L	MIG/MAG Torch - 8m, Water Cooled	\$2995.00

