

oliviaTM

THE TRAVEL COMPANY FOR LGBTQ+ WOMEN



BURGUNDY AND PROVENCE RIVERBOAT CRUISE II

JULY 27-AUGUST 3, 2021
on board *Avalon's Poetry II*

PARIS | BEAUNE |
ST. JEAN DE LOSNE |
SEURRE | MÂCON | LYON |
TOURNON/TAIN
L'HERMITAGE-VIVIERS |
AVIGNON | ARLES



Book early, as this trip sold out in the past!

Welcome to France! You'll arrive in Paris and then continue on by motorcoach to fascinating Beaune for an included visit of Hôtel-Dieu, or you may choose a complimentary wine-tasting tour. Next, board your ship in quaint St. Jean de Losne and set sail for lovely Mâcon, France's gastronomic capital of Lyon, as well as medieval Tournon, charming Viviers, Avignon, Arles and Port-Saint-Louis. Daylight permitting, sail into the peaceful Camargue area.

**Paris | Beaune | St. Jean de Losne | Seurre |
Mâcon | Lyon | Tournon/Tain l'Hermitage-Viviers |
Avignon | Arles**





ITINERARY SUMMARY

Tuesday, July 27, 2021

Wednesday, July 28, 2021

Thursday, July 29, 2021

Friday, July 30, 2021

Saturday, July 31, 2021

Sunday, August 1, 2021

Monday, August 2, 2021

Tuesday, August 3, 2021

Paris, Beaune, St. Jean de Losne (Embark), Seurre

Seurre and Mâcon

Lyon

Lyon

Tournon, Tain l'Hermitage, and Viviers

Avignon

Arles

Arles

**Please note: Itinerary is subject to change based on river level, traffic, and locks.*

INCLUDED

- Early morning transfer from host hotel in Paris to the ship in St. Jean de Losne on July 27, with a stop in Beaune with included tour (choice of wine tasting or the Hotel Dieu tour) (travel time is approx. 5 hours). Included sightseeing tours in Beaune, Macon, Lyon, Tournon, Viviers, Avignon and Arles
- Accommodations for 8 days/7 nights in Comfort Collection beds with Egyptian super-combed cotton linens on board Avalon's ms *Poetry II*
- All meals while on board, with a French cheese and French cuisine option each evening
- Champagne with breakfast; coffee, tea, and juice with all meals; wine from France's most famous wine regions, beer, and soft drinks with lunch and dinner; premium coffee, cappuccino, lattes, cocoa, and tea throughout the day; and filtered water to fill up your reusable water bottles
- Cookies and fresh fruit available throughout the day
- Wifi on board
- Bicycles and Nordic walking sticks loaned while docked
- Gratuities to ships staff, your tour guides and bus drivers
- Olivia's signature entertainment and programming
- Local entertainment, commentaries while cruising and historic talks by local expert and Avalon Cruise Director
- Group transfer from ship in Arles to Marseille airport on August 3 (for flights departing after 10:30 am)
- Olivia staff assistance throughout

NOT INCLUDED

Optional excursions (they do not conflict with included tours), wine tasting, alcoholic beverages, and soft drinks (except where indicated), laundry, phone/fax.



SHIP AMENITIES:

- Elegant, contemporary design
- Wall-to-wall panoramic windows
- Outside viewing deck and Sky Deck with premium lounge chairs and whirlpool
- Full buffet breakfast with sparkling wine and made-to-order egg station, as well as early- and late-riser breakfasts
- Room service for continental breakfast and beverages (service fee applies)
- Choice of lunch buffet with carving and pasta stations, al fresco lunch in the Sky Grill, or light lunch in the Panorama Lounge
- Choice of four-course dinner with choice of appetizers, soups, salads, entrées and desserts or cheese dinner in the Dining Room or delectable petite portions of regional specialties and wines in the Panorama Bistro
- Self-serve beverage station—with complimentary tea, hot chocolate, and premium coffees—and fresh fruit available throughout the day
- Choice of leisurely (gentle walkers), traditional, and independent sightseeing options
- Headsets for all guided shore excursions and sightseeing with certified local guides
- Nordic walking sticks and loaner bicycles to use while docked



The beautifully designed ship, the *Poetry II*, was built in 2014. Its staterooms (with high windows, just above the waterline) and suites (with wall-to-wall panoramic windows) are well-appointed and are among the largest on the river.

- Complimentary maps
- Onboard lectures, activities, and nightly entertainment—experiences with local chefs, entertainers, artisans, experts to bring the customs, cultures, and tastes of your destinations to life—and movie nights, as well as a behind-the-scenes ship tour
- Well-stocked library
- Sky Deck game area
- Expanded fitness center
- Water-Refill Station
- Complimentary computer use in public areas
- Complimentary wifi access
- Elevator
- Entirely nonsmoking interior
- Friendly, English-speaking crew
- Services of the Cruise Director to further personalize your cruise, including making recommendations and reservations

SKY DECK



ROYAL DECK

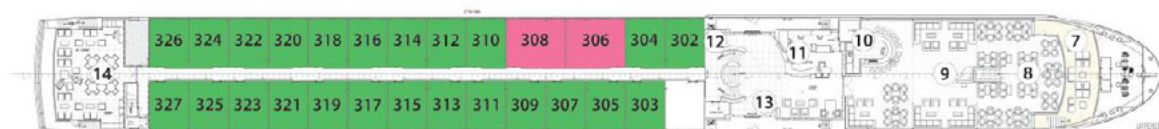

SAPPHIRE DECK

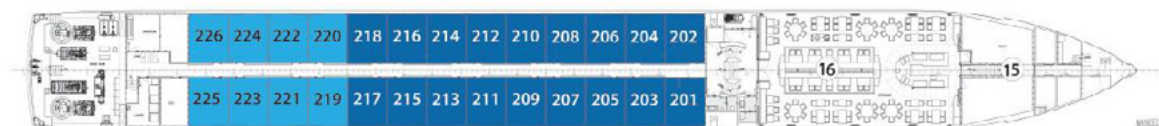

INDIGO DECK

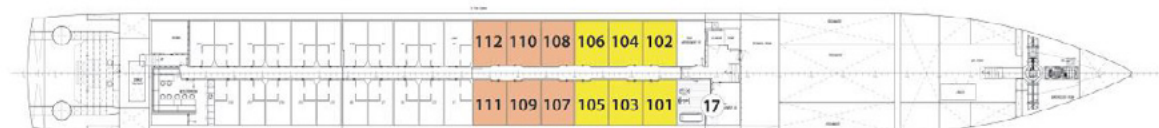

DECK PLAN

- | | | |
|--|----------------------|-------------------|
| 1 Sky Lounge | 6 Deck Game Area | 12 Elevator |
| 2 Navigation Bridge | 7 Observation Lounge | 13 Lobby |
| 3 Sky Grill | 8 Panorama Bistro | 14 Club Lounge |
| 4 Whirlpool | 9 Panorama Lounge | 15 Galley |
| 5 Premium Lounge
Chairs and Shade
Awings | 10 Bar | 16 Dining Room |
| | 11 Reception | 17 Fitness Center |

CATEGORIES

- | | |
|--------------------|---|
| Royal Suite | Royal Deck Royal Suites |
| Cat. P | Royal Deck Panorama Suites |
| Cat. A | Sapphire Deck Forward Panorama Suites |
| Cat. B | Sapphire Deck Aft Panorama Suites |
| Cat. D | Indigo Deck Aft Deluxe Staterooms |
| Cat. E | Indigo Deck Forward Deluxe Staterooms |

CABIN AMENITIES:

- Some of the largest accommodations available on a European river
- Two windows (high windows, above the waterline, in the Staterooms, and wall-to-wall panoramic windows in the Panorama and Royal suites) and elegant, contemporary décor
- Comfort Collection Beds, with Memory foam mattress toppers, in your choice of bed configuration, Egyptian supercombed cotton linens, European-style duvets, extra blankets, and both soft and firm pillows
- Alarm clock, bedside tables with reading lamps, and easy under-bed luggage storage
- Spacious 3-door closets with shelves for ample storage
- Bathroom with full shower with glass door, vanity and large mirror, hairdryer, bathrobes and slippers, and L'Occitane bath products
- Writing desk
- Flatscreen satellite TV with English-speaking TV channels and over 100 free movie options
- Direct-dial telephone
- Well-stocked minibar (billed on consumption) and water-refill stations
- In-room safe
- Individual climate control
- Complimentary wifi
- Nightly turndown service

POETRY II



DELUXE STATEROOM, CATEGORY E

EARLY BIRD \$4,499 PP REGULAR \$5,899 PP

Deluxe Stateroom features small windows above the water-line, Comfort collection bed can convert to 2 singles, soft & firm pillows, Egyptian super-combed cotton linens, flat-screen satellite TV with movie channels, telephone, mini-bar, full shower with glass doors, robes, slippers, writing desk and chair, and full-length closets. Windows are high on wall, do not open. Room is below water line. (172 sq. ft.)

DELUXE STATEROOM, CATEGORY D

EARLY BIRD \$4,599 PP REGULAR \$5,999 PP

Deluxe Stateroom features small windows above the water-line, Comfort collection bed can convert to 2 singles, soft & firm pillows, Egyptian super-combed cotton linens, flat-screen satellite TV with movie channels, telephone, mini-bar, full shower with glass doors, robes, slippers, writing desk and chair, and full-length closets. Windows are high on wall, do not open. Room is below water line. (172 sq. ft.)

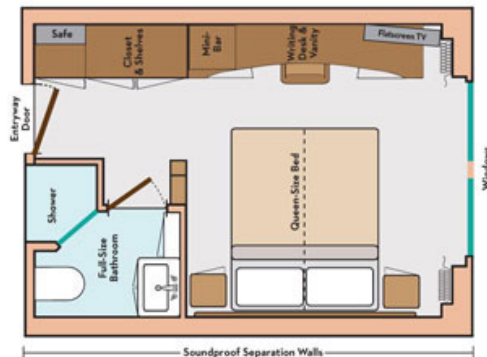

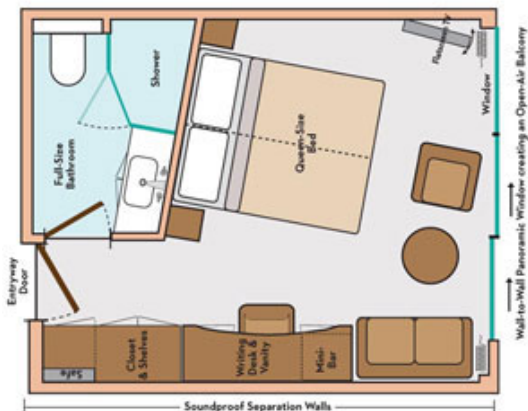

PANORAMA SUITE, CATEGORY B

EARLY BIRD \$5,399 PP REGULAR \$7,099 PP

Panorama Suite features floor-to-ceiling windows, sliding glass doors, Comfort collection bed can convert to 2 singles, soft & firm pillows, Egyptian super-combed cotton linens, flat-screen satellite TV with movie channels, telephone, mini-bar, full-sized bathroom with marble counter, full shower with glass door, robes, slippers, writing desk, chair, sofa, coffee table and full-length closets. (200 sq. ft.)

PANORAMA SUITE, CATEGORY A

EARLY BIRD \$5,499 PP REGULAR \$7,199 PP

Panorama Suite features floor-to-ceiling windows, sliding glass doors, Comfort collection bed can convert to 2 singles, soft & firm pillows, Egyptian super-combed cotton linens, flat-screen satellite TV with movie channels, telephone, mini-bar, full-sized bathroom with marble counter, full shower with glass door, robes, slippers, writing desk, chair, sofa, coffee table and full-length closets. (200 sq. ft.)

PANORAMA SUITE, CATEGORY P

EARLY BIRD \$5,599 PP REGULAR \$7,299 PP

Panorama Suite features floor-to-ceiling windows, sliding glass doors, Comfort collection bed can convert to 2 singles, soft & firm pillows, Egyptian super-combed cotton linens, flat-screen satellite TV with movie channels, telephone, mini-bar, full-sized bathroom with marble counter, full shower with glass door, robes, slippers, writing desk, chair, sofa, coffee table and full-length closets. (200 sq. ft.)



ROYAL SUITE

EARLY BIRD \$6,499 PP REGULAR \$8,499 PP

Located on the Royal deck, the Royal Suite features floor-to-ceiling windows, sliding glass doors, Comfort collection bed can convert to 2 singles, soft & firm pillows, Egyptian super-combed cotton linens, flat-screen satellite TV with movie channels, telephone, mini-bar, bathroom with marble counter and two sinks, robes, slippers, writing desk and chair, sofa, coffee table and full-length closets. (300 sq. ft.)

PARIS, DIJON, BEAUNE ST. JEAN DE LOSNE

Tuesday, July 27, 2021

(embarkation)

This morning, transfer from Paris host hotel to Beaune, the unofficial capital of the Côte d'Or area. Beaune owes its wealth to the production, aging, and selling of fine wines. Although life here centers around wine, Beaune offers much more. Today you have an included tour. Choose from a wine tasting in a local cellar, OR visit the HÔTEL-DIEU charity hospital, built in 1443 and paid for by the chancellor of Burgundy after the Hundred Years' War left many of the town's population destitute. Today it houses Van der Weyden's painting of *The Last Judgment* and is one of France's architectural highlights. Then, continue to St. Jean de Losne, where you'll board your river cruise vessel. Before dinner, meet your Olivia staff and ship's crew at a welcome reception as your ship departs for Mâcon.



SEURRE / MÂCON

Wednesday, July 28, 2021

Enjoy some leisurely cruising today and before lunch, enjoy an Onboard Cheese Tasting. In the late afternoon, arrive in Mâcon, a city that plays an important role in the wine trade. Free time allows you to explore on your own. Alternatively, you may choose to participate in one of the optional excursions offered, such as a visit to a wine cellar.

LYON



Thursday, July 29, 2021

Lyon, France's third-largest city and its gastronomic capital, was founded by the Romans in 43 B.C. The city's prosperity dates back to the 16th century and is due to commercial, industrial, and banking activities. Roman remains, excellent museums, and renaissance architecture delight visitors. A local guide joins you as you survey the city from Fourvière Hill and explore the Old Town with its maze of medieval alleyways, and Place des Terreaux, a popular area with lively cafés, monuments, and the famous fountain often depicted on postcards. Tonight, you may choose to participate in an optional tour to Paul Bocuse, a 3-star Michelin Restaurant for the meal of a lifetime!

Friday, July 30, 2021

Enjoy a free day in this fascinating city to explore at leisure. Early risers might like to visit the local produce market. Perhaps wander through one of Lyon's parks, discover some of the murals (there are over 100), or select one of the available optional excursions. Be sure to taste the gastronomic delights and sample Beaujolais, the wine of the region; wine connoisseurs know that the grapes must be hand-picked. Or take a bike ride along the river. Your Cruise Director will have plenty of suggestions for things to do.



TOURNON, TAIN-L'HERMITAGE, AND VIVIERS

Saturday, July 31, 2021

The twin cities of Tournon and Tain l'Hermitage lie nestled among vineyards between the Rhône River and the granite slopes of the Hermitage. A local guide will show you Tournon, one of France's oldest medieval cities, with its imposing 16th-century castle and Roman ruins. Your Olivia Cruise Director will take you to one of the best chocolate shops for some free tastings. Arriving in Viviers in the afternoon, a guided walk shows you this charming town that developed around its Romanesque cathedral. The Old Town has an appealing mix of Christian, Roman, and medieval influences. An included "Organ Concert" organized by Olivia will end the tour at the top of the hill with beautiful views.

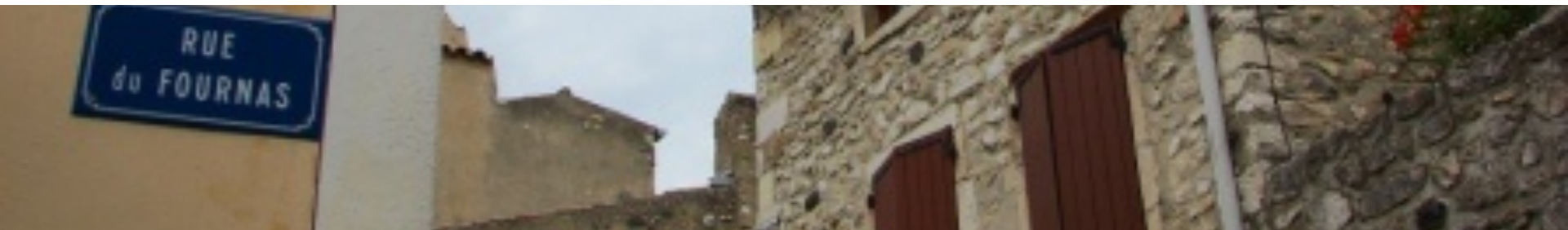

Sunday, August 1, 2021

The fortified city of Avignon is the capital of the Vaucluse region, the most picturesque part of Provence with its intact ramparts encircling the entire city, cobblestone streets and squares, and private mansions built in the 18th and 19th centuries. Known as the “City of Popes,” it was the center of the Catholic Church in the 14th century. During your guided tour, you may choose to join an included visit of the Palace of the Popes, built in the 14th century as the sovereign popes’ residence. A photo of the famous Pont Saint Bénézet (Saint Bénézet Bridge), of the popular song Sur le Pont d’Avignon, is a must. Optional excursions to Pont du Gard or to the famed wine cellars of Châteauneuf-du-Pape are available for purchase.



AVIGNON

Monday, August 2, 2021

This morning, wake up early to the tranquil vistas of Camargue National Park (daylight permitting) before arriving in Arles after breakfast. Located on the northern tip of the Camargue, Arles is capital of the Provence region. Your local guide will show you highlights of the city and you'll visit the Roman Amphitheater. Still used today, it dates to the 1st century and was constructed to hold more than 20,000 spectators. Visit areas where Van Gogh lived and painted.

Tuesday, August 3, 2021

After breakfast, disembark to fly home, or to your next destination, or join us on our extended stretcher to Marseille.

Included Tours and Optional Tours: Each city we visit will have an included walking or city tour. In addition, you will have the option to purchase optional tours that may range in price from 35 Euros to over 300 Euros (to experience a full meal with wine pairings at a Michelin 3-star restaurant!) These optional tours will not conflict with your included excursions. It's a way to experience and see a little more of these beautiful places we visit, go to wine regions and more historical areas of this region. Payments for the optional tours are made directly with your Avalon Cruise Director, separate from your on-board account. Or you can use that free-time to shop, check out a complimentary bike from the ship and ride along the river, or take a nap!

Please note: Itinerary is subject to change based on river level, traffic, and locks.

ARLES



PARIS



MARSEILLE



VACATION STRETCHERS

We will offer a 1-, 2- and 3-night Pre-Cruise Vacation Stretcher in Paris, France (July 26-27, July 25-27, and July 24-27, 2021). We will also offer a Post-Cruise Vacation Stretcher in Marseille (August 3-4 and August 3-5, 2021). More information will be available 9-11 months prior to the trip.

CATEGORY

DELUXE STATEROOM, CATEGORY E

Located on the Indigo deck, 172 sq. ft.

DELUXE STATEROOM, CATEGORY D

Located on the Indigo deck, 172 sq. ft.

PANORAMA SUITE, CATEGORY B

Located on the Sapphire deck, 200 sq. ft.

PANORAMA SUITE, CATEGORY A

Located on the Sapphire deck, 200 sq. ft.

PANORAMA SUITE, CATEGORY P

Located on the Royal deck, 200 sq. ft.

ROYAL SUITE

Located on the Royal deck, 300 sq. ft.

PRICING PP

EARLY-BIRD: \$4,499

REGULAR: \$5,899

EARLY-BIRD: \$4,599

REGULAR: \$5,999

EARLY-BIRD: \$5,399

REGULAR: \$7,099

EARLY-BIRD: \$5,499

REGULAR: \$7,199

EARLY-BIRD: \$5,599

REGULAR: \$7,299

EARLY-BIRD: \$6,499

REGULAR: \$8,499

faq

ACTIVITY LEVEL

These trips do require a level of mobility, as most of the tours are walking tours for up to 3 hours, which may include walking on cobblestone streets and stairs. A 'Gentle Walkers' group is offered on most included walking tours, which accommodates those needing a little extra time and sometimes a shortened version of a tour, keeping in mind as few stairs as possible. If you are bringing a portable wheelchair or collapsible travel scooter, they must be able to collapse and be stored in your cabins. They cannot be used to get around the ship, only to use while off the ship. They may be used on tours that are accessible, but that can be difficult because of the cobblestone streets, stairwells, and the need to lift them up on curbs.

If you do have limited mobility, you are required to travel with someone who can assist you.

AIRFARE

Please check our [airline discounts page](https://olivia.com/airfare-specials) for the latest discounts:

<https://olivia.com/airfare-specials>

FLIGHTS

We highly recommend arriving in Paris one or two days early. Flights need to arrive in **Paris, France (CDG)** and out of **Marseille, France (MRS)**. Flights must arrive prior to or in the early morning on July 27 with enough time to make the included transfer with stop in Beaune from host hotel to ship at approximately 8 am. (Exact time/meeting location TBA). To take advantage of the included group transfer to the Marseille airport, flights from Marseille must depart after 10:30 am on August 3.

OLIVIA'S PREFERRED TRAVEL AGENCY



We are pleased to partner with Conlin Travel. A full-service, LGBTQ-friendly agency with staff located across the country, Conlin Travel looks forward to assisting you with your air travel and hotel reservations for stays outside of Olivia's pre- and post-trip packages. For air and hotel bookings, a small fee will be applied to your overall cost.

For assistance, please call Conlin Travel: 888-278-1698



oliviaTM



CALL YOUR OLIVIA TRAVEL CONSULTANT
USA & CANADA: 800-631-6277 INTERNATIONAL: 415-962-5700 X1

