

2021 Audi e-tron quattro

Charge Door & Charging Cord

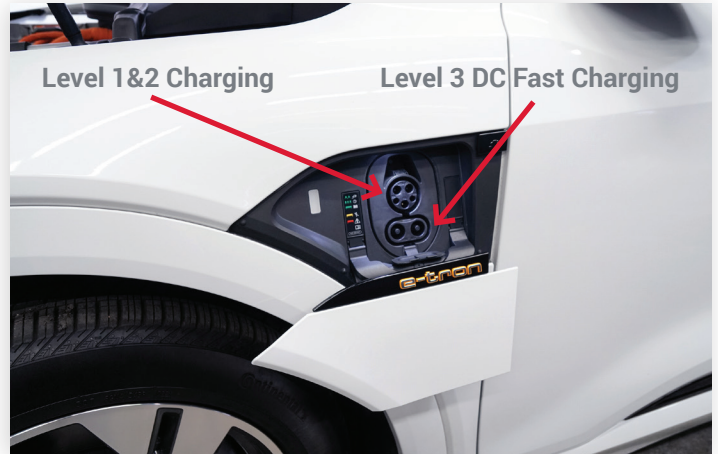

Press button to open Charge Door



Driver Side Charge Door
Level 1/2 & Level 3 DC Fast Charge Capable



Passenger Side Charge Door, *If Equipped*
Level 1/2 only



To release charging cable, unlock doors with remote then press button to unlock cord, depress button on top of the plug and pull from charge port. If not released from charge port in 30 seconds cable will automatically relock and resume charging.





Manual Charge Door and Charging Cord Releases can be found in the cowl area for each charge port assembly



Remove Cover

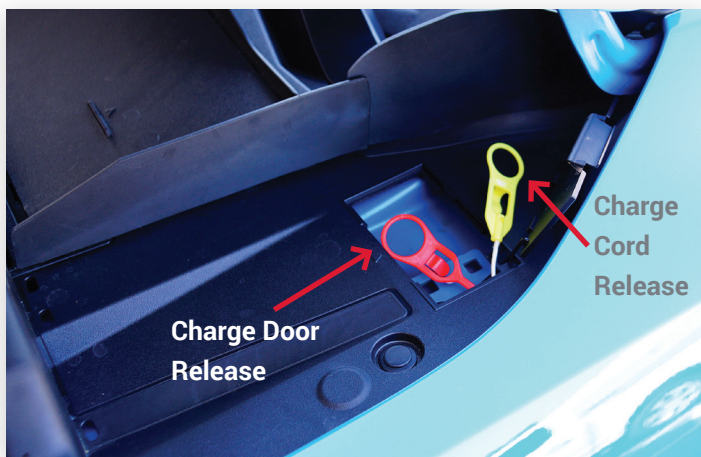

In the event of a Charge Door which fails to open or a Charge Cord which fails to release from the charge port there is a manual release for each.

To open a stuck Charge Port Door **gently** pull the Red Loop then open the Charge Door by hand pulling down and slightly away from the vehicle. The Charge Door regularly operates in a downward arc when opening and some outward movement should be expected when deploying by hand.

To release a stuck Charging Cord Connector first verify charging has stopped. Unlock vehicle with remote and press the release button as illustrated above. LED Charging Light in charge port should not be illuminated.

Once charging has been stopped **gently** pull on the Yellow Loop, press button on top of cord, and pull from charge port. Return Loops to retainers and reinstall cover when complete.

Charge Cable Best Practices

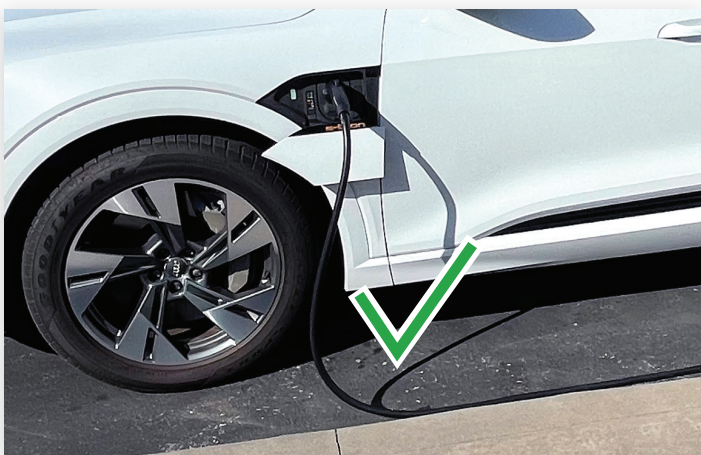

DON'T: The charge cable, especially DC Fast (Level 3), should not be pulled tight or maneuvered in such a way that the connection to the vehicle requires force. This tension the cable is under can potentially make the connector end of the cable wedge inside the charge port requiring additional effort to remove when disconnecting.

DO: The charge cable should easily reach the charge port. If a connector is not reaching reposition the vehicle.