

Programming Basics

...learning the rules

Universal Rotary

What is Universal Rotary?

The Universal Rotary program type is designed to operate on any 4 or 5-axis Hurco machine - regardless of the axis configuration.

The control will make the necessary movements based on the axes it has available.

Universal Rotary

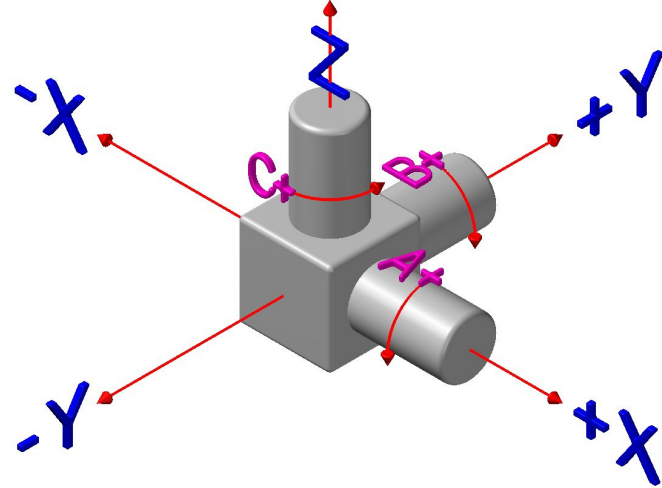
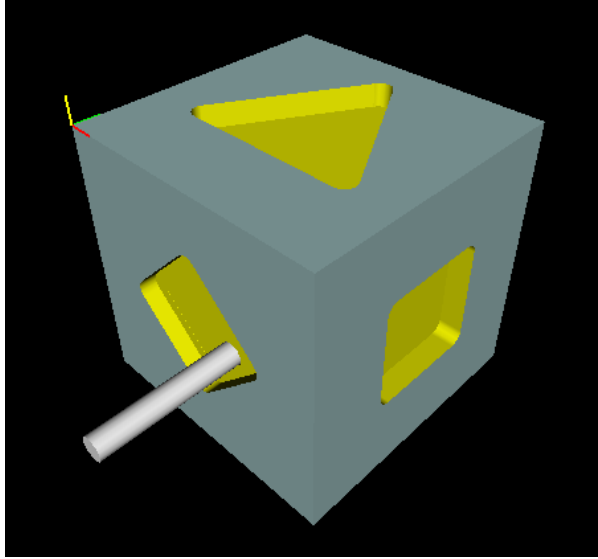

Simply program the tool as it would move around the part. DO NOT think about which axis would move on the machine.

Rotation Directions

...ISO standard & the right hand rule

ISO vs. Non-ISO Rotary

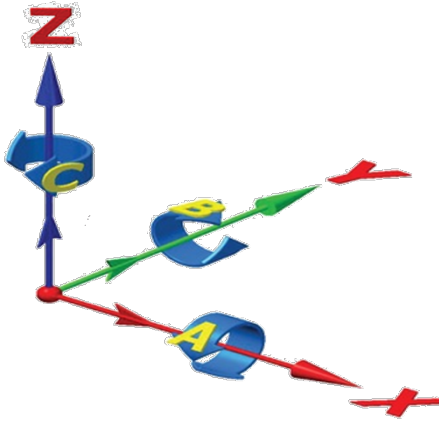

- There are two expressions that determine positive and negative rotations when programming rotary movements: ISO Standard & Non-ISO
- ISO is an Acronym for the International Organization for Standardization (ISO 841:2001)
- Non-ISO is the exact opposite
- Programming rotations are always ISO standard – regardless of machine setting

ISO vs. Non-ISO Rotary

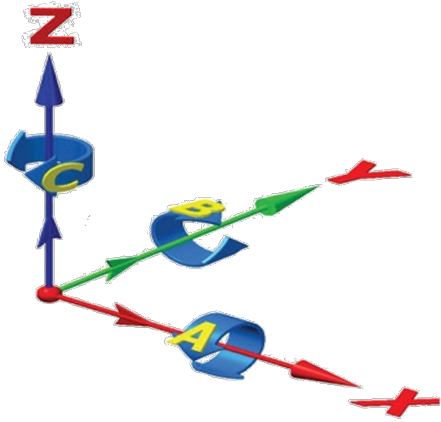

- There are two expressions that determine positive and negative rotations when programming rotary movements: ISO Standard & Non-ISO
- ISO is an Acronym for the International Organization for Standardization (ISO 841:2001)
- Non-ISO is the exact opposite
- Programming rotations are always ISO standard – regardless of machine setting

The Right Hand Rule

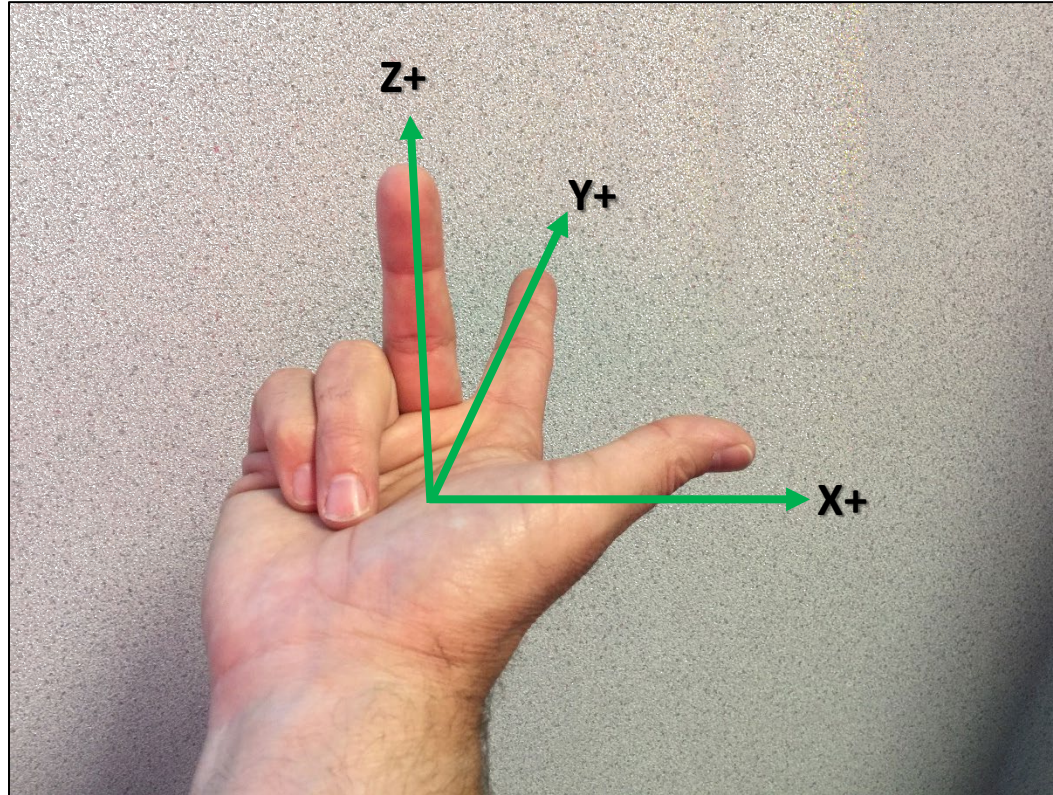

The Right Hand Rule

Lay the thumb along the positive direction of the linear axis, and the fingers wrap in the positive direction of rotation of the tool.

The right hand rule always describes the ISO Standard rotary direction

