

# Rigging Tools



## IPU10



The IPU10 vertical lifting clamp is used for the lifting, turning, moving or vertical transfer of sheet, plates, or fabrications from horizontal to vertical and down to horizontal (180°) as needed. The hinged hoisting eye allows for the clamp to place and lift the load from any direction, or with a multiple leg sling without side-loading the clamp.

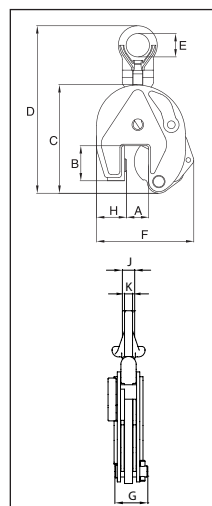

## Universal - For Lifting in any Direction

- Available in capacities of .5 thru 30 metric tons (Higher Working Load Limits are available upon request).
- Wide variety of jaw openings available: 0" to 6.13".
- Welded alloy steel body for strength and smaller size. Forged alloy components, where required.
- Individually Proof Tested to 2 times the Working Load Limit with certification.
- Company name (CrosbyIP), logo, Working Load Limit and jaw opening permanently stamped on body.
- Each product is individually serialized, with the serial number and Proof Load test date stamped on body. Serial number is included on the test certificate with maintenance and warranty logbook.
- Available in a variety of styles:
  - IPU10 - Standard clamp for materials with a surface hardness to 37Rc (345HB)
  - IPU10J - Larger jaw opening.
  - IPU10S - For use with Stainless Steel material.
  - IPU10H - For use with materials with a surface hardness to 47Rc (450HB).
- Full 180° turning range for material transfer, turning or moving.
- Lock open, lock closed ability with latch for pretension on material and then release of material.
- Optional IP-5000 Stinger assembly available (see page 420). Allows for easy connection between the clamp and hoist hook.
- Minimum WLL of 10% of Maximum WLL.
- Maintenance replacement kits are available.
- Manufactured by a ISO 9001 facility.
- All sizes are RFID EQUIPPED.

## IPU10S



**IPU10S:** For use on Stainless Steel material.  
**IPU10H:** For use on materials with a surface hardness to 47Rc (450 HB).



**Load Rated**

### Model IPU10

Model	Working Load Limit (t) *	IPU10 Stock No.	Weight Each (lbs.)	Dimensions (in.)									
				Jaw A	B	C	D	E	F	G	H	J	K
IPU10	0.5	2701675	4.19	0 - .63	1.73	5.04	8.98	1.57	4.53	1.61	1.10	-	.43
IPU10	1	2701663	5.29	0 - .75	1.77	5.47	8.74	1.57	4.96	1.61	1.50	-	.43
IPU10	2	2701677	18.7	0 - 1.38	3.07	7.91	14.65	2.76	7.48	2.40	2.17	-	.63
IPU10	3	2701665	32.6	0 - 1.56	3.94	9.96	17.52	2.95	8.86	3.07	2.36	-	.79
IPU10	4.5	2701667	35.3	0 - 1.56	3.94	9.96	17.52	2.95	9.13	3.23	2.56	-	.79
IPU10	6	2701669	53.0	0 - 2.00	4.96	11.89	20.67	3.15	11.50	3.31	3.74	1.73	.79
IPU10/J	6	2702469	67.3	2.00 - 4.00	4.96	11.89	20.67	3.15	13.46	3.31	3.74	1.73	.79
IPU10	9	2701671	65.0	0 - 2.00	4.96	12.80	21.93	3.15	12.20	3.62	4.13	1.73	.79
IPU10/J	9	2701673	67.2	2.00 - 4.00	4.96	12.80	22.13	3.15	14.17	3.62	4.13	1.73	.79
IPU10	12	2701679	126	0 - 2.13	6.30	15.39	24.53	3.15	13.03	4.61	5.39	1.61	.98
IPU10/J	12	2701681	130	2.13 - 4.25	7.01	17.28	26.50	3.15	16.34	4.61	5.39	1.61	.98
IPU10	16	2701683	159	.25 - 2.50	7.01	18.31	28.90	3.46	15.63	4.69	6.02	1.77	.98
IPU10/J	16	2701685	187	2.50 - 5.00	8.19	20.51	31.10	3.46	18.58	4.69	6.34	1.77	.98
IPU10	22.5	2701687	280	.25 - 3.13	8.74	21.81	33.66	4.33	18.50	5.35	7.32	1.93	.98
IPU10/J	22.5	2701689	287	3.13 - 6.13	9.96	24.72	36.61	4.33	22.64	5.35	7.72	1.93	.98
IPU10	30	2701691	337	.25 - 3.13	8.74	21.46	33.86	4.33	18.50	5.98	7.32	2.13	1.18
IPU10/J	30	2701693	364	3.13 - 6.13	9.84	24.41	36.81	4.33	22.24	5.98	7.72	2.13	1.18
For stainless steel - with universal hoisting eye													
IPU10/S	0.5	2702275	4.19	0 - .63	1.73	5.04	8.98	1.57	4.53	1.61	1.10	-	.43
IPU10/S	1	2702263	4.63	0 - .75	1.77	5.47	8.74	1.57	4.96	1.61	1.50	-	.43
IPU10/S	2	2702277	16.8	0 - 1.38	3.07	7.91	14.65	2.76	7.48	2.40	2.17	-	.63
IPU10/S	3	2702265	32.7	0 - 1.56	3.94	9.96	17.52	2.95	8.86	3.07	2.36	-	.79
IPU10/S	4.5	2702267	35.3	0 - 1.56	3.94	9.96	17.52	2.95	9.13	3.23	2.56	-	.79
IPU10/S	6	2702269	53.0	0 - 2.00	4.96	11.89	20.67	3.15	11.50	3.31	3.74	1.73	.79
IPU10/S	9	2702271	65.1	0 - 2.00	4.96	12.80	21.93	3.15	12.20	3.62	4.13	1.73	.79
IPU10/S	12	2702279	67.3	0 - 2.13	6.30	15.39	24.53	3.15	13.03	4.61	5.39	1.61	.98
For very hard materials - with universal hoisting eye													
IPU10/H	0.5	2702175	4.19	0 - .63	1.73	5.04	8.98	1.57	4.53	1.61	1.10	-	.43
IPU10/H	1	2702177	16.8	0 - 1.38	3.07	7.91	14.65	2.76	7.48	2.40	2.17	-	.63
IPU10/H	2	2702165	32.7	0 - 1.56	3.94	9.96	17.52	2.95	8.86	3.07	2.36	-	.79
IPU10/H	3	2702167	35.3	0 - 1.56	3.94	9.96	17.52	2.95	9.13	3.23	2.56	-	.79
IPU10/H	4.5	2702169	53.0	0 - 2.00	4.96	11.89	20.67	3.15	11.50	3.31	3.74	1.73	.79
IPU10/H	6	2702171	65.1	0 - 2.00	4.96	12.80	21.93	3.15	12.20	3.62	4.13	1.73	.79

\* Design Factor based on EN 13155 and ASME B30.20.

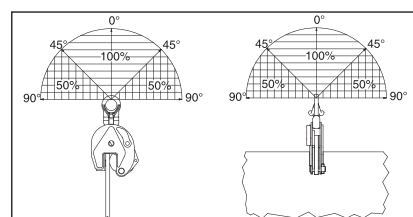

**Crosby**

## IP10



The IP10 vertical lifting clamp is used for the lifting, turning, moving or vertical transfer of sheet, plates, or fabrications from horizontal to vertical and down to horizontal (180°) as needed. Usually used as a single point pick or when used with a spreader beam with multiple vertical drop lines.

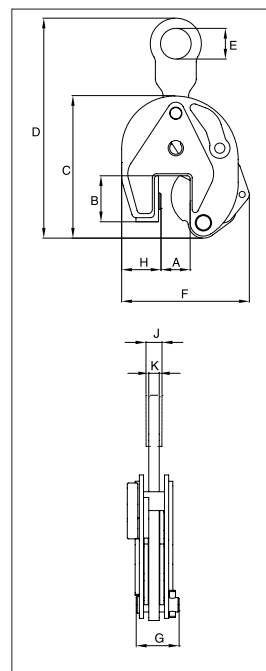

## For Vertical Lifting, Turning and Transfer

- Available in capacities of .5 thru 30 metric tons (Higher Working Load Limits are available upon request).
- Wide variety of jaw openings available: 0" to 6.10".
- Welded alloy steel body for strength and smaller size. Forged alloy components, where required.
- Individually Proof Tested to 2 times the Working Load Limit with certification.
- Company name (CrosbyIP), logo, Working Load Limit and jaw opening permanently stamped on body.
- Each product is individually serialized, with the serial number and Proof Load test date stamped on body. Serial number is included on the test certificate with maintenance and warranty logbook.
- Available in a variety of styles:
  - IP10 - Standard clamp for materials with a surface hardness to 37Rc (345 HB).
  - IP10J - Larger jaw opening.
  - IP10S - For use with Stainless Steel material.
  - IP10H - For use with materials with a surface hardness to 47Rc (450 HB).
- Full 180° turning range for material transfer, turning or moving.
- Lock open, lock closed ability with latch for pretension on material and then release of material.
- Optional IP-5000 Stinger assembly available (see page 420). Allows for easy connection between the clamp and hoist hook.
- Minimum WLL of 10% of Maximum WLL.
- Maintenance replacement kits are available.
- Manufactured by a ISO 9001 facility.
- All sizes are RFID EQUIPPED.



## Model IP10

Model	Working Load Limit (t) *	IP10 Stock No.	Weight Each (lbs.)	Dimensions (in.)									
				Jaw A	B	C	D	E	F	G	H	J	K
IP10	0.5	2701674	3.97	0 - .63	1.73	5.04	8.15	1.18	4.53	1.61	1.10	-	.39
IP10	1	2701662	4.85	0 - .75	1.77	5.47	8.46	1.18	4.96	1.61	1.50	-	.39
IP10	2	2701676	16.8	0 - 1.38	3.07	7.91	13.23	2.76	7.48	2.40	2.17	-	.63
IP10	3	2701664	30.4	0 - 1.56	3.94	9.96	17.17	2.95	8.86	3.07	2.36	-	.79
IP10	4.5	2701666	33.1	0 - 1.56	3.94	9.96	17.17	2.95	9.13	3.23	2.56	-	.79
IP10	6	2701668	51.9	0 - 2.00	4.96	11.89	20.28	3.15	11.50	3.31	3.74	1.57	.79
IP10/J	6	2701705	62.9	2.00 - 4.00	4.96	11.89	20.28	3.15	13.46	3.31	3.74	1.57	.79
IP10	9	2701670	60.7	0 - 2.00	4.96	12.80	21.65	3.15	12.20	3.62	4.13	1.73	.79
IP10/J	9	2701672	62.9	2.00 - 4.00	4.96	12.80	21.85	3.15	14.17	3.62	4.13	1.73	.79
IP10	12	2701678	108	0 - 2.13	6.30	15.39	22.83	3.16	13.03	4.61	5.39	1.61	.98
IP10/J	12	2701680	128	2.13 - 4.25	7.01	17.28	24.80	3.15	16.34	4.61	5.39	1.61	.98
IP10	16	2701682	150	.25 - 2.50	7.01	18.31	27.17	3.46	15.63	4.69	6.02	1.93	.98
IP10/J	16	2701684	199	2.50 - 5.00	8.19	20.51	29.37	3.46	18.58	4.69	6.34	1.93	.98
IP10	22.5	2701686	238	.25 - 3.13	8.74	21.81	31.50	4.33	18.50	5.35	7.32	1.93	.98
IP10/J	22.5	2701688	243	3.13 - 6.10	9.96	24.72	34.65	4.33	22.64	5.35	7.72	1.93	.98
IP10	30	2701690	327	.25 - 3.13	8.74	21.46	31.50	4.33	18.50	5.98	7.32	2.13	1.18
IP10/J	30	2701692	335	3.13 - 6.10	9.84	24.41	34.65	4.33	22.24	5.98	7.72	2.13	1.18
For stainless steel - with fixed hoisting eye													
IP10/S	0.5	2702274	3.97	0 - .63	1.73	5.04	8.15	1.18	4.53	1.61	1.10	-	.39
IP10/S	1	2702262	4.41	0 - .75	1.77	5.47	8.46	1.18	4.96	1.61	1.50	-	.39
IP10/S	2	2702276	15.0	0 - 1.38	3.07	7.91	13.23	2.76	7.48	2.40	2.17	-	.63
IP10/S	3	2702264	30.5	0 - 1.56	3.94	9.96	17.17	2.95	8.86	3.07	2.36	-	.79
IP10/S	4.5	2702266	33.1	0 - 1.56	3.94	9.96	17.17	2.95	9.13	3.23	2.56	-	.79
IP10/S	6	2702268	51.9	0 - 2.00	4.96	11.89	20.67	3.15	11.50	3.31	3.74	1.57	.79
IP10/S	9	2702270	60.7	0 - 2.00	4.96	12.80	21.93	3.15	12.20	3.62	4.13	1.73	.98
IP10/S	12	2702278	108	0 - 2.13	6.30	15.39	24.53	3.15	13.03	4.61	5.39	1.61	.98
For very hard materials - with fixed hoisting eye													
IP10/H	0.5	2702174	3.97	0 - .63	1.73	5.04	8.15	1.18	4.53	1.61	1.10	-	.39
IP10/H	1	2702176	15.0	0 - 1.38	3.07	7.91	13.23	2.76	7.48	2.40	2.17	-	.39
IP10/H	2	2702164	30.4	0 - 1.56	3.94	9.96	17.17	2.95	8.86	3.07	2.36	-	.63
IP10/H	3	2702166	33.1	0 - 1.56	3.94	9.96	17.17	2.95	9.13	3.23	2.56	-	.79
IP10/H	4.5	2702168	51.9	0 - 2.00	4.96	11.89	20.28	3.15	11.50	3.31	3.74	1.57	.79
IP10/H	6	2702170	60.7	0 - 2.00	4.96	12.80	21.65	3.15	12.20	3.62	4.13	1.73	.98

\* Design Factor based on EN 13155 and ASME B30.20.

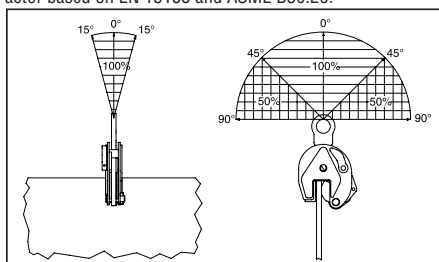



### IPNM10N



The IPNM10N vertical lifting clamp is used for the lifting, turning, moving or vertical transfer of sheet, plates, or fabrications from horizontal to vertical and down to horizontal (180°) as needed without marring the surface of the material. Materials such as aluminum, stainless steel, painted materials, aircraft skins, composite material, glass, plastic, etc., can be lifted without marring.

Will NOT mar, or scratch the material surface.

For use in almost all sectors of industry where during the lift or transfer, no damage to the material is permitted.

- Available in capacities of .5, 1 and 2 metric tons.
- Wide variety of jaw openings available: 0" to 1.50"
- Welded alloy steel body for strength and smaller size. Forged alloy components, where required.
- Individually Proof Tested to 2 times the Working Load Limit with certification.
- Company name (CrosbyIP), logo, Working Load Limit and jaw opening permanently stamped on body.
- Each product is individually serialized, with the serial number and Proof Load test date stamped on body. Serial number is included on the test certificate with maintenance and warranty logbook.
- Full 180° turning range for material transfer, turning or moving.
- Lock open, lock closed ability with latch for pretension on material and then release of material.
- Optional IP-5000 Stinger assembly available (see page 420). Allows for easy connection between the clamp and hoist hook.
- Material must be clean and dry.
- Maintenance replacement kits are available.
- Manufactured by a ISO 9001 facility.
- All sizes are RFID EQUIPPED.

### IPNM10P



The IPNM10P vertical lifting clamp is used for the lifting, turning, moving or vertical transfer of sheet, plates, or fabrications from horizontal to vertical and down to horizontal (180°) as needed without marring the surface of the material. Materials such as aluminum, stainless steel, painted materials, aircraft skins, composite material, glass, plastic, etc., can be lifted without marring. The protective cover reduces the risk of damage to surrounding plates. Will NOT mar, or scratch the material surface.



### Model IPNM10

Model	Working Load Limit (t)*	IPNM10 Stock No.	Weight Each (lbs.)	Dimensions (in.)								
				Jaw A	B	C	D	E	F	G	H	K
IPNM10N	.5	2703811	5.95	0 - .38	3.31	6.26	9.25	1.57	5.04	2.36	1.61	.43
IPNM10N	1	2703738	9.70	0 - .79	4.33	8.23	10.63	1.18	7.24	3.15	2.20	.39
IPNM10N	2	2703442	32.0	0 - 1.50	6.02	10.16	16.00	2.76	12.00	3.94	6.34	.63
With protection cap												
IPNM10P	.5	2703278	6.2	0 - .38	3.23	6.18	8.39	1.57	5.71	2.68	1.89	.43
IPNM10P	1	2703279	9.9	0 - .75	3.82	7.68	10.55	1.18	8.07	3.23	2.36	0.39
With larger jaw opening												
IPNM10NJ	1	2703814	12.1	.81 - 1.44	3.39	7.72	10.43	1.18	6.97	3.15	2.01	.39

\* Design Factor based on EN 13155 and ASME B30.20.

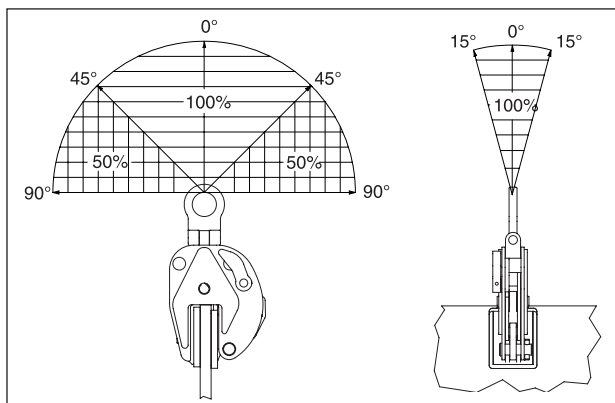
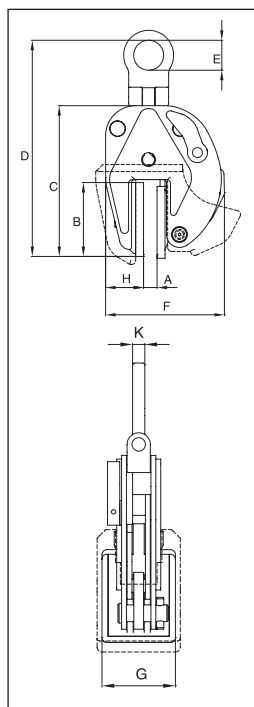

**Crosby**

## IPHNM10



The IPHNM10 horizontal lifting clamps have a pretension feature that allows the user to attach the clamps to the material for horizontal lifting and transfer of non-sagging material. To be used where material surface must not be damaged. These clamps must be used in pairs or more.

## For Horizontal Lift and Transfer - with Pretension System

- Available in capacities of .5 thru 12 metric tons.
- Jaw openings available: 0" to 4.75".
- Welded alloy steel body for strength and smaller size. Forged alloy components, where required.
- Individually Proof Tested to 2 times the Working Load Limit with certification.
- Company name (CrosbyIP), logo, Working Load Limit and jaw opening permanently stamped on body.
- Each product is individually serialized, with the serial number and Proof Load test date stamped on body. Serial number is included on the test certificate with maintenance and warranty logbook.
- Maintenance replacement parts are available.
- Manufactured by a ISO 9001 facility.
- All sizes are RFID EQUIPPED.



## IPH10



The IPH10 horizontal lifting clamps with spring loaded tension have a pretension feature that allows the user to attach the clamps to the material for horizontal lifting and transfer of non-sagging material. These clamps must be used in pairs or more.

### Model IPHNM10

Model	Working Load Limit (Per Pair) (t)*	IPHNM10 Stock No.	Weight Each (lbs.)	Dimensions (in.)									
				Jaw A	B	C	D	E	F	G	H	J	K
IPHNM10	.5	2703287	4.41	0 - .75	3.19	.87	3.23	.63	3.98	6.30	2.91	.47	2.36
IPHNM10	1	2703288	7.70	0 - 1.38	3.66	1.18	3.62	.63	4.06	6.46	2.91	.47	2.36
IPHNM10	2	2703290	16.5	0 - 1.19	5.47	1.18	5.16	.87	6.54	9.65	3.94	.79	2.91
IPHNM10/J	2	2703291	17.6	1.19 - 2.38	6.65	1.18	5.16	.87	6.54	9.65	3.94	.79	2.91

\* Design Factor based on EN 13155 and ASME B30.20.

### Model IPH10 and IPH10/J: With Spring Loaded Tension, Magnets and Handle

Model	Working Load Limit (Per Pair) (t)*	IPH10 Stock No.	Weight Each (lbs.)	Dimensions (in.)									
				Jaw A	B	C	E	F	G	H	J	K	
IPH10	.5+	2703297	3.97	0 - .75	3.39	.47	.63	4.06	5.91	2.36	.47	1.06	
IPH10	1+	2703298	5.50	0 - 1.38	3.94	.63	.63	4.06	5.91	2.36	.47	1.22	
IPH10	2	2703522	12.1	0 - 2.38	4.61	.63	.87	4.29	10.08	4.33	.79	1.57	
IPH10	3	2703523	16.5	0 - 2.38	4.61	.79	1.02	4.29	10.47	4.72	.79	1.89	
IPH10	4.5	2703524	23.1	0 - 2.38	5.20	.98	1.18	4.09	11.02	5.12	.79	1.89	
IPH10	6	2703525	28.6	0 - 2.38	5.63	.98	1.42	4.84	12.60	5.12	.79	1.89	
IPH10	9	2703526	40.8	0 - 2.38	6.18	1.18	1.69	5.24	12.99	5.51	.98	2.44	
IPH10	12	2703527	47.4	0 - 2.38	6.77	1.18	1.85	5.55	13.90	5.91	.98	2.44	
With larger jaw opening													
IPH10/J	3	2703533	19.8	2.38 - 4.75	6.97	.79	1.02	4.29	10.47	4.72	.79	1.89	
IPH10/J	4.5	2703534	26.5	2.38 - 4.75	7.56	.98	1.18	4.09	11.02	5.12	.79	1.89	
IPH10/J	6	2703535	33.1	2.38 - 4.75	7.99	.98	1.42	4.84	12.60	5.12	.79	1.89	
IPH10/J	9	2703536	45.2	2.38 - 4.75	8.54	1.18	1.69	5.24	12.99	5.51	.98	2.44	
IPH10/J	12	2703537	52.9	2.38 - 4.75	9.13	1.18	1.85	5.55	13.90	5.91	.98	2.44	

\* Design Factor based on EN 13155 and ASME B30.20. + No handle or magnets.

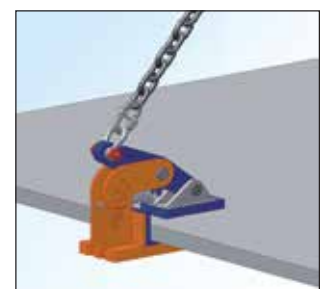
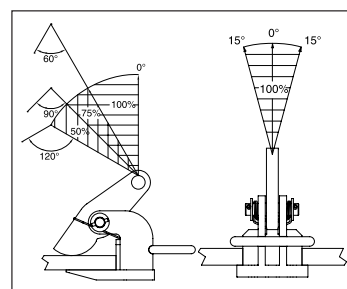
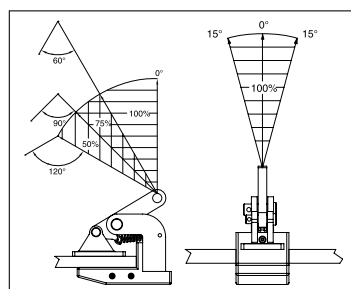
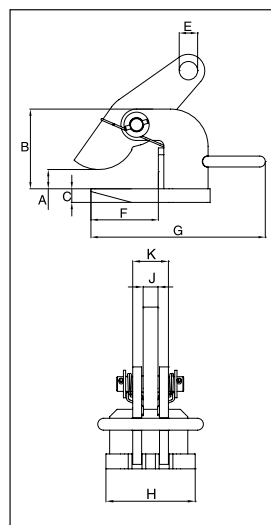
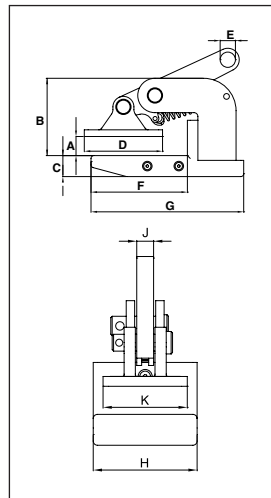

**Crosby**

## IPH10E



The IPH10E / IPH10JE horizontal lifting clamps are for use in the lifting and transfer in horizontal position of non-sagging materials or of bundles of non-sagging material. These clamps must be used in pairs or more.

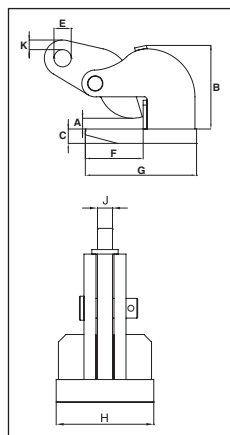
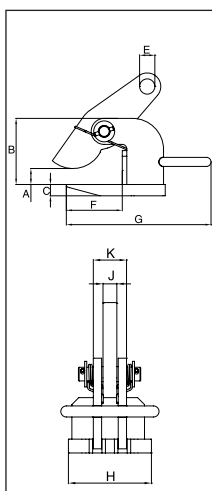

## For Horizontal Lifting and Transfer

- Available in capacities of .75 thru 25 metric tons.
- Wide variety of jaw openings available: 0 to 120mm.
- Welded alloy steel body for strength and smaller size. Forged alloy components, where required.
- Equipped with handle for easy placement.
- Individually Proof Tested to 2 times the Working Load Limit with certification.
- Company name (CrosbyIP), logo, Working Load Limit and jaw opening permanently stamped on body.
- Each product is individually serialized, with the serial number and Proof Load test date stamped on body. Serial number is included on the test certificate with maintenance and warranty logbook.
- Maintenance replacement parts are available.
- Manufactured by a ISO 9001 facility.
- All sizes are RFID EQUIPPED.

## IPHOZ



The IPHOZ horizontal lifting clamp is to be used for lifting and transferring, in the horizontal position, of thin sheet and other materials that will sag or bend when lifted. These clamps must be used in pairs or more.



### Model IPH10E: Jaw opening range 0 to 2.36in

Model	Working Load Limit (Per Pair) (t)*	IPHTONZ Stock No.	Weight Each (lbs.)	Dimensions (in)								
				Jaw A	B	C	E	F	G	H	J	K
IPH10E	2	2703542	12.1	0 - 2.36	4.61	.63	.87	4.29	10.1	4.33	.79	1.58
IPH10E	3	2703543	16.5	0 - 2.36	4.61	.79	1.02	4.29	10.5	4.73	.79	1.89
IPH10E	4.5	2703544	23.2	0 - 2.36	5.20	.99	1.18	4.10	11.0	5.12	.79	1.89
IPH10E	6	2703545	28.7	0 - 2.36	5.63	.99	1.42	4.85	12.6	5.12	.79	1.89
IPH10E	9	2703546	40.8	0 - 2.36	6.19	1.18	1.69	5.24	13.0	5.52	.99	2.44
IPH10E	12	2703547	47.4	0 - 2.36	6.78	1.18	1.85	5.56	13.9	5.91	.99	2.44
IPHTOZ	25	2705119	86.0	0 - 2.38	6.65	1.57	1.85	6.69	11.81	8.66	1.26	.87

\* Design Factor based on EN 13155 and ASME B30.20.

### Model IPH10JE: Jaw opening range 2.36 to 4.73"

Model	Working Load Limit (Per Pair) (t)*	IPH10JE Stock No.	Weight Each (lbs.)	Dimensions (in)									
				Jaw A	B	C	E	F	G	H	J	K	L
IPH10JE	3	2703553	19.8	2.36 - 4.73	6.97	.79	1.02	4.29	10.5	4.73	.79	1.89	.43
IPH10JE	4.5	2703554	26.5	2.36 - 4.73	7.56	.99	1.18	4.10	11.0	5.12	.79	1.89	.47
IPH10JE	6	2703555	33.0	2.36 - 4.73	8.00	.99	1.42	4.85	12.6	5.12	.79	1.89	.55
IPH10JE	9	2703556	45.2	2.36 - 4.73	8.55	1.18	1.69	5.24	13.0	5.52	.99	2.44	.63
IPH10JE	12	2703557	25.9	2.36 - 4.73	9.14	1.18	1.85	5.56	13.9	5.91	.99	2.44	.67

\* Design Factor based on EN 13155 and ASME B30.20.

### Model IPHOZ: Jaw opening range 0 to 2.38"

Model	Working Load Limit (Per Pair) (t)*	IPHOZ Stock No.	Weight Each (lbs.)	Dimensions (in.)								
				Jaw A	B	C	E	F	G	H	J	K
IPHOZ	0.75	2705401	6.60	0 - 1.19	3.70	.63	.63	2.76	4.65	3.19	.47	.47
IPHOZ	1.5	2705402	12.1	0 - 1.75	5.24	.63	.87	4.92	7.56	3.94	.63	.47
IPHOZ	3	2705403	17.6	0 - 1.75	5.39	.79	1.02	4.92	7.87	4.72	.79	.39
IPHOZ	4.5	2705404	18.7	0 - 1.75	5.43	.98	1.18	4.96	8.66	4.72	.79	.39
With larger jaw opening												
IPHOZ	6	2705405	34.2	0 - 2.38	6.73	1.18	1.42	5.31	9.25	5.12	.79	.79
IPHOZ	9	2705406	45.2	0 - 2.38	8.31	1.18	1.69	6.54	10.87	6.30	.98	.79
IPHOZ	12	2705407	83.8	0 - 2.38	8.54	1.57	1.85	6.61	11.57	7.48	.98	.75
IPHOZ	15	2705408	83.8	0 - 2.38	8.66	1.57	1.85	7.20	12.48	9.84	.98	.87

\* Design Factor based on EN 13155 and ASME B30.20.

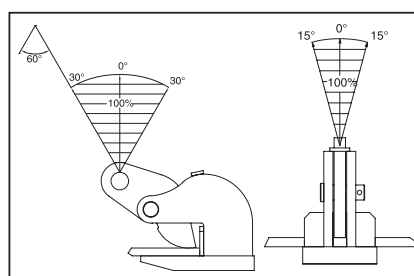
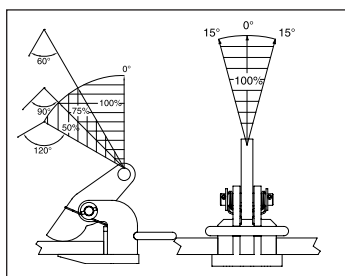

## IPBC



The IPBC horizontal lifting clamps have a pretension feature that allows the user to attach the clamps to the material for horizontal lifting and transfer of sagging and non-sagging material. These clamps may also be used to handle material that will be used in shears, bending and rolling machines or other fabrication equipment. May also be used for turning beams from the "H" into the "I" position.

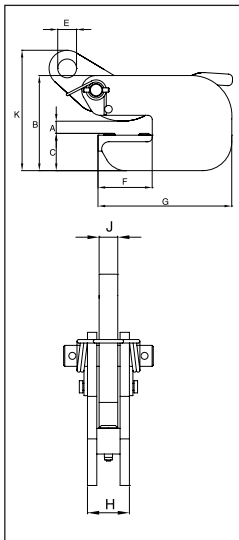

## For Horizontal Transfer - with Pretension System

- Available in capacities of 1 thru 4.5 metric tons.
- Jaw openings available: 0" to 1.56".
- Welded alloy steel body for strength and smaller size. Forged alloy components, where required.
- Individually Proof Tested to 2 times the Working Load Limit with certification.
- Company name (CrosbyIP), logo, Working Load Limit and jaw opening permanently stamped on body.
- Each product is individually serialized, with the serial number and Proof Load test date stamped on body. Serial number is included on the test certificate with maintenance and warranty logbook.
- Maintenance replacement parts are available.
- Manufactured by a ISO 9001 facility.
- All sizes are RFID EQUIPPED.

## IPHGUZ



The IPHGZ, IPHGUZ horizontal lifting clamps have a pretension locking feature that allows the user to attach the clamps to the material for horizontal lifting and transfer of sagging and non-sagging material. These clamps may also be used to handle material that will be used in shears, bending and rolling machines or other fabrication equipment. May also be used to move and lift structural shapes such as I-Beams, H-beams etc.



## Model IPBC

Model	Working Load Limit (t)*	IPBC Stock No.	Weight Each (lbs.)	Dimensions (in.)							
				Jaw A	B	C	E	F	G	H	J
IPBC	1	2700410	7.72	0 - .75	5.20	2.05	1.02	2.95	7.28	1.42	.63
IPBC	2	2700411	14.3	0 - 1.00	5.98	2.44	1.18	3.23	8.27	1.93	.79
IPBC	3	2700412	18.8	0 - 1.00	6.18	2.60	1.18	3.23	8.27	2.24	.79

\* Design Factor based on EN 13155 and ASME B30.20.

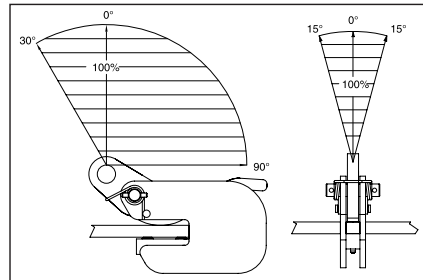

## Model IPHGZ: Universal Lifting Eye Model IPHGZ: Fixed Hoisting Eye

Model	Working Load Limit (t)*	Stock No.	Weight Each (lbs.)	Dimensions (in.)							
				Jaw A	B	C	D	E	F	G	J
IPHGZ	1.5	2705455	19.8	0 - 1.00	4.33	9.13	11.30	2.76	5.47	3.54	.79
IPHGZ	3.0	2705456	43.9	0 - 1.56	4.69	9.96	13.70	2.95	6.89	4.72	.98
IPHGZ	4.5	2705457	66.1	0 - 1.56	4.69	11.85	14.57	3.15	6.89	6.10	1.18
Fixed Hoisting Eye											
IPHGZ	.75	2705451	8.82	0 - 1.00	3.23	5.83	8.11	1.97	3.90	3.86	.47
IPHGZ	1.5	2705452	16.1	0 - 1.00	4.33	7.87	9.84	1.97	4.65	3.54	.79
IPHGZ	3.0	2705453	27.1	0 - 1.56	4.72	8.94	12.01	2.76	5.83	4.72	.98
IPHGZ	4.5	2705454	55.1	0 - 1.56	4.72	11.18	15.00	2.76	7.13	6.10	1.18

\* Design Factor based on EN 13155 and ASME B30.20.

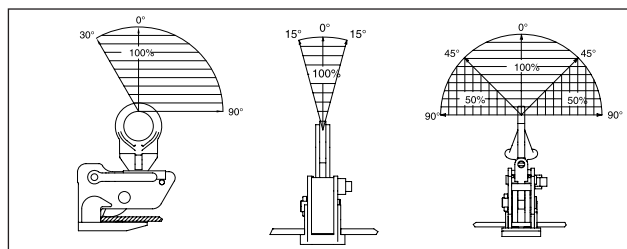

**Crosby**

### IPPE



The IPPE is suitable for the lifting and transfer of bundles of non-sagging steel plates in horizontal position. The jaw opening can be easily adjusted. Raising the handle opens the clamp. This facilitates the easy and quick placing or removing of the clamp.

### For the Lifting and Transfer of Bundles of Plates

- Available in capacities of 3 thru 12 metric tons.
- Wide variety of jaw openings available: 0 to 16.5".
- Welded alloy steel body for strength and smaller size. Forged alloy components, where required.
- Individually Proof Tested to 2 times the Working Load Limit with certification.
- Company name (CrosbyIP), logo, Working Load Limit and jaw opening permanently stamped on body.
- Each product is individually serialized, with the serial number and Proof Load test date stamped on body. Serial number is included on the test certificate with maintenance and warranty logbook.
- Manufactured by a ISO 9001 facility.
- All sizes are **RFID EQUIPPED**.



### Model IPPE

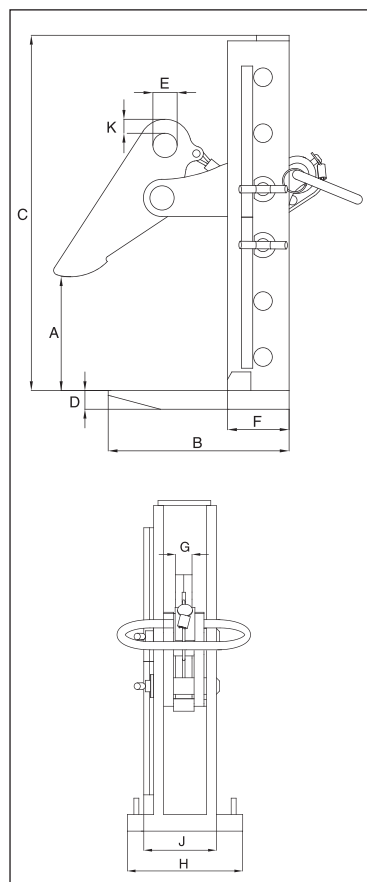

Model	IPPE Stock No.	Working Load Limit (Per Pair) (t)*	Weight Each (lbs.)	Dimensions (in.)									
				Jaw A	B	C	D	E	F	G	H	J	K
3 IPPEB	2700501	3.0	23.1	0 - 7.13	7.64	10.08	.79	1.02	2.60	.79	5.51	2.99	.59
3 IPPED	2700502	3.0	28.7	0 - 11.75	7.64	14.80	.79	1.02	2.60	.79	5.51	2.99	.59
3 IPPEH	2700503	3.0	30.9	0 - 16.50	7.64	19.53	.79	1.02	2.60	.79	5.51	2.99	.59
6 IPPEH	2700506	6.0	50.7	0 - 16.50	8.94	20.31	.98	1.18	4.02	.79	6.30	2.99	.51
9 IPPEH	2700509	9.0	68.3	0 - 16.50	10.63	22.28	.98	1.34	4.80	.79	7.48	2.99	.83
12 IPPEH	2700512	12.0	114.6	0 - 16.50	11.50	23.15	1.18	1.57	5.24	.98	7.87	3.82	.71

\* Design Factor based on EN 13155 and ASME B30.20.

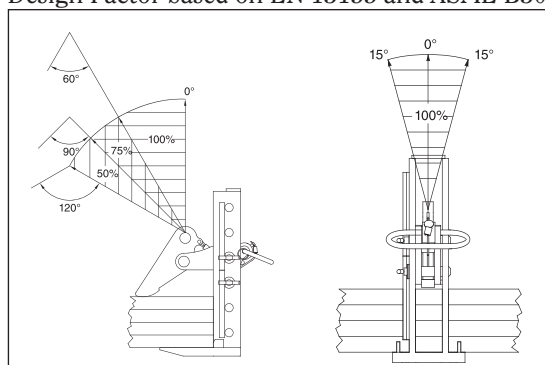

**Crosby**



## IPBKZ



The IPBKZ beam clamp is used for lifting, transfer and stacking of H-Beams. An over-center hoist eye allows for the beam flange to remain vertical. This series of clamps can be used in the vertical and horizontal moving, transfer and stacking of different types of structural designs, such as H-Beams, angles, etc, depending on the application desired.

## For the Transfer and Stacking of Steel Beams

- Available in capacities of .75 thru 3.75 metric tons.
- Wide variety of jaw openings available: 0" to 1.13".
- Welded alloy steel body for strength and smaller size. Forged alloy components, where required.
- Individually Proof Tested to 2 times the Working Load Limit with certification.
- Company name (CrosbyIP), logo, Working Load Limit and jaw opening permanently stamped on body.
- Each product is individually serialized, with the serial number and Proof Load test date stamped on body. Serial number is included on the test certificate with maintenance and warranty logbook.
- Optional IP-5000 Stinger assembly available (see page 420). Allows for easy connection between the clamp and hoist hook.
- Minimum WLL of 10% of Maximum WLL.
- Maintenance replacement parts are available.
- Manufactured by a ISO 9001 facility.
- All sizes are **RFID EQUIPPED**.

## IPVUZ



The IPVZ / IPVUZ beam clamp is used for vertical lift and transfer of angle iron and other loads that have only a small gripping area for the clamp ("U" has universal hoisting eye).

This series of clamps can be used in the vertical and horizontal moving, transfer and stacking of different types of structural designs, such as H-beams, angles, etc, depending on the application desired.



### Model IPBKZ

Model	Working Load Limit (t)*	IPBKZ Stock No.	Weight Each (lbs.)	Dimensions (in.)								
				Jaw A	B	C	D	E	F	G	H	J
IPBKZ	0.75	2705780	7.72	.19 - .63	1.69	5.20	7.56	1.77	4.45	1.85	1.50	.39
IPBKZ	1.5	2705781	15.4	.19 - 1.00	2.44	8.27	11.81	2.76	6.42	2.40	1.97	.63
IPBKZ	3.75	2705782	34.2	.19 - 1.13	2.95	10.24	16.34	3.94	7.95	3.07	2.05	.79

\* Design Factor based on EN 13155 and ASME B30.20.

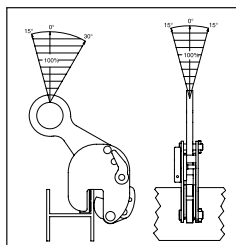

### Model IPVUZ: Universal Hoisting Eye

### Model IPVZ: Fixed Hoisting Eye

Model	Working Load Limit (t)*	Stock No.	Weight Each (lbs.)	Dimensions (in.)								
				Jaw A	B	C	D	E	F	G	H	K
IPVUZ	0.75	2705146	5.07	0 - .63	1.02	5.04	9.37	1.18	5.04	1.61	1.46	.39
IPVUZ	1.5	2705147	19.6	0 - .75	2.36	7.87	14.88	2.76	7.87	2.40	2.83	.63
Fixed Hoisting Eye												
IPVZ	0.75	2705096	4.63	0 - .63	1.02	5.04	8.15	1.18	4.53	1.61	1.18	.39
IPVZ	1.5	2705097	13.7	0 - .75	2.36	7.87	13.35	2.76	7.09	2.05	1.97	.63

\* Design Factor based on EN 13155 and ASME B30.20.

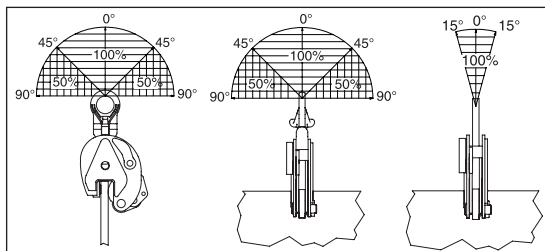

**Crosby**

## IPBHZ



The IPBHZ beam clamp is used for horizontal lifting and transfer of steel beams. The base is slotted to allow the clamps to be used from end of beams as well as from the flange. This series of clamps can be used in the vertical and horizontal moving, transfer and stacking of different types of structural designs, such as I-Beams, H-beams, angles, etc, depending on the application desired.

## For the Lifting and Transfer of Steel Beams

- Available in capacities of .75 thru 12 metric tons.
- Wide variety of jaw openings available: 0" to 2".
- Welded alloy steel body for strength and smaller size. Forged alloy components, where required.
- Individually Proof Tested to 2 times the Working Load Limit with certification.
- Company name (CrosbyIP), logo, Working Load Limit and jaw opening permanently stamped on body.
- Each product is individually serialized, with the serial number and Proof Load test date stamped on body. Serial number is included on the test certificate with maintenance and warranty logbook.
- Maintenance replacement parts are available.
- Manufactured by a ISO 9001 facility.
- All sizes are **RFID EQUIPPED**.

## IPBSNZ



The IPBSNZ beam clamp is used for lifting, transfer and stacking. Offset hoisting eye allows for level lifts of I-Beams, also for lifting fabrications and ship sections. This series of clamps can be used in the vertical and horizontal moving, transfer and stacking of different types of structural designs, such as I-Beams, depending on the application desired.



### Model IPBHZ

Model	Working Load Limit (t)*	IPBHZ Stock No.	Weight Each (lbs.)	Dimensions (in.)								
				Jaw A	B	C	D	E	F	G	J	K
IPBHZ	0.75	2705461	6.61	0 - 1.00	1.57	5.83	8.66	1.97	5.12	2.72	1.30	.87
IPBHZ	1.5	2705462	13.2	0 - 1.00	2.36	7.87	10.04	1.97	6.02	2.87	1.38	1.10
IPBHZ	3	2705463	23.2	0 - 1.56	3.15	8.94	12.80	2.76	7.40	4.41	1.50	1.26
IPBHZ	4.5	2705464	55.2	0 - 1.56	4.41	11.18	16.26	2.76	9.88	4.57	3.15	1.57
IPBHZ	12	2705467	92.6	0 - 1.56	4.92	18.35	19.29	3.54	12.48	3.54	3.54	1.85

\* Design Factor based on EN 13155 and ASME B30.20.

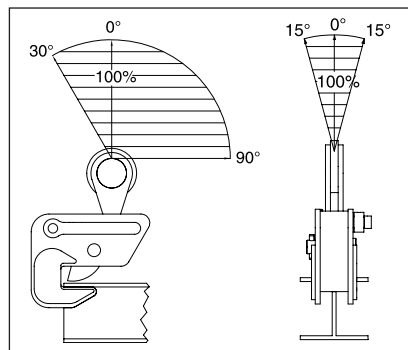

### Model IPBSNZ

Model	Working Load Limit (t)*	IPBSNZ Stock No.	Weight Each (lbs.)	Dimensions (in.)									
				Jaw A	B	C	D	E	F	G	H	J	K
IPBSNZ	1.5	2705925	30.9	0 - 1.25	3.94-10.63	11.97	18.90	2.76	12.56	1.85	.63	6.50	5.83
IPBSNZ	3	2705926	48.5	0 - 1.56	3.94-12.99	13.86	19.45	2.95	16.06	2.20	.79	8.15	7.17
IPBSNZ	4.5	2705927	67.2	0 - 2.00	3.94-14.17	16.54	24.80	2.95	17.99	2.20	.79	9.84	7.40

Design Factor based on EN 13155 and ASME B30.20

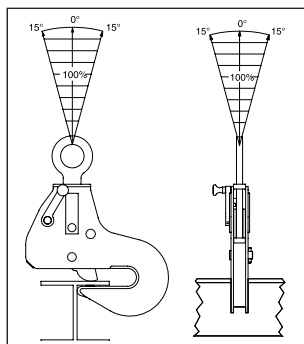

**Crosby**

## IPSTARTEC11

## For the Lifting and Transfer of Steel Beams

- Available in capacities of 1.5 and 2.5 metric tons.
- Jaw openings available: .25" to .75".
- Welded alloy steel body for strength and smaller size. Forged alloy components, where required.
- Individually Proof Tested to 2 times the Working Load Limit with certification.
- Company name (CrosbyIP), logo, Working Load Limit and jaw opening permanently stamped on body.
- Each product is individually serialized, with the serial number and Proof Load test date stamped on body. Serial number is included on the test certificate with maintenance and warranty logbook.
- Maintenance replacement parts are available.
- Manufactured by a ISO 9001 facility.
- All sizes are **RFID EQUIPPED**.



### Model IPSTARTEC11

Model	Working Load Limit (t)*	IPSTARTEC11 Stock No.	Weight Each (lbs.)	Dimensions (in.)									
				Jaw A	B	C	D	E	F	G	H	J	K
IPSTARTEC11	1.5	2701812	14.6	.25 - .50	5.51	1.54	22.64	4.33	3.19	5.08	2.13	4.96	.63
IPSTARTEC11	2.5	2701822	32.0	.25 - .75	8.27	2.17	28.54	5.31	4.53	7.17	2.91	5.51	.71

\* Design Factor based on EN 13155 and ASME B30.20.

The IPSTARTEC11 beam clamp has been specially developed for lifting with the body in vertical position, controlled tilting, transportation and stacking of steel "H" and "I" profiles. By placing the chain guide in the appropriate position, it is easy to switch from lifting to tilting and back again, which shifts the center of gravity.

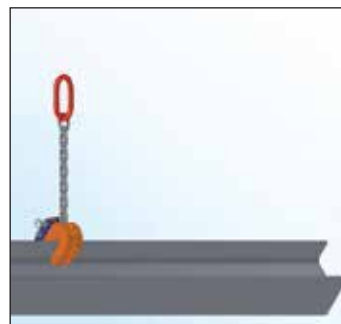
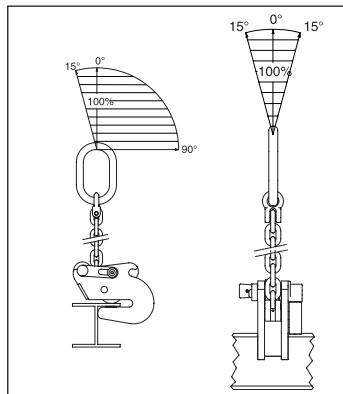
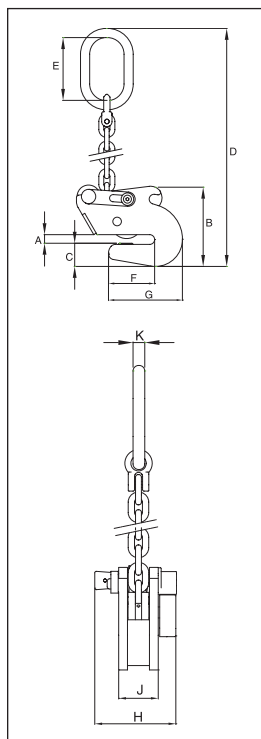

**Crosby®**



## Horizontal

**Horizontal Lift:** Clamps (used in pairs or multiples) are attached to the side edges of a plate or bundle of plates positioned horizontally to the floor level. The rigging attached to the clamps is generally multi-legged slings with the connecting point of the slings being approximately centered between the distance separating the clamps. Refer to illustrations below.

The *Model HR* is a horizontal lifting clamp intended to be used in pairs, sets of pairs, or in a tripod arrangement for transporting steel plates horizontally. Equipped with serrated gripping cams as standard equipment, both the HR and HDR models are available with smooth, bronze or stainless steel gripping cams to prevent marring when handling polished metals such as stainless steel, copper, aluminum, etc.



Rated Capacity (tons)	Jaw Opening (in.)	Weight (lbs.)
1/4	0-1	3-1/2
1/2	0-2	15
3/4	0-2	19
1-1/2	0-2	21
3	0-2	24
4	0-3	45

\*Other capacities and plate thicknesses available upon request.



The *Model M* is a multipurpose clamp used for positioning, sorting, erection and handling of prefabricated sections. The split lower jaw enables the clamp to be particularly useful in handling structural shapes. The Model M incorporates a "Lock Closed" feature which facilitates attaching the clamp to the member being lifted. These clamps must be used in pairs, sets of pairs, or in a tripod arrangement for transporting plate horizontally. Handle is available on 8 ton clamp only.



Rated Capacity (tons)	Plate Thickness	Weight (lbs.)
1/2	0 - 1	7
	3/4 - 1-1/2	8
1	0 - 1	11
	3/4 - 1-1/2	12
2	0 - 1-1/4	23
	1 - 2	24
4	0 - 2	35
	1-3/4 - 3-1/2	38
8	0 - 2	107
	1-3/4 - 3-1/2	110

\*Other capacities and plate thicknesses available upon request.



## Vertical + 90

**Vertical Lift:** The lifting of a single plate or member in which the lifting force exerted by the rigging is directly above and in line with the lifting shackle as shown in the illustration.



The *Model LJ* is a vertical lifting clamp capable of turning a plate from horizontal to vertical and back through the same 90° arc. It is small and easy to handle in capacities through three tons. The Model LJ incorporates a "Lock Closed" feature, which facilitates attaching the clamp to the plate.

Rated Capacity (tons)	Plate Thickness	Weight (lbs.)
1/2	0 - 3/4	9
1	0 - 3/4	15
2	0 - 1	26
3	0 - 1-1/4	34

\*Other capacities and plate thicknesses available upon request.



## Vertical + 180

Vertical Lift: The lifting of a single plate or member in which the lifting force exerted by the rigging is directly above and in line with the lifting shackle as shown in the illustration.

The *Model JA* is a vertical lifting clamp capable of turning a single plate or member from horizontal to vertical to horizontal through a 180° arc. Incorporates a push button auxiliary lock.



Rated Capacity (tons)	Plate Thickness	Weight (lbs.)
1/2	0 - 5/8 1/2 - 1	10
1	0 - 3/4 1/2 - 1	15
2	0 - 1 3/4 - 1-1/2	36
4	3/16 - 1-1/4 1 - 2	42
6	1/4 - 1-3/8 1 - 2-1/8	64

\*Other capacities and plate thicknesses available upon request.

The *Model SCSL* is a locking screw clamp capable of handling a steel plate from horizontal to vertical to horizontal through a 180° arc. It is a lightweight clamp primarily used for bench work. It is capable of handling up to a 2,000-lb load. The Model SCSL incorporates a spring loaded swivel jaw and screw cup. The spring loaded screw cup serves as an indicator when the locking screw has been properly tightened.



Rated Capacity (tons)	Jaw Opening (in.)	Weight (lbs.)
1	1/16 - 3/4	12



The *Model TLA* is a vertical lifting clamp incorporating a “Lock Open” and a “Lock Closed” feature and an auxiliary lock. The clamp is capable of turning a steel plate from horizontal to vertical to horizontal through a 180° arc. The “Lock Open,” “Lock Closed” feature facilitates attaching and removing the clamp from the plate.



Rated Capacity (tons)	Plate Thickness	Weight (lbs.)
1/2	0 - 5/8 1/2 - 1	9 10
1	0 - 3/4 1/2 - 1	14 15
2	0 - 1 3/4 - 1-1/2	32 33
4	3/16 - 1-1/4 1 - 2	35 37
6	1/4 - 1-3/8 1 - 2-1/8	48 51

\*Other capacities plate thicknesses available upon request.



## Vertical + 180° + Side Pull

The *SCPA clamp* is capable of handling steel plate from horizontal to vertical to horizontal through a 180° arc and may be used for handling plate at rolling and forming machines. These clamps feature a spring loaded pivoting cam jaw that "cams in" when a load is applied to the lifting shackle. Clamp is capable of handling plate horizontally when used in pairs or sets of pairs, or in a tripod arrangement. \*Pivoting shackle assembly, as shown, is available on capacities of 3 tons and larger.



Rated Capacity (tons)	Plate Thickness	Weight (lbs.)
1/2	0 - 3/4	8
1-1/2	0 - 1-1/4	14
3	0 - 2	19
6	0 - 2-1/2	44
10	0 - 3	93
15	0 - 4	210

\*Capacities through 200 tons and various plate thicknesses available upon request.

The *Model JPA* is a vertical lifting clamp capable of turning a single plate or member from horizontal to vertical to horizontal through a 180° arc. Incorporates a push button auxiliary lock. Permits side loading of lifting shackle to 90° by derating of clamp's rated capacity. Model JPA incorporates a pivoting shackle that permits side loading of the lifting shackle at 100% of rated capacity from vertical to 30°, 75% of rated capacity between 30° and 45° and 50% of rated capacity between 45° and 90°.



Rated Capacity (tons)	Plate Thickness	Weight (lbs.)
1/2	0 - 5/8 1/2 - 1	12
1	0 - 3/4 1/2 - 1	20
2	0 - 1 3/4 - 1-1/2	40
4	3/16 - 1-1/4 1 - 2	50
6	1/4 - 1-3/8 1 - 2-1/8	72

\*Other capacities plate thicknesses available upon request.

## Tagline Tool

The Tagline is a tool to which a load-guiding lanyard is attached to assist in controlling the swing of a load during transport and to aid in aligning the load before it is brought to rest.

Rated Capacity (tons)	Weight (lbs.)
0 - 1	4
1 - 2	5



## Total Lifting Clamps - NK - Automatic Clamps for Heavy Duty Applications



The NK has an automatic locking mechanism when the plate is correctly positioned at the back of the clamps throat.

- A clamp specifically for arduous working conditions
- Well adapted for heavy and abrasive loads
- Lever and clamping jaw protected from impact and wear
- Built with high strength materials
- The locking lever does not stick out so that the clamp may be used on the bare ground
- Permanently attached chain sling with a large oval suspension ring

Model	Weight (lbs.)	WLL Lbs.	Opening (in.)
NK1 0-20	8.8	3300	0 - 3/4
NK1 20-40	12.8	3300	7/8 - 1-1/2
NK1 40-60	13.2	3300	1-5/8 - 2-5/16
NK2 0-30	28.6	6600	0 - 1-1/8
NK2 30-60	33.0	6600	1-3/16 - 2-5/16
NK2 60-90	37.4	6600	2-3/8 - 3-1/2
NK3 0-40	55.0	9900	0 - 1-1/2
NK3 40-80	57.2	9900	1-5/8 - 3
NK3 80-120	59.4	9900	3-3/16 - 4-5/8
NK5 0-50	93.1	16500	0 - 2
NK5 50-100	110.0	16500	2 - 4
NK5 100-150	132.0	16500	4 - 6

## Total Lifting Clamps - NX/NXR - Automatic Non-Marring Clamp



The NX is designed for lifting and revolving without marring of smooth or polished pieces such as stainless steel plates, aluminum, pre-lacquered plates, wood, laminated sheets, marble, concrete, glass, plastic or any other fragile surface.

- A clamp for all situations, with no risk of damaging the load
- For any rigid load up to 3,300 lbs and 5-1/2" in thickness
- Permanently attached chain sling with a large oval suspension ring
- Non-marring polyurethane coated jaws
- Automatic clamping (manual clamping recommended for fragile materials)

Model	Weight (lbs.)	WLL Lbs.	Opening (in.)
NX05 0-20	9.9	1100	0 - 13/16
NXR05 0-100	13.2	1100	0 - 4
NXR05 20-120	12.8	1100	13/16 - 4-1/4
NXR05 40-140	13.2	1100	1-9/16 - 5-1/2
NX1.5 0-30	24	3300	0 - 1-1/8