

Load Rated



G-2170 / S-2170
GROMMET SHACKLE



- All sizes Quenched and Tempered for maximum strength.
- All sizes Cast alloy steel.
- Sizes 300 metric tons and smaller are proof tested to 2 times the Working Load Limit.
- 500 metric tons tested to 1.33 times the Working Load Limit.
- All ratings are in metric tons, embossed on side of bow.
- G-2170 bows are furnished Dimetcoated and pins are Dimetcoated, then painted red.
- S-2170 bows and pins are painted red.
- All sizes are RFID Equipped in bow and pin
- Designed for use with single or double large diameter grommets.
- Extra large sling contact area improves efficiency of the grommet sling.
- Utilizes new **Crosby Easy-Loc** shackle bolt system
- Large machined flat on ears that can be drilled and tapped for adapting other accessories.
- HR-1000 Hoist Ring in Bow standard for easy transporting
- Provides a bearing surface that is at least 5 times that of a round shackle.
- Increases usable sling strength minimum of 60% and greatly improves life of grommet slings.
- Bow and bolt are certified to meet charpy impact testing of 42 joules (31 ft-lbs.) min. ave. at -20 degree C (-4 degree F).
- All 2170 shackles are individually proof tested and magnetic particle inspected. Crosby certification available at time of order.
- Shackles requiring ABS, Lloyds, and other certifications are available upon special request and must be specified at time of order.
- All 2170 shackles can meet requirements of DNV Standard for Certification of Lifting Appliances upon special request and must be specified at time of order.
- Serialization / Identification
- Material Testing (Physical / Chemical / Charpy)
- Proof Testing
- Look for the Red Pin® ...the mark of genuine Crosby quality.

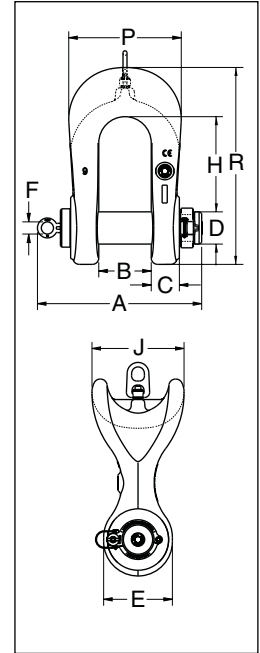

RIGGING
HARDWARE

G-2170 / S-2170 Crosby® Grommet Shackles

Working Load Limit (t)*	Stock No.		Weight Each (lbs.)	Dimensions (in.)										
	G-2170	S-2170		A	B +/- .02	C	D +/- .02	E	G	H	J	P	R	Effective Body Diameter
75	1022075	1022324	113	14.08	4.13	2.39	2.75	5.50	1.19	7.77	7.50	9.50	16.20	11.25
125	1022084	1022333	176	16.05	5.13	2.75	3.15	6.72	1.19	9.31	9.00	11.00	19.25	13.50
200	1022093	1022342	368	19.13	5.91	3.39	4.12	9.00	1.75	11.64	12.90	13.63	25.01	18.45
300	1022100	1022351	686	22.44	7.38	4.30	5.25	11.13	1.75	15.20	15.50	17.00	31.82	22.75
500	1022119	1022360	1668	30.38	9.84	6.00	7.09	13.75	1.75	19.72	20.00	23.00	41.44	30.00

* Sizes 75-300 metric tons are proof tested to 2 times the Working Load Limit. Ultimate Load is 5 times the Working Load Limit. 500 metric tons are proof tested to 1.33 times the Working Load Limit. Ultimate Load is 4.5 times the Working Load Limit. For Working Load Limit reduction due to side loading applications, see the Crosby General Catalog.