

### Swivel Eye Blocks

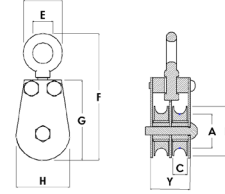
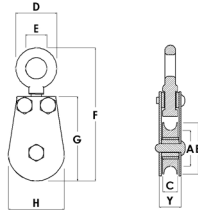

Swivel Eye Block - Single Sheave													
Model No.	Max Cable (inch)	Dimensions (inch)										Working Load (lbs)	Weight Each (lbs)
		A	B	C	D	E	F	G	H	Y			
01548	3/16	1	1 1/2	7/16	1 1/4	5/8	3 13/16	2 7/16	1 5/8	3/5	525	0.50	
02048	3/16	1 1/2	2	7/16	1 1/4	5/8	4 1/4	2 15/16	2 1/8	3/5	600	0.70	
02548	1/4	2	2 1/2	7/16	1 1/2	7/8	5	3 7/16	2 5/8	3/5	685	1.00	
02548-1/8	1/8	2 1/4	2 1/2	7/16	1 1/2	7/8	5	3 7/16	2 5/8	Spec	685	1.00	
03048	1/4	2 1/2	3	7/16	1 1/2	7/8	5 5/8	4 1/16	3 1/8	3/5	800	1.40	
03048-5/16	5/16	2 1/2	3	7/16	1 1/2	7/8	5 5/8	4 1/16	3 1/8	3/5	800	1.40	
03548	5/16	3	3 1/2	5/8	2 1/16	1 3/16	7 5/8	5 3/8	3 3/4	15/16	1550	3.10	
03548-3/8	3/8	3	3 1/2	5/8	2 1/16	1 3/16	7 5/8	5 3/8	3 3/4	15/16	1550	3.10	
04048	3/8	3 1/4	4	5/8	2 1/16	1 3/16	8 3/8	6	4 1/4	15/16	1700	3.60	
05048	3/8	4 1/4	5	5/8	2 1/16	1 3/16	9 3/8	7	5 1/4	15/16	1850	5.20	

Swivel Eye Block - Double Sheave													
Model No.	Max Cable (inch)	Dimensions (inch)										Working Load (lbs)	Weight Each (lbs)
		A	B	C	D	E	F	G	H	Y			
01548-2	3/16	1	1 1/2	7/16	1 1/4	5/8	3 13/16	2 7/16	1 5/8	1 7/32	525	0.65	
02048-2	3/16	1 1/2	2	7/16	1 1/4	5/8	4 1/4	2 15/16	2 1/8	1 7/32	600	1.05	
02548-2	1/4	2	2 1/2	7/16	1 1/2	7/8	5	3 7/16	2 5/8	1 7/32	685	1.55	
02548-2-1/8	1/8	2 1/4	2 1/2	7/16	1 1/2	7/8	5	3 7/16	2 5/8	1 7/32	685	1.55	
03048-2	1/4	2 1/2	3	7/16	1 1/2	7/8	5 5/8	4 1/16	3 1/8	1 7/32	800	2.15	
03048-2-5/16	5/16	2 1/2	3	7/16	1 1/2	7/8	5 5/8	4 1/16	3 1/8	1 7/32	800	2.15	
03548-2	5/16	3	3 1/2	5/8	2 1/16	1 3/16	7 5/8	5 3/8	3 3/4	1 13/16	1550	4.95	
03548-2-3/8	3/8	3	3 1/2	5/8	2 1/16	1 3/16	7 5/8	5 3/8	3 3/4	1 13/16	1550	4.95	
04048-2	3/8	3 1/4	4	5/8	2 1/16	1 3/16	8 3/8	6	4 1/4	1 13/16	1700	5.95	
05048-2	3/8	4 1/4	5	5/8	2 1/16	1 3/16	9 3/8	7	5 1/4	1 13/16	1850	8.95	

### Swivel Hook Blocks

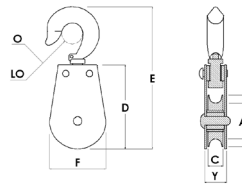

Swivel Hook Block - Single Sheave													
Model No.	Max Cable (inch)	Dimensions (inch)										Working Load (lbs)	Weight Each (lbs)
		A	B	C	D	E	F	LO	O	Y			
01578	3/16	1	1 1/2	7/16	2 7/16	4 1/8	1 5/8	5/16	7/16	3/5	525	0.50	
02078	3/16	1 1/2	2	7/16	2 15/16	4 5/8	2 1/8	5/16	7/16	3/5	600	0.70	
02578	1/4	2	2 1/2	7/16	3 7/16	5 3/4	2 5/8	1/2	5/8	3/5	685	1.00	
02578-1/8	1/8	2 1/4	2 1/2	7/16	3 7/16	5 3/4	2 5/8	1/2	5/8	3/5	685	1.00	
03078	1/4	2 1/2	3	7/16	4 1/16	6 1/4	3 1/8	1/2	5/8	3/5	800	1.40	
03078-5/16	5/16	2 1/2	3	7/16	4 1/16	6 1/4	3 1/8	1/2	5/8	3/5	800	1.40	
03578	5/16	3	3 1/2	5/8	5 3/8	8 1/2	3 3/4	13/16	15/16	15/16	1550	3.10	
03578-3/8	3/8	3	3 1/2	5/8	5 3/8	8 1/2	3 3/4	13/16	15/16	15/16	1550	3.10	
04078	3/8	3 1/4	4	5/8	6	9	4 1/4	13/16	15/16	15/16	1700	3.80	
05078	3/8	4 1/4	5	5/8	7	10	5 1/4	13/16	15/16	15/16	1850	5.30	

Swivel Hook Block - Double Sheave													
Model No.	Max Cable (inch)	Dimensions (inch)										Working Load (lbs)	Weight Each (lbs)
		A	B	C	D	E	F	LO	O	Y			
01578-2	3/16	1	1 1/2	7/16	2 7/16	4 1/8	1 5/8	5/16	7/16	1 7/32	525	0.70	
02078-2	3/16	1 1/2	2	7/16	2 15/16	4 5/8	2 1/8	5/16	7/16	1 7/32	600	1.05	
02578-2	1/4	2	2 1/2	7/16	3 7/16	5 3/4	2 5/8	1/2	5/8	1 7/32	685	1.65	
02578-2-1/8	1/8	2 1/4	2 1/2	7/16	3 7/16	5 3/4	2 5/8	1/2	5/8	1 7/32	685	1.65	
03078-2	1/4	2 1/2	3	7/16	4 1/16	6 1/4	3 1/8	1/2	5/8	1 7/32	800	2.25	
03078-2-5/16	5/16	2 1/2	3	7/16	4 1/16	6 1/4	3 1/8	1/2	5/8	1 7/32	800	2.25	
03578-2	5/16	3	3 1/2	5/8	5 3/8	8 1/2	7 5/8	13/16	15/16	1 13/16	1550	5.15	
03578-2-3/8	3/8	3	3 1/2	5/8	5 3/8	8 1/2	3 3/4	13/16	15/16	1 13/16	1550	5.15	
04078-2	3/8	3 1/4	4	5/8	6	9	4 1/4	13/16	15/16	1 13/16	1700	6.20	
05078-2	3/8	4 1/4	5	5/8	7	10	5 1/4	13/16	15/16	1 13/16	1850	9.20	

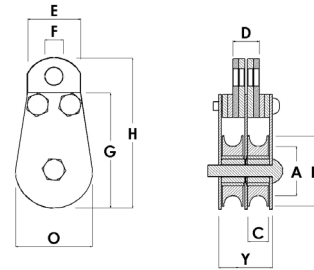
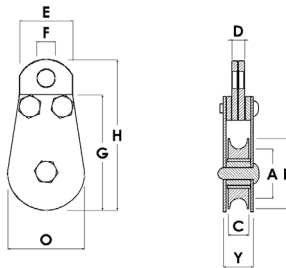

Fixed Eye Block - Single Sheave												
Model No.	Max Cable (inch)	Dimensions (inch)										Working Load (lbs)
		A	B	C	D	E	F	G	H	O	Y	
01568	3/16	1	1 1/2	7/16	1/4	1 1/8	3/8	2 7/16	3 1/4	1 5/8	3/5	525
02068	3/16	1 1/2	2	7/16	1/4	1 1/8	3/8	2 15/16	3 3/4	2 1/8	3/5	600
02568	1/4	2	2 1/2	7/16	1/4	1 1/8	3/8	3 7/16	4 1/4	2 5/8	3/5	685
02568-1/8	1/8	2 1/4	2 1/2	7/16	1/4	1 1/8	3/8	3 7/16	4 1/4	2 5/8	3/5	685
03068	1/4	2 1/2	3	7/16	1/4	1 1/8	3/8	4 1/16	4 13/16	3 1/8	3/5	800
03068-5/16	5/16	2 1/2	3	7/16	1/4	1 1/8	3/8	4 1/16	4 13/16	3 1/8	3/5	800
03568	5/16	3	3 1/2	5/8	5/16	1 1/2	9/16	5 3/8	6 1/2	3 3/4	15/16	1550
03568-3/8	3/8	3	3 1/2	5/8	5/16	1 1/2	9/16	5 3/8	6 1/2	3 3/4	15/16	1550
04068	3/8	3 1/4	4	5/8	5/16	1 1/2	9/16	6	7 1/4	4 1/4	15/16	1700
05068	3/8	4 1/4	5	5/8	5/16	1 1/2	9/16	7	8 1/4	5 1/4	15/16	1850

Fixed Eye Block - Double Sheave												
Model No.	Max Cable (inch)	Dimensions (inch)										Working Load (lbs)
		A	B	C	D	E	F	G	H	O	Y	
01568-2	3/16	1	1 1/2	7/16	1/4	1 1/8	3/8	2 7/16	3 1/4	1 5/8	1 7/32	525
02068-2	3/16	1 1/2	2	7/16	1/4	1 1/8	3/8	2 15/16	3 3/4	2 1/8	1 7/32	600
02568-2	1/4	2	2 1/2	7/16	1/4	1 1/8	3/8	3 7/16	4 1/4	2 5/8	1 7/32	685
02568-2-1/8	1/8	2 1/4	2 1/2	7/16	1/4	1 1/8	3/8	3 7/16	4 1/4	2 5/8	1 7/32	685
03068-2	1/4	2 1/2	3	7/16	1/4	1 1/8	3/8	4 1/16	4 13/16	3 1/8	1 7/32	800
03068-2-5/16	5/16	2 1/2	3	7/16	1/4	1 1/8	3/8	4 1/16	4 13/16	3 1/8	1 7/32	800
03568-2	5/16	3	3 1/2	5/8	5/16	1 1/2	9/16	5 3/8	6 1/2	3 3/4	1 13/16	1550
03568-2-3/8	3/8	3	3 1/2	5/8	5/16	1 1/2	9/16	5 3/8	6 1/2	3 3/4	1 13/16	1550
04068-2	3/8	3 1/4	4	5/8	5/16	1 1/2	9/16	6	7 1/4	4 1/4	1 13/16	1700
05068-2	3/8	4 1/4	5	5/8	5/16	1 1/2	9/16	7	8 1/4	5 1/4	1 13/16	1850