

**SPLIT
OVERHAUL BALLS**

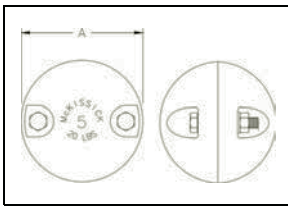

Split Overhaul Ball

- Attaches easily to Wire Rope.

Catalog No.	Stock No.	Wire Rope Size (in.)	Weight Each (lbs.)	Ball Diameter A (in.)
SHB - 15	2003822	1/4-5/16	15	5.06
SHB - 20	2003830	3/8	20	5.38
SHB - 50	2003831	1/2 - 5/8	50	7.12
SHB - 100	2003832	5/8 - 3/4 - 7/8	100	9.19



AS-15



Angular Contact Bearing Swivel Overhaul Balls

- Utilize genuine Crosby hooks which are forged alloy steel, Quenched and Tempered and contain the patented **QUIC-CHECK®** marking.
- Entire overhaul ball is zinc plated to resist corrosion.
- Designed with angular contact bearings which maximize efficiency, reliability and service life of swivel and extend the life of the wire rope.
- Available with wide jaw opening that utilizes nylon spools and shields.
- Designed for applications where headroom is critical.
- Other upper fittings available upon request.

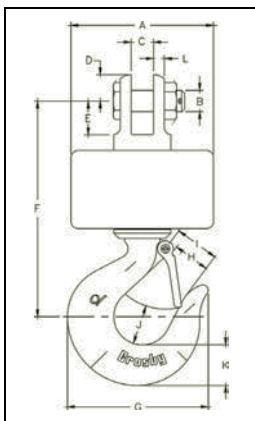

AS-15 Stock No.	Working Load Limit (Tons)*	Wire Rope Size (in.)	Dimensions (in.)												Weight Each (lbs.)
			A	B	C	D	E	F	G	H	I	J	K	L	
2009806	1.5	.38	4.00	.50	.50	.69	.78	6.28	4.09	1.12	1.22	1.19	1.12	.31	9
2009807	3.0	.50	5.00	.75	.75	.94	1.19	8.56	4.94	1.34	1.50	1.38	1.44	.38	19
2003969	5.0	.62	6.88	.88	1.06	1.12	1.56	10.81	6.50	1.69	1.88	1.75	1.81	.56	43
2009808	8.5	.75	7.00	1.19	1.56	1.34	2.09	13.75	8.69	2.25	2.50	2.56	2.59	.53	60

* Ultimate Load is 5 times the Working Load Limit.

