

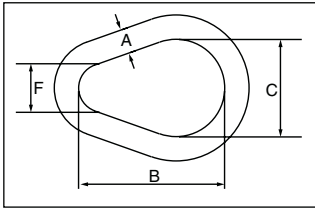

- Alloy Steel - Quenched and Tempered
- Individually Proof Tested at 2 times Working Load Limit with certification.
- Proof Test certification shipped with each link.
- Sizes 1/2", 5/8", 3/4", 7/8", 1", 1-1/4", and 1-3/8 are forged.

A-341



A-341 Alloy Pear Shaped Links

| Size (A) (in.) | A-341 Stock No | Working Load Limit | | Weight Per (lbs.) | Dimensions (in) | | |
|----------------|----------------|--------------------|------|-------------------|-----------------|-------|------|
| | | (lbs.)* | (t) | | B | C | F |
| 1/2 | 1013575 | 7000 | 3.15 | .55 | 3.00 | 2.00 | 1.00 |
| 5/8 | 1013584 | 9000 | 4.09 | 1.10 | 3.75 | 2.50 | 1.25 |
| 3/4 | 1013595 | 12300 | 5.59 | 1.76 | 4.50 | 3.00 | 1.50 |
| 7/8 | 1013604 | 15000 | 6.81 | 2.82 | 5.25 | 3.50 | 1.75 |
| 1 | 1013613 | 24360 | 11.0 | 4.22 | 6.00 | 4.00 | 2.00 |
| 1 1/8 | 1013622 | 30600 | 13.9 | 6.25 | 6.50 | 4.50 | 2.25 |
| 1 1/4 | 1013631 | 36000 | 16.4 | 8.25 | 7.75 | 5.00 | 2.50 |
| 1 3/8 | 1013640 | 43000 | 19.5 | 11.25 | 8.25 | 5.50 | 2.75 |
| †† 1 1/2 | 1013649 | 54300 | 24.7 | 14.25 | 9.00 | 6.00 | 3.00 |
| †† 1 5/8 | 1013658 | 62600 | 28.4 | 18.50 | 9.75 | 6.50 | 3.25 |
| †† 1 3/4 | 1013667 | 84900 | 38.6 | 22.50 | 10.50 | 7.00 | 3.50 |
| †† 1 7/8 | 1013676 | 95800 | 43.5 | 29.00 | 11.25 | 7.50 | 3.75 |
| †† 2 | 1013685 | 102600 | 46.6 | 34.00 | 12.00 | 8.00 | 4.00 |
| †† 2 1/4 | 1013694 | 143100 | 65.0 | 48.00 | 13.50 | 9.00 | 4.50 |
| †† 2 1/2 | 1013703 | 147300 | 66.9 | 66.00 | 15.00 | 10.00 | 5.00 |
| †† 2 3/4 | 1013712 | 216900 | 98.6 | 88.00 | 16.50 | 11.00 | 5.50 |
| †† 3 | 1013721 | 228000 | 103 | 114.00 | 18.00 | 12.00 | 6.00 |
| †† 3 1/4 | 1013730 | 262200 | 119 | 146.00 | 19.50 | 13.00 | 6.50 |
| †† 3 1/2 | 1013739 | 279000 | 126 | 181.00 | 21.00 | 14.00 | 7.00 |
| †† 4 | 1013748 | 373000 | 169 | 271.00 | 24.00 | 16.00 | 8.00 |

*Based on single leg sling (in-line load), or resultant load on multiple legs with an included angle less than or equal to 120°. Minimum Ultimate load is 5 times the Working Load Limit.
†† Welded Link.

G-341 / S-341



- Forged carbon steel - Quenched and Tempered.
- Self Colored or Hot Dip Galvanized.

G-341 / S-341 Weldless Sling Links

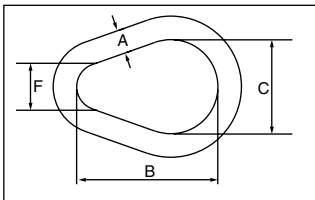

| Size (A) (in.) | Stock No. | | Working Load Limit Single Pull (lbs.)* | Weight Each (lbs.) | Dimensions (in.) | | |
|----------------|-------------|------------|--|--------------------|------------------|------|------|
| | G-341 Galv. | S-341 S.C. | | | B | C | F |
| 3/8 | 1013897 | 1013904 | 1800 | .23 | 2.25 | 1.50 | .75 |
| 1/2 | 1013913 | 1013922 | 2900 | .55 | 3.00 | 2.00 | 1.00 |
| 5/8 | 1013931 | 1013940 | 4200 | 1.06 | 3.75 | 2.50 | 1.25 |
| 3/4 | 1013959 | 1013968 | 6000 | 1.88 | 4.50 | 3.00 | 1.50 |
| 7/8 | 1013977 | 1013986 | 8300 | 2.75 | 5.25 | 3.50 | 1.75 |
| 1 | 1013995 | 1014002 | 10800 | 4.35 | 6.00 | 4.00 | 2.00 |
| 1 1/4 | 1014011 | 1014020 | 16750 | 7.60 | 7.75 | 5.00 | 2.50 |
| 1 3/8 | 1014039 | 1014048 | 20500 | 11.30 | 8.25 | 5.50 | 2.75 |

*Ultimate Load is 6 times the Working Load Limit. Based on single leg sling (in-line load), or resultant load on multiple legs with an included angle less than or equal to 120°.