

# 9320 SERIES IR CAMERA

## USER MANUAL

PLEASE READ THIS MANUAL BEFORE SWITCHING THE UNIT ON.  
IMPORTANT SAFETY INFORMATION INSIDE.

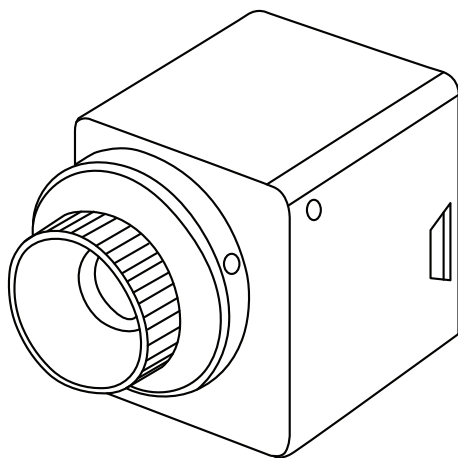

**THIS DEVICE IS INTENDED FOR ADJUNCTIVE USE WITH OTHER CLINICAL DIAGNOSTIC PROCEDURES TO MEASURE HUMAN BODY TEMPERATURE VIA NON-CONTACT SKIN MEASUREMENTS VISUALIZED FROM THE HUMAN FACE. NOT MEANT FOR STANDALONE CLINICAL DIAGNOSTIC PROCEDURES OR TO TREAT OR DIAGNOSE PATIENTS.**

ICI cameras fall under US Federal Law and Export Control.

©Copyright 2021, Infrared Cameras, Inc. - All rights reserved. The contents of this document may not be reproduced in whole or in parts without the written consent of the copyright owner.

Printed in the United States of America.

2105 W. Cardinal Dr.  
Beaumont, TX 77705  
(866) 861-0788  
[www.infraredcameras.com](http://www.infraredcameras.com)

Revision: 4.2021-001

THE MANUFACTURER RESERVES THE RIGHT TO ALTER THE SPECIFICATIONS OF THE PRODUCT WITHOUT PRIOR NOTIFICATION. THE MANUFACTURER ALLOWS HIMSELF THE RIGHT TO MODIFY WITHOUT ANY PRELIMINARY OPINION THE TECHNICAL SPECIFICATIONS OF THE PRODUCT. THIS MANUAL MAY CONTAIN TECHNICAL INACCURACIES OR TYPOGRAPHICAL ERRORS.

NOTICE ALL STATEMENTS, INFORMATION, AND RECOMMENDATIONS IN THIS MANUAL ARE BELIEVED TO BE ACCURATE BUT ARE PRESENTED WITHOUT WARRANTY OF ANY KIND. NOTWITHSTANDING ANY OTHER WARRANTY HEREIN, ALL DOCUMENT FILES AND SOFTWARE ARE PROVIDED "AS IS" WITH ALL FAULTS. ICI DISCLAIMS ALL WARRANTIES, EXPRESSED OR IMPLIED, INCLUDING, WITHOUT LIMITATION, THOSE OF MERCHANTABILITY, FITNESS FOR A PARTICULAR PURPOSE AND NONINFRINGEMENT OR ARISING FROM A COURSE OF DEALING, USAGE, OR TRADE PRACTICE.

THE SOFTWARE LICENSE AND LIMITED WARRANTY FOR THE ACCOMPANYING PRODUCT ARE SET FORTH IN THE INFORMATION PACKET THAT SHIPPED WITH THE PRODUCT AND ARE INCORPORATED HEREIN BY THIS REFERENCE. IF YOU ARE UNABLE TO LOCATE THE SOFTWARE LICENSE OR LIMITED WARRANTY, CONTACT YOUR ICI REPRESENTATIVE FOR A COPY.

IN NO EVENT SHALL ICI BE LIABLE FOR ANY INDIRECT, SPECIAL, CONSEQUENTIAL, OR INCIDENTAL DAMAGES, INCLUDING, WITHOUT LIMITATION, LOST PROFITS OR LOSS OR DAMAGE TO DATA ARISING OUT OF THE USE OR INABILITY TO USE THIS MANUAL, EVEN IF ICI HAS BEEN ADVISED OF THE POSSIBILITY OF SUCH DAMAGES.

## Contents

---

1.	General Description _____	4
2.	Safety Information _____	4
3.	Intended Use _____	4
4.	Technical Specifications_____	5
5.	Structure _____	6
6.	Package Contents _____	7
7.	Installation Instructions _____	8
8.	Computer Setup _____	16
9.	Cleaning and Maintenance _____	17
10.	Site and System Validation Checklist _____	18
11.	Troubleshooting _____	20
12.	About ICI _____	22

## 1. General Description

---

9320 Series IR Cameras are a winning combination of pixel resolution and accuracy. The unbeatable design is capable of meeting non-contact thermography needs. It is used in for temperature screening applications.

## 2. Safety Information

---

- This device must be installed by qualified service personnel or system installation personnel.
- Do take precautions to prevent the lens from being worn, scratched or broken. Avoid touching the lens to prevent it from being damaged or getting dirty.
- Given that the uncooled thermal infrared image camera uses a very sensitive thermal sensor, under no circumstances (powered on or off) should the lens be pointed directly at a strong radiation source (such as sun, direct or reflected laser beam, etc.), otherwise permanent damage will be caused to the uncooled thermal imager.
- This product is a precise electronic device that must be handled with care during use, storage, and transportation to prevent dangerous actions such as the device being hit by external force, or falling from heights.
- During transportation and storage the original packaging box must be used.
- Prior to start of the device, make sure that the power supply is properly connected. If the power supply is connected incorrectly, the device may be damaged.
- Do not place any objects on the power cord, and do not place the device where the power cord can be easily touched.
- Do not submerge the device in water. Protect the device from heavy seas and projecting jets of water. Rated for environments of 5% to 95% non-condensing humidity.
- Do not drop or throw the device.
- Do not put the product into a fire.
- It is recommended to calibrate the device(s) annually.
- If the device operates abnormally, please contact the supplier and do not dismantle the device on your own.

## 3. Intended Use

---

9320 Series IR Cameras are used as an adjunct to other clinical diagnostic procedures for elevated body temperature screening based on the skin surface temperature visualized from the human face.

Patient population: All age groups

Environment of use: hospitals, sub-acute healthcare settings, public areas, i.e., airports.

## 4. Technical Specifications

	9320 P	9320 S
Detector Array	UFPA (VOx)	
Pixel Pitch	17 $\mu$ m	
FOV	Lens dependent	
Measurement Distance	Lens dependent	
Pixel Resolution	320 x 240	
Spectral Band	7 $\mu$ m to 14 $\mu$ m	
Thermal Sensitivity (NETD)	< (20 mK) 0.02 °C at 30 °C (86 °F)	
Frame Rate	60 Hz	9 Hz
Dynamic Range	14-bit	
Temperature Range	25 °C to 45 °C (77°F to 113 °F)	
Operation Range	0 °C to 50 °C (32 °F to 122 °F)	
Storage Range	-40 °C to 80°C (-40 °F to 176 °F)	
Humidity	5% to 95% non-condensing	
Accuracy	$\pm$ 0.2 °C (0.36 °F)	
Pixel Operability	> 99 %	
Shock/Vibration	70 G/4.3 G	
Dimensions (without lens)	37 mm x 37 mm x 41.5 mm (L x W x D $\pm$ 0.5 mm) (1.46" x 1.46" x 1.63" (L x W x H $\pm$ 0.02"))	
Power	5 V DC 500 mA, < 1.1 W	
Weight (without lens)	< 47 g (1.66 oz)	
Interface	USB Mini-B	
Video	Raw	
Emissivity Correction	0.01 to 1.0	
IP Rating	IP 54	
Shutter	Built-in shutter	

## 5. Structure

---

### 5-1 Appearance and Definitions of Housing Interface

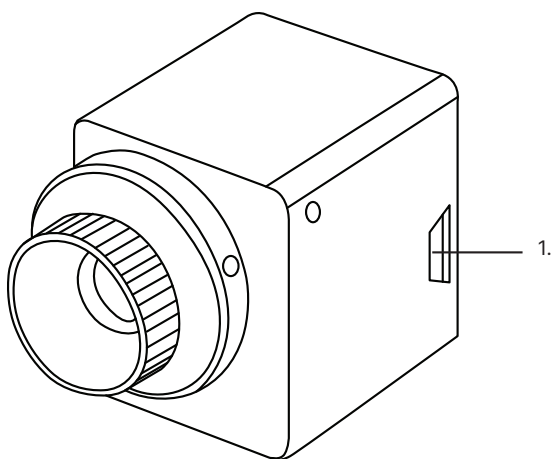

1. Mini-USB interface

## 6. Package Contents

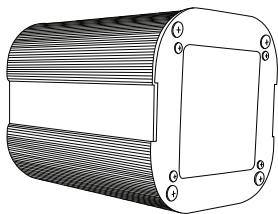

Temperature Reference

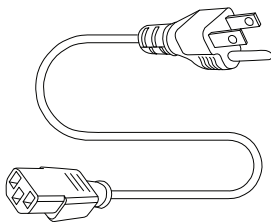

AC Power Cord

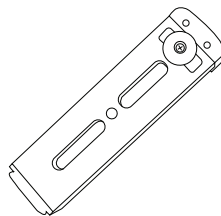

Mounting Bracket

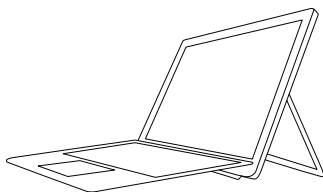

Laptop

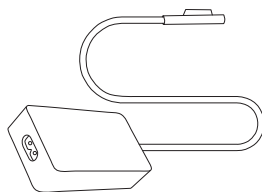

Laptop AC Power Adapter

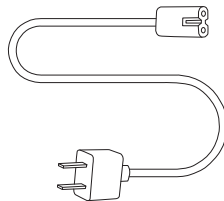

Laptop AC Power Cord

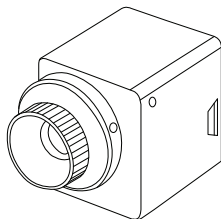

9320 Series IR Camera

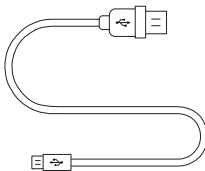

Mini-USB to USB Cable



Software USB Drive

**ENSURE ALL SYSTEM EQUIPMENT AND COMPONENT ITEMS ARE PRESENT BEFORE BEGINNING INSTALLATION**

## 7. Installation Instructions

---

### 7-1 Tripod Setup

**SELECT AN APPROPRIATE AREA FREE OF IMMEDIATE AIRFLOW FROM DOORWAYS AND AIR CONDITIONING/VENTILATION SYSTEMS. THE SELECTED AREA SHOULD HAVE A STABLE AMBIENT TEMPERATURE BETWEEN 20 °C AND 24 °C (68 °F TO 75.2 °F) AND RELATIVE HUMIDITY RANGE FROM 10% TO 50%.**

**A.**

Loosen mounting bracket by turning dial to the left.

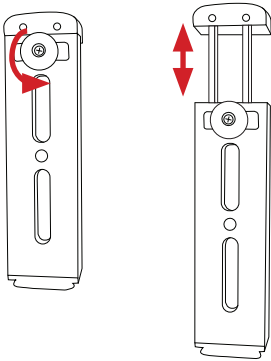

**B.**

Place mounting bracket securely on back of laptop computer.\*

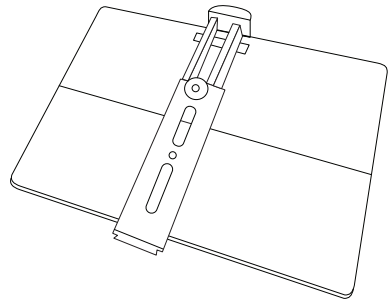

**\* YOU CAN LEAVE THE TYPE COVER ATTACHED, OR REMOVE IT. EITHER OPTION FITS WITH THE MOUNTING BRACKET.**



**C.**

Tighten mounting bracket by turning the dial to the right.

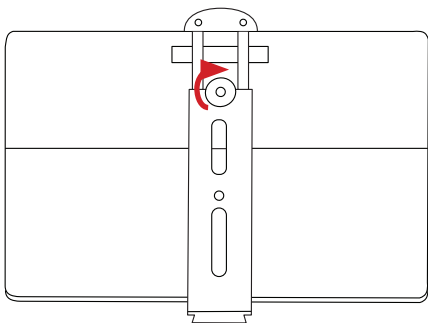
**D.**

Mount the mounting bracket to a tripod using the 1/4-20 mount.

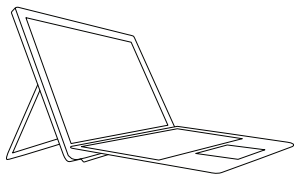
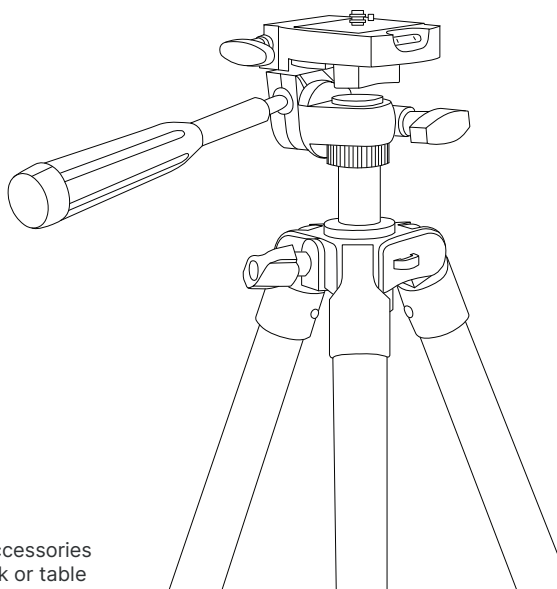
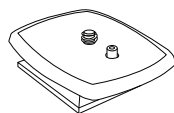
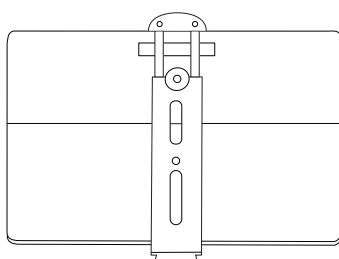

If you did not purchase tripod accessories  
place the laptop on a stable desk or table

**E.**

Plug laptop power cord into  
laptop power adapter.

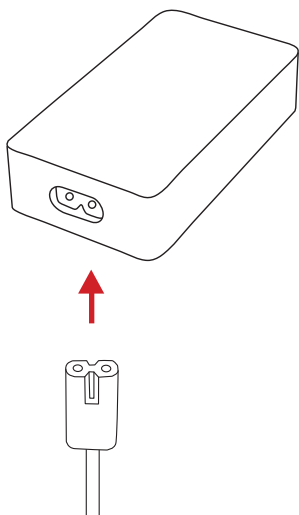

**F.**

Plug laptop power adapter  
into laptop computer.

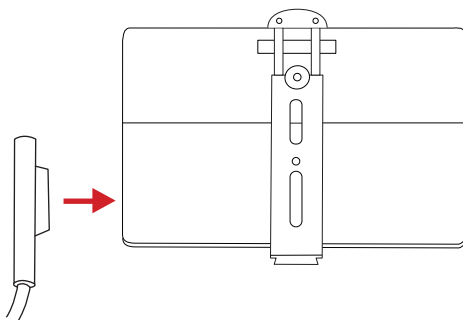

**G.**

Plug power cord into a  
110/120V electrical outlet.

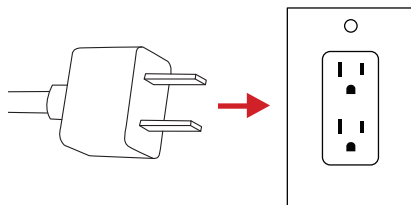

H.

Mount the Temperature Reference to a tripod using the 1/4-20 mount.

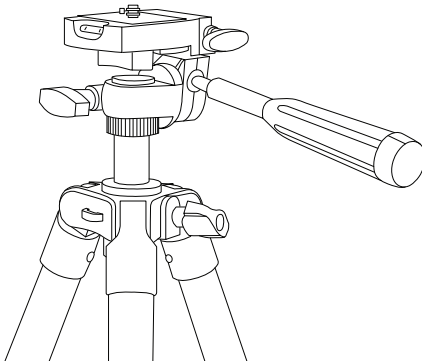
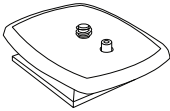
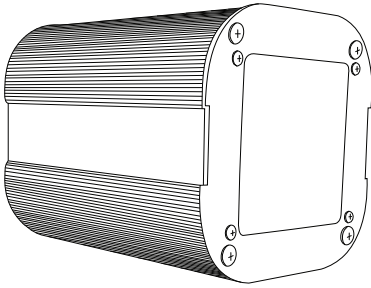

I.

Plug power cord into Temperature Reference.

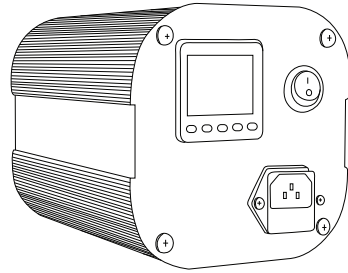

**MAKE SURE TRIPODS DO NOT BLOCK THE DIRECT PATH OF PERSON(S) TO BE IMAGED TO ENSURE THE EQUIPMENT WILL NOT BE MOVED OR KNOCKED DOWN. USING A DIVIDING BARRIER WILL HELP KEEP TRIPODS SEPARATE FROM THE PATH.**

**J.**

Plug power cord into a 110/120V electrical outlet.

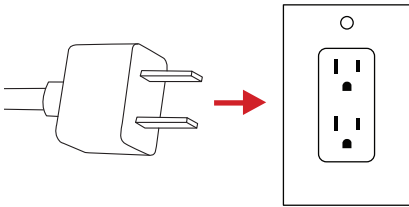
**K.**

Mount the 9320 Series IR Camera to a tripod mount using the 1/4-20 mount.

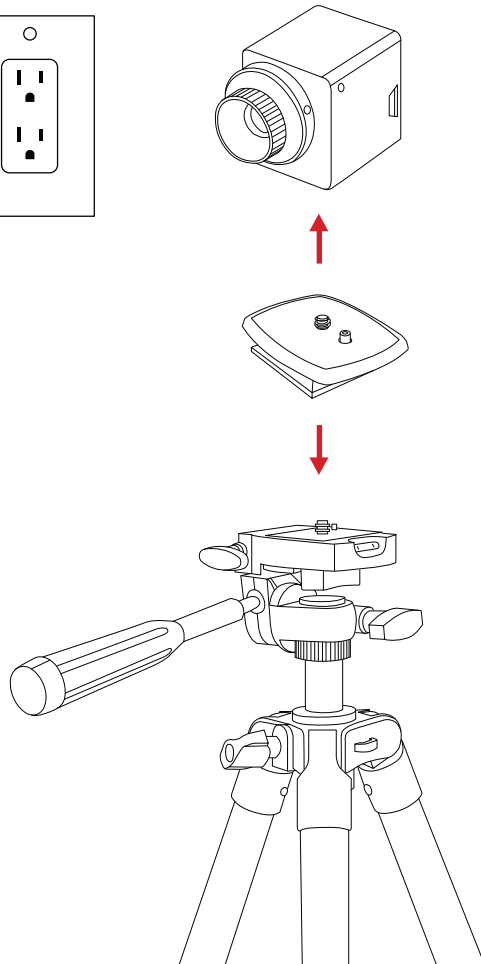

**ENSURE THE CAMERA LENS AND TEMPERATURE REFERENCE SOURCE ARE FACING EACH OTHER ON PARALLEL PLANES. MAKE SURE CAMERA TARGET AREA IS FACING A NON-REFLECTIVE BACKGROUND.**

L.

Plug the Mini-USB end of the USB cable into the back of the 9320 Series IR Camera.

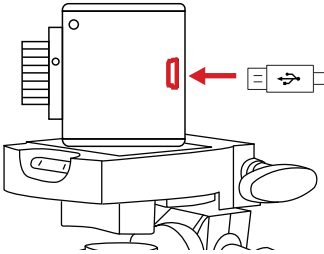

M.

Plug the other end of the USB cable into the laptop computer.

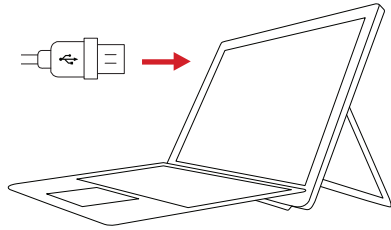

N.

Power on devices.

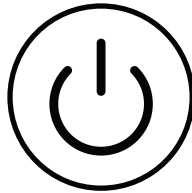

**ALLOW AT LEAST 45 MINUTES FOR THE TEMPERATURE REFERENCE SOURCE TO WARM UP. THIS WILL PROVIDE THE MOST ACCURATE SKIN TEMPERATURE MEASUREMENTS.**

**SOFTWARE ARRIVES INSTALLED ON COMPUTERS AND TABLETS PURCHASED FROM ICI AS COMPLETE SYSTEMS AND IT WILL LAUNCH AUTOMATICALLY ON STARTUP. AFTER THE SOFTWARE LAUNCHES THE USER SHOULD ENSURE THE TARGET ZONE IS IN VIEW OF THE CAMERA AND THE TEMPERATURE REFERENCE SOURCE IS POSITIONED OFF CENTER TO KEEP THE PERSON BEING IMAGED AS CENTERED AS POSSIBLE.**

## 7-2 Charging Instructions

A.

Plug the power cord into the power adapter.

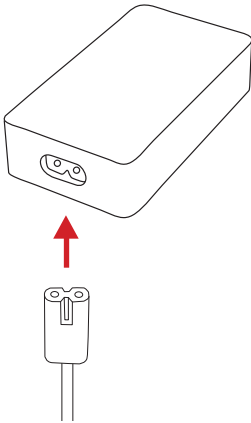

B.

Plug power adapter into laptop

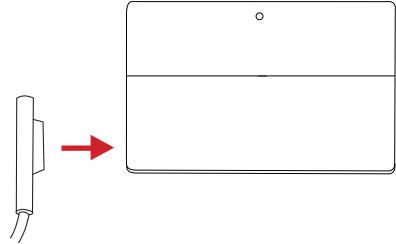

C.

Plug power cord into a 110/120V electrical outlet.

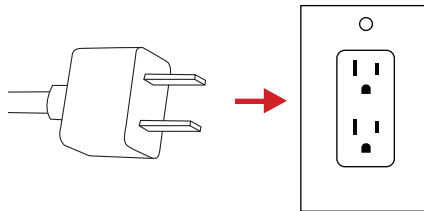

THE DEVICE TAKES BETWEEN TWO AND THREE HOURS TO CHARGE COMPLETELY. IT MAY CHARGE IN LESS TIME, DEPENDING ON HOW LOW ITS BATTERY HAS DRAINED. YOU CAN USE YOUR SYSTEM WHILE IT'S CHARGING, BUT THE CHARGING TIME WILL TAKE LONGER.

## 7-4 Full Assembly Diagram

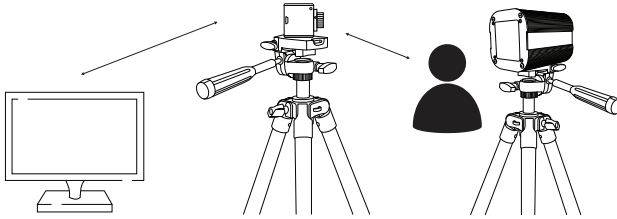

GRAPHIC FOR ILLUSTRATION PURPOSES ONLY

## CRITICAL INFORMATION

- The technology should be used to measure only one subject's temperature at a time.
- Measurements should not be solely, or primarily, relied upon to diagnose or exclude a diagnosis of any disease.
- Elevated body temperature should be confirmed with secondary evaluation methods (e.g., an NCIT or clinical grade contact thermometer).
- Signage should instruct for the removal of glasses, headwear, and masks.
- Read the current government guidance regarding the use of telethermographic systems for skin temperature measurements. Additional information can be found by reading IEC 80601-2-59:2017 Medical electrical equipment — Part 2-59: Particular requirements for the basic safety and essential performance of screening thermographs for human febrile temperature screening and ISO/TR 13154:2017 Medical electrical equipment - Deployment, implementation and operational guidelines for identifying febrile humans using a screening thermograph.

## CRITICAL INFORMATION

## 8. Computer Setup

---

### 8-1 IR Flash Skin Temperature Monitor Software (IR Flash STM)

Software arrives installed on computers and tablets purchased from ICI as complete systems and it will launch automatically on startup. A copy of the software is provided on the Software USB Drive. Documentation can be found online on the IR Flash STM web page under the Downloads section or at this address:

<https://infraredcameras.com/ir-flash-stm-manual/>

- **Processor:** i5 or above (Quad Core or better)
- **RAM:** 4 GB or above
- **OS:** Windows 8/8.1/10
- **Hard Drive:** 256 GB or above
- **Resolution:** 1920 x 1080

### 8-2 Cybersecurity

The computer supplied with a complete system is provided with the Windows Operating System. IR Flash STM software preinstalled and the system has been checked for viruses and malware prior to shipping. To further decrease the possibility of introducing malware, Infrared Cameras Inc. recommends you take steps to reduce the likelihood that the system be compromised, which include:

- Prior to connecting the system's computer to the Internet or your secure internal network be sure to have your IT department install your organization's anti-virus software, anti-malware and, if applicable, system access software and apply security updates as necessary.
- If connecting the system's computer to the Internet be sure to locate the computer behind a firewall.
- Install security updates to the computer's operating system in accordance with your organization's policies
- Do not use the system's computer for other uses.
- Install software updates via instructions provided by Infrared Cameras Inc. only. Do not install software from unknown entities.
- Don't connect unknown hardware devices, e.g. USB devices, external hard drives, etc. to the system computer.
- If you suspect that the system computer has been infected with malware, contact your organization's IT department or Infrared Cameras Inc. for further assistance.

If your device does not require usage of the e-mail alert function using the device off a network is preferred.

Windows 10™ Operating System updates are evaluated by Infrared Cameras Inc. as they are released by Microsoft. Please contact Infrared Cameras Inc. Technical Support for compatibility information.



## 9. Cleaning and Maintenance

---

### 9-1 Cleaning the Germanium Lens

Do not use corrosive chemicals on the optical glass components. The germanium window surface is coated with anti-reflection coating. Dust, grease, and fingerprints will produce harmful substances and lead to a decline in performance, or cause scratches. If dirt is found, please use the following methods:

1. Use a blown balloon or a soft brush to clean the lens surface to avoid dust particles scratching the anti-reflection film on lens surface during the wiping process.
2. Use a soft cotton or microfiber cloth or lens wiping paper and dip in distilled water. Gently wipe the lens surface from the middle to the edge, paying attention to not crack the lens, or use too much liquid. If the lens is still not clean, replace the cloth and repeat the wiping process.

### 9-2 Disinfecting the Camera Surface

Do not use corrosive cleaning solutions on the optical glass components. It is recommended to disinfect the camera surface regularly with a non-corrosive sanitizing product. Follow the directions provided by the manufacturer of the cleaning solution. Adhere to the sanitation protocols and cleaning schedule set forth by the employer.

### 9-3 Device Calibration

It is recommended to have device(s) re-calibrated annually. Contact customer service to schedule maintenance.

### 9-4 Storage

When the equipment is not in use, the Temperature Reference Source should be placed in a dust-free and moisture-free environment with a stable temperature and humidity.

## 10. Site and System Setup Validation Checklist

**Site:** \_\_\_\_\_

**System:** \_\_\_\_\_

**Contact Person:** \_\_\_\_\_

**Date:** \_\_\_\_\_

**\*\*All those tasked with the initial setup of the temperature screening equipment must be present during this training.**

**\*\*\*This portion of the validation requires a live video feed with the instructors.**

### 10-1 The Screening Area

- ☐ Ensure that this area is free from:
  - Any direct or indirect (reflected) sunlight
  - Warm or cold conductive airflow
    - HVAC vents/intakes
  - Any radiant energy from electrical sources
  - Direct or indirect lighting on individual being screened
- ☐ Room temperature is 20 °C - 24 °C (68 °F - 75 °F)
- ☐ Relative humidity is within 10% – 50%

### 10-2 The Screening Background

- ☐ Placement is parallel and perpendicular to screening camera
  - At a distance of ~12 ft.
- ☐ Consists of a non-IR reflective homogeneous background
  - Minimum size is 10' x 8'
  - White to gray flat finish

### 10-3 The Traffic Flow

- ☐ Establish a guided pathway from the entrance to the screening area
  - ☐ Design this pathway so there is an equilibration time
  - ☐ No restrooms on ingress pathway
  - ☐ Signage should instruct for removal of glasses, headwear, and masks
- ☐ Mark the point of measurement on the floor ("V/X" or a set of footprints)
  - ☐ The distance is unique to each screening system
- ☐ Ensure the line of sight from the person being screened to the camera is never blocked by another individual entering or leaving the point of measurement
- ☐ The secondary screening area should be setup near the screening area

Continues

#### 10-4 Typical traffic flow illustration:

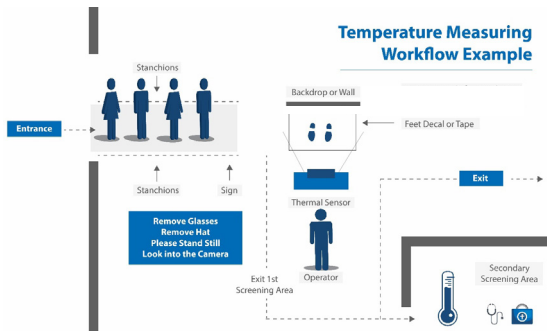

#### 10-5 IR Camera Placement

- ☐ Perpendicular to floor and individual being screened
- ☐ Height of camera
  - ☐ Average male  $70 \pm 4$  inches; Average female  $65 \pm 4$  inches
  - ☐ 5'4" – 5'8" will image 4'8" to 6'4" individual.
- ☐ Distance of camera to individual being screened is 8 - 10 ft.
  - ☐ The individual's face should be in the frame
- ☐ Protect the camera from exposure to direct sunlight to avoid damaging camera sensor

#### 10-6 Software

- ☐ Set up the software according to the instructions
- ☐ Documentation can be found online on the IR Flash STM web page under the Downloads section or at this address:

<https://infraredcameras.com/ir-flash-stm-manual/>

#### 10-7 Final Step

Final validation is dependent upon a signed copy of this checklist from each person responsible for each site.

Upon completion please sign below:

**ICI representative:**

**Company representative:**

Signature: \_\_\_\_\_ Signature: \_\_\_\_\_

Print Name: \_\_\_\_\_ Print Name: \_\_\_\_\_

Date: \_\_\_\_\_

## 11. Troubleshooting

If the user encounters any problems while using the imager, refer to the following known issues. If the problem persists, disconnect the power and contact customer support.

### 11-1 Camera(s) not showing, camera(s) lagging, or software crashing

- Ensure that camera has been powered on for a few minutes
- Verify that firewall is not blocking software
- Close and reopen software
- Verify that correct software is installed
- Uninstall & reinstall software, running as administrator
- Try IR Flash STM software. If already using, try a newer version.
- Restart computer

### 11-2 Temperature readings are incorrect or facial recognition is suboptimal

- Close and reopen software
- Check that software settings are correct:
  - Fixed temperature of 35 °C or 37 °C (95 °F or 98.6 °F), depending on temperature reference source
  - Temperature reference source has crosshair over it
- Remove masks & glasses
- Camera is proper distance from person
- Camera is at proper height
- Temperature reference source in view, perpendicular to camera, but not blocked
- Person is looking directly at camera lens, not at an angle
- Reconnect the camera to the computer and restart the computer
- Reconnect the power to the temperature reference source
- Temperature reference source power switch is on
- Camera and temperature reference source powered on for several minutes
- Ensure temperatures on back of temperature reference source match
- Camera is away from direct sunlight or reflective light
- Plain background
- Try IR Flash STM software. If already using, try a newer version.

### **11-3 No thermal image**

- Take off the lens cover
- Ensure device is receiving power

### **11-4 Thermal imager shuts down or device will not start**

- Charge the device
- Ensure device is within the safe operating temperature range

## 12. About ICI

---

Infrared Cameras, Inc.  
2105 W. Cardinal Dr.  
Beaumont, TX 77705

Phone: (409) 861-0788 | Toll Free: (866) 861-0788 | International: (409) 861-0788

General Inquiry: [support@infraredcameras.com](mailto:support@infraredcameras.com)  
Website: [www.infraredcameras.com](http://www.infraredcameras.com)

You may reach a representative by phone or email Monday – Friday 8:00AM - 5:00PM CST.

ICI manufactures complete systems and software. We can provide complete engineering, software, and OEM solutions. Our Fortune 500 clients rely on us for infrared equipment and thermography training (which we offer through the Infrared Training Institute).

In addition to providing custom germanium, silica, and sapphire optics, we also build windows for enclosures, as well as custom pan and tilt units. We can even provide customizable explosion-proof systems.

Our knowledge and experience stems from years of using infrared imaging and temperature measurement instruments to provide solutions to: managers, engineers, scientists, inspectors and operators in space, power companies, medical, pulp and paper, food industry, research and development, and various process industries. You can see our products and services used in industrial, commercial, and government applications worldwide. Originally named Texas Infrared (still DBA), Infrared Cameras, Inc. has been in business since March, 1995.

Thank you for your dedicated and continued support.