

NAME: \_\_\_\_\_

PHONE: \_\_\_\_\_

SCHOOL/ORGANIZATION: \_\_\_\_\_

E-MAIL: \_\_\_\_\_

DEALER/REP: \_\_\_\_\_

SALES REP: \_\_\_\_\_ QUOTE: \_\_\_\_\_



Clean, modern, and easy to maneuver from sit to stand, the HT100 height-adjustable hand therapy table delivers an effortless transition at the touch of a button. Powerful dual motors lift quickly and quietly from 23-49.125" H in seconds, while three programmable memory presets save time and energy. Choose from multiple top configurations to suit your size and style and experience a therapy solution designed for greater comfort.

**STANDARD FEATURES:**

- Load Capacity: 264 lbs.
- Sit or stand
- Electrical elevation: 23-49.125" H
- Charcoal finish on base
- A wide base provides improved accessibility for all clients
- Anti-collision safety feature
- Hand control with:
  - Constant smooth movement and soft start/stop
  - (3) Programmable memory locations
  - (2) USB ports
- Pre-assembled frame kits significantly reduces installation time
- (4) Leveling feet
- Designed for therapy and rehabilitation

*HT100*  
**HAND THERAPY TABLE**



HT100-4830

**TABLE CONFIGURATIONS:**

- |  |  |  |
|--|--|--|
| <input type="checkbox"/> <b>HT100-4824</b><br>48"W x 24"D x 23-49.125"H<br>Qty _____ | <input type="checkbox"/> <b>HT100-6024</b><br>60"W x 24"D x 23-49.125"H<br>Qty _____ | <input type="checkbox"/> <b>HT100-7224</b><br>72"W x 24"D x 23-49.125"H<br>Qty _____ |
| <input type="checkbox"/> <b>HT100-4830</b><br>48"W x 30"D x 23-49.125"H<br>Qty _____ | <input type="checkbox"/> <b>HT100-6030</b><br>60"W x 30"D x 23-49.125"H<br>Qty _____ | <input type="checkbox"/> <b>HT100-7230</b><br>72"W x 30"D x 23-49.125"H<br>Qty _____ |

**TOP CONFIGURATIONS:**



Cutout

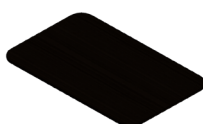

Rectangular



Dual Cutout

**OPTIONS:**

- RE410** - Battery
- RE470** - (4) Locking Casters (Adds 2.25" to height)

**TOP COLORS:**

-         
- Brushed Concrete      Weathered Grey      Mineral Grey      Briarsmoke      White Wood Grain
-     
- Cocoa Bean      Nightshade      Sandlewood

*\*Other top materials available upon request.*