

NAME: \_\_\_\_\_

PHONE: \_\_\_\_\_

SCHOOL/ORGANIZATION: \_\_\_\_\_

E-MAIL: \_\_\_\_\_

DEALER/REP: \_\_\_\_\_

SALES REP: \_\_\_\_\_ QUOTE: \_\_\_\_\_



WWW.PHSMEDICALSOLUTIONS.COM  
800-743-7738 • FAX: 605-882-8398

# HT100 HAND THERAPY TABLE

## STANDARD FEATURES:

- Load Capacity: 264 lbs.
- Sit or stand
- Electrical elevation: 23-49.125"H
- Charcoal finish on base
- A wide base provides improved accessibility for all clients
- Anti-collision safety feature
- Hand control with:
  - Constant smooth movement and soft start/stop
  - (3) Programmable memory locations
  - (2) USB ports
- Pre-assembled frame kits significantly reduces installation time
- (4) Leveling feet
- Designed for therapy and rehabilitation



Clean, modern, and easy to maneuver from sit to stand, the HT100 height-adjustable hand therapy table delivers an effortless transition at the touch of a button. Powerful dual motors lift quickly and quietly from 23-49.125"H in seconds, while three programmable memory presets save time and energy. Choose from multiple top configurations to suit your size and style and experience a therapy solution designed for greater comfort.

## TABLE CONFIGURATIONS:

☐ **HT100-4824**

48"W x 24"D x 23-49.125"H

Qty \_\_\_\_\_

☐ **HT100-6024**

60"W x 24"D x 23-49.125"H

Qty \_\_\_\_\_

☐ **HT100-7224**

72"W x 24"D x 23-49.125"H

Qty \_\_\_\_\_

☐ **HT100-4830**

48"W x 30"D x 23-49.125"H

Qty \_\_\_\_\_

☐ **HT100-6030**

60"W x 30"D x 23-49.125"H

Qty \_\_\_\_\_

☐ **HT100-7230**

72"W x 30"D x 23-49.125"H

Qty \_\_\_\_\_

## TOP CONFIGURATIONS:



☐ Cutout

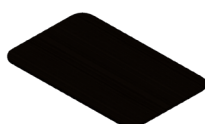

☐ Rectangular



☐ Dual Cutout

# HT100 HAND THERAPY TABLE

## OPTIONS:

- ☐ **RE410** - Battery
  - ☐ **RE470** - (4) Locking Casters (Adds 2.25" to height)
- .....

## TOP COLORS:



Brushed  
Concrete



Weathered  
Grey



Mineral  
Grey



Briarsmoke



White Wood  
Grain



Cocoa Bean

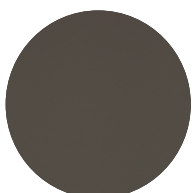

Nightshade



Sandlewood

*\*Other top materials available upon request.*